

LTR	EN	DESCRIPTION	APPR	BY	DATE
A	-	INITIAL RELEASE	MT	DC	12-28-07

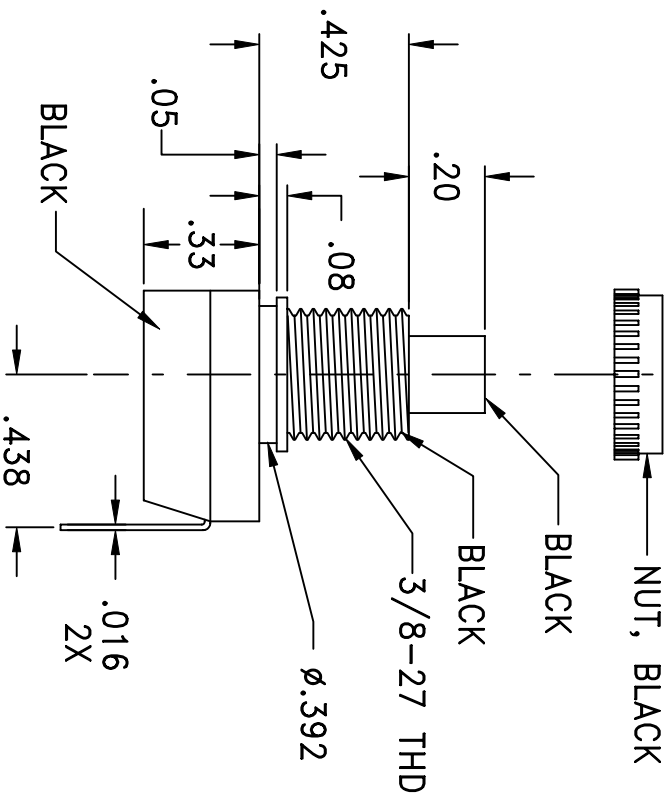
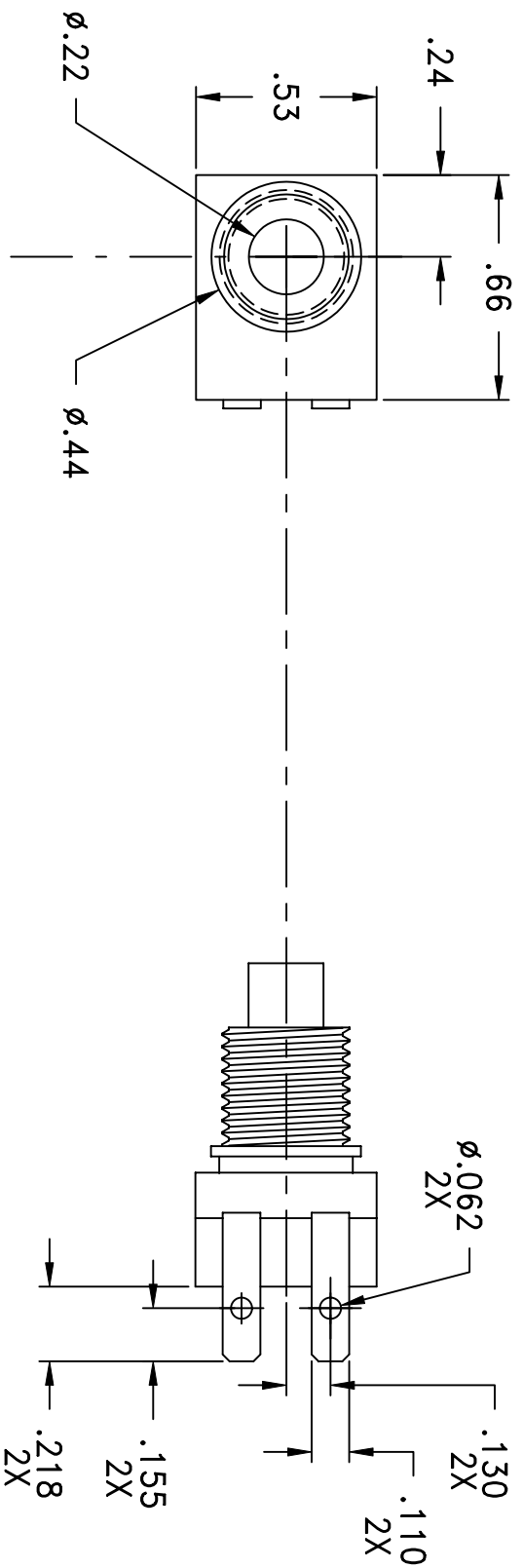

JUDCO INVENTORY NO. 40-4684-00
 SWITCH TYPE: SPST, PUSH ON - PUSH OFF
 UL ELECTRICAL RATING: 125 VAC, 6A
 UL TEMPERATURE RATING: 65°C
 NUT INCLUDED

CUSTOMER: DIGI-KEY
 CUSTOMER PN: TBD

APPROVED BY: _____
 DATE: _____

DIMENSIONS IN INCHES
 DIMENSIONS ARE REFERENCE

DRAWN: DC 12-28-07		TITLE	
APPR: KJ 12-28-07		HARBOR CITY CALIFORNIA	
ENG'G: IS 12-28-07		OUTLINE	
1415U1280A.DWG		J-188A-1 ULAC W/BENT TRMS	
SHEET		DWG. NO. 1415-1280	
1 OF 1			

This document embodies a product, component, and/or design proprietary to JUDCO MANUFACTURING INC., and which is protected either as a trade secret, by U.S. Patent, or by copyright. It may not be used in any way without written express consent of JUDCO MANUFACTURING INC.