

unimec™ basic switch modules

Basic module applies to all versions

Low temp.

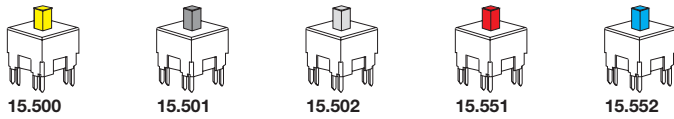

High temp.

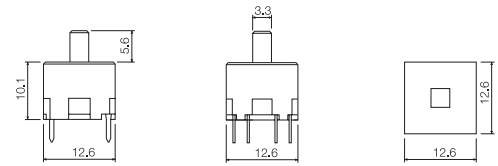
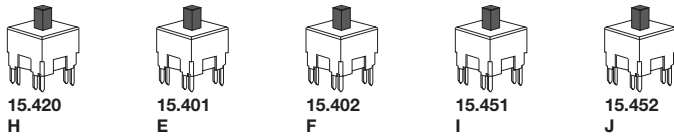

Part no:



Temperature:

5: low temp.
4: high temp.

Switch function:

0: momentary
5: alternate

Terminal

1: silver
2: gold
0: quiet version, silver

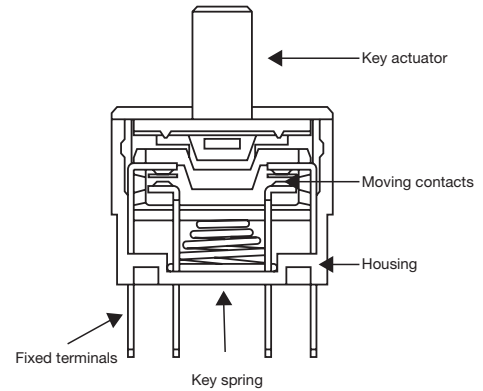

PCB Mounting Hole Dimensions Basic Switch	Circuit diagram (topview)	PCB Mounting Hole Dimensions (w/Extender 16250)	Functional diagram
	Without LED	With LED 16923 and 16924	— up --- down

Wiring Diagram

Select the contact function you desire - and design your PC board accordingly

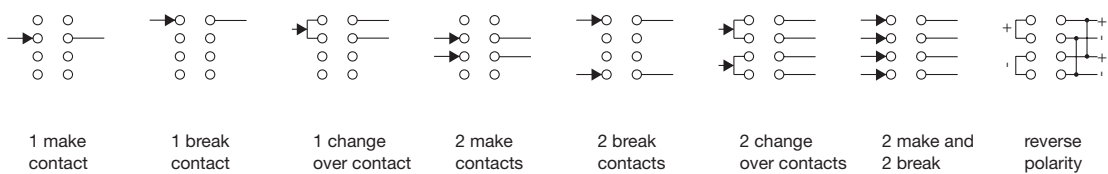

How to assemble

unimec™
15XXX + 16300 +
16310

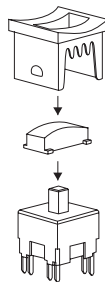

unimec™
15XXX + 16270 +
16300 + 16324

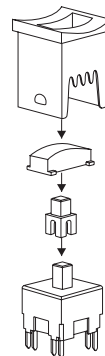

Operating Force (Typical example)

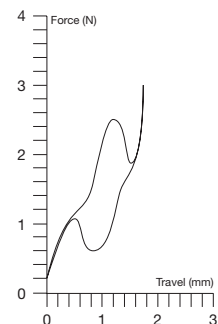

For updates of products and/or changes of specifications please see www.mec.dk