

**SERIES 39**  
SPST, 150 mA

**FEATURES**

- 1/4" Diameter
- Up to 1,000,000 Cycles of Operation
- PC Mount

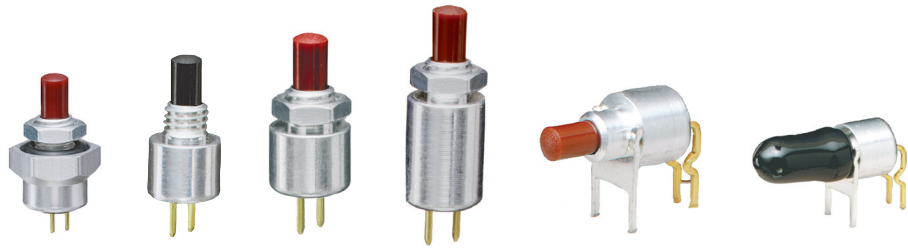

**DIMENSIONS** in Inches (and millimeters)

**SPST–Normally Open, without Nut**

39-405\*

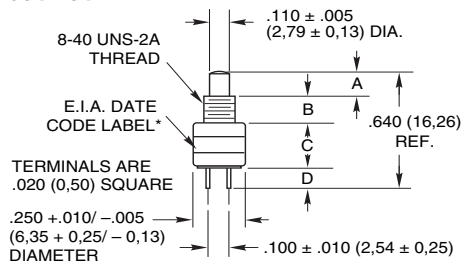

\*Label increases nominal diameter to .255 (6,48)

A = .175 + .025 / -.020 (4,45 + 0,64 / - 0,51)  
 B = .125 ± .010 (3,18 ± 0,25)  
 C = .215 ± .015 (5,46 ± 0,38)  
 D = .125 ± .010 (3,18 ± 0,25)

Rating at 28 Vdc Resistive	Operations at Rated Load	*Complete Part Number	Button Color
150 mA	1,000,000	39-405 RED 39-405 BLK	Red Black

Action	Total Travel	Actuating Force (oz.)
Momentary	.035 ± .015 (0,89 ± 0,38)	4 + 4 - 2

**SPST–Normally Open, with Nut**

39-401\*

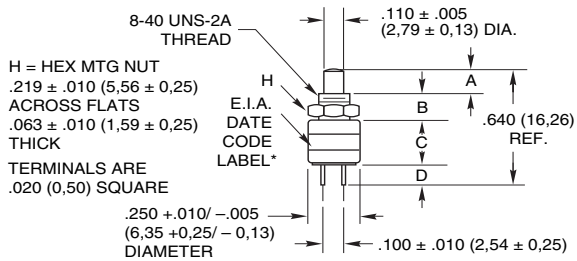

\*Label increases nominal diameter to .255 (6,48)

A = .175 + .025 / -.020 (4,45 + 0,64 / - 0,51)  
 B = .125 ± .010 (3,18 ± 0,25)  
 C = .215 ± .015 (5,46 ± 0,38)  
 D = .125 ± .010 (3,18 ± 0,25)

Rating at 28 Vdc Resistive	Operations at Rated Load	*Complete Part Number	Button Color
150 mA	1,000,000	39-401 RED 39-401 BLK	Red Black

Action	Total Travel	Actuating Force (oz.)
Momentary	.035 ± .015 (0,89 ± 0,38)	4 + 4 - 2

**SPST–Normally Open, with Overtravel**

39-424\*

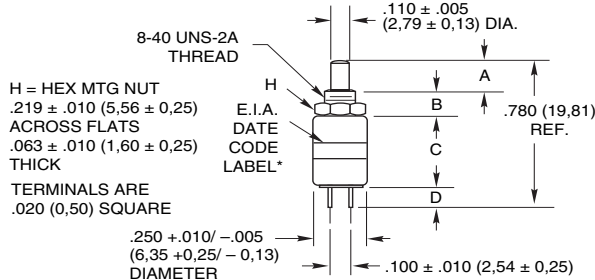

\*Label increases nominal diameter to .255 (6,48)

A = .175 + .025 / -.020 (4,45 + 0,64 / - 0,51)  
 B = .125 ± .010 (3,18 ± 0,25)  
 C = .355 ± .015 (9,02 ± 0,38)  
 D = .125 ± .010 (3,18 ± 0,25)

Rating at 28 Vdc Resistive	Operations at Rated Load	*Complete Part Number	Button Color
150 mA	100,000	39-424 RED 39-424 BLK	Red Black

Action	Total Travel	Over Travel	Actuating Force (oz.)
Momentary	.130 ± .025 (3,30 ± 0,64)	.015 (0,38) Min.	5 ± 3

**DIMENSIONS** in Inches (and millimeters)

**Right Angle, SPST–Normally Open**

39-501\*  
39-503\*

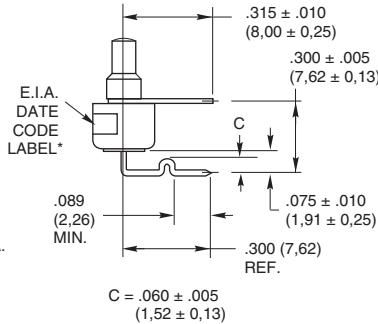
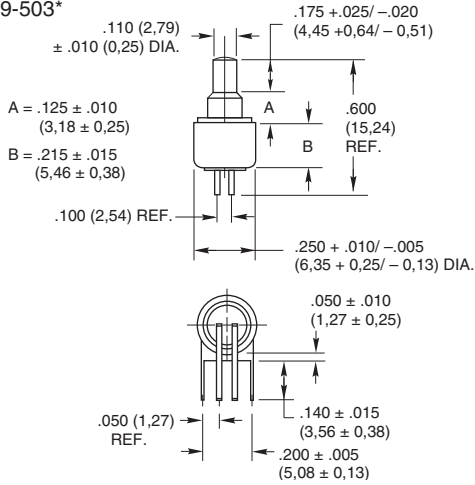

**Mounting Footprint**

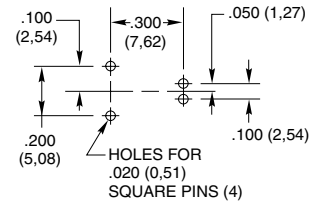

Rating at 28 Vdc Resistive	Operations at Rated Load	*Complete Part Number	Button Color
150 mA	1,000,000	39-501 RED 39-501 BLK 39-503 RED 39-503 BLK	Red Black Red Black

Action	Total Travel	Actuating Force (oz.)
Momentary	$.035 \pm .015 (0,89 \pm 0,38)$	4 + 4 - 2

\*Label increases nominal diameter to .255 (6,48)

Protective cap (included with 39-503 RED and 39-503 BLK) seals switch during wave soldering.

**SPST–Normally Open, with Panel and Button Seal**

39-138\*

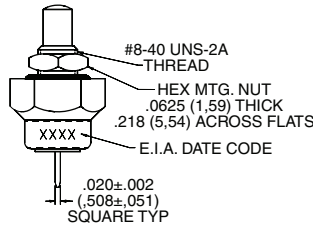
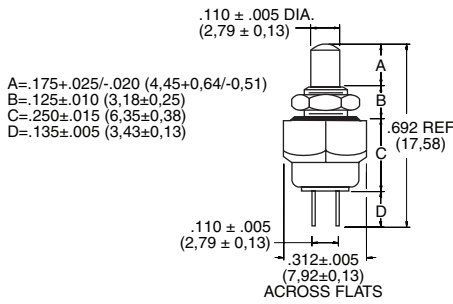

Rating at 115 Vac Resistive	Operations at Rated Load	*Complete Part Number	Button Color
½ Amp	250,000	39-138 RED 39-138 BLK	Red Black

Action	Total Travel	Actuating Force (oz.)
Momentary	$.035 \pm .015 (0,89 \pm 0,38)$	16 ± 8

**SPECIFICATIONS**

**Rating Criteria**

**Contact Resistance:** 25 milliohms maximum on a new switch

**Voltage Breakdown:** 1,000 Vac between mutually insulated parts

**Insulation Resistance:** 1,000 megohms minimum

**Operating Temperature:** -40°C to +85°C

**Materials and Finishes**

**Bushing/Housing:** Aluminum, clear anodized for 39-138; Brass, tin zinc for all others

**Standoff:** (39-501 and 39-503) Brass, tin plated over nickel

**Base and Button:** Thermoplastic

**Shorting Bar:** Brass, gold-plated over nickel plate for 39-501 and 39-503; fine silver, gold-plated for others

**Terminals:** Fine silver, gold-plated for 39-138; Brass, gold-plated over nickel for all others

**Spring:** Tinned music wire

**Mounting Nut:** (39-401 and 39-424) Brass, zinc trivalent chromate-plated

**ORDERING INFORMATION**

Part No.	Type & Button Color
39-401 RED	N.O., Red
39-401 BLK	N.O., Black
39-405 RED	N.O., No Nut, Red
39-405 BLK	N.O., No Nut, Black
39-424 RED	N.O., Overtravel, Red
39-424 BLK	N.O., Overtravel, Black
39-501 RED	N.O., Right Angle, Red
39-501 BLK	N.O., Right Angle, Black
39-503 RED	39-501 Red & Cap Seal
39-503 BLK	39-501 Blk & Cap Seal
39-138 RED	39-351 PC Mount & Seal
39-138 BLK	39-351 PC Mount & Seal

**CIRCUITRY**

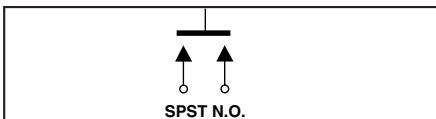

**ACCESSORIES**



Accessory Part Number	Description
30B1012-5	Red Accessory Cap
30B1012-8	White Accessory Cap
30B1012-9	Black Accessory Cap
SHH1699	Cap Seal Only, Black

Available from your local Grayhill Distributor. For prices and discounts, contact a local Sales Office, an authorized Distributor or Grayhill.