

SHEET OF

POS. 1 DESIGNATE  
PIN #1 LOCATION

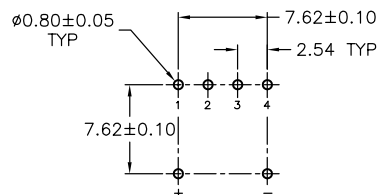

RECOMMENDED PCB LAYOUT

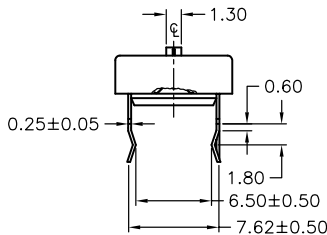
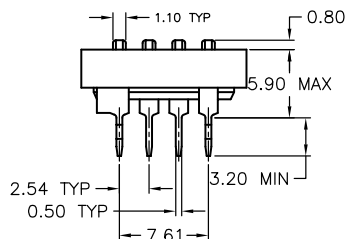
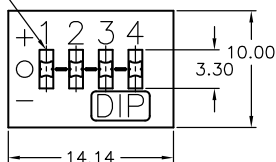
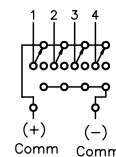

CONTACT CONFIGURATION  
POS. 1 DENOTES PIN #1

NOTES:

1. ALL DIMENSIONS IN MM
2. GENERAL TOLERANCE: 0.0±0.4  
0.00±0.25
3. TERM. NOS. FOR REF. ONLY
4. SWITCHES SUPPLIED IN DESPENSING TUBES  
PACKAGE WITH ALL POLES IN  
THE "OFF" POSITION- 19 SWITCHES/TUBE
5. CONTACT RATING: 25mA @24V DC
6. OPERATING LIFE: 2,000 make-and-break cycles
7. OPERATING FORCE: 1000gf max.
8. TRAVEL: 2.0mm typical
9. DIELECTRIC STRENGTH: 500V RMS min @seal level  
between adj. term.
10. TEMP. RANGE: -40C to 85C

**E-SWITCH®**

TITLE		KAT1104E (4 Pos. DIP Switch) Package in Tubes			
SCALE	DATE	DR	DWG	REV	
3:1	11/5/03	AR	N711040	A	

REV.	ECN No.	DESCRIPTION	DATE	CHKD
A	13577	RELEASED FOR PRODUCTION	11/5/03	AR

THE INFORMATION CONTAINED IN THIS DOCUMENT IS PROPRIETARY TO E-SWITCH AND IS NOT TO BE COPIED OR TRANSFERRED