

DRAWING MADE IN THIRD ANGLE PROJECTION

THIS DRAWING IS UNPUBLISHED. RELEASED FOR PUBLICATION, 19 .

© COPYRIGHT 19 BY AMP INCORPORATED. ALL INTERNATIONAL RIGHTS RESERVED.

LOC	DIST	REVISIONS				DATE	APPD
AG	1	P	F	ZONE	LTR	DESCRIPTION	
					V	REACT-9; PER 0G50-0052-98	5-6-98 LM

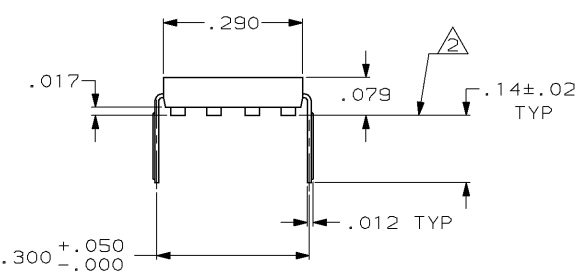
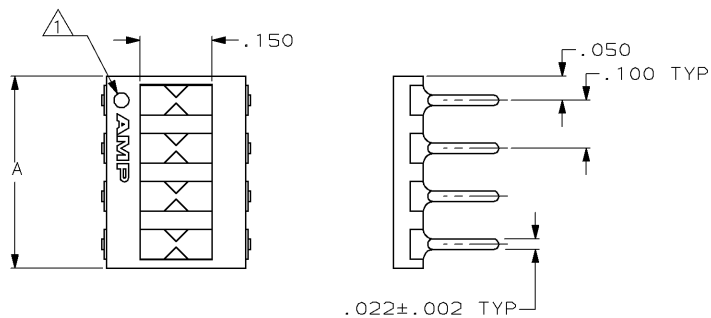

△ PIN NUMBER ONE IDENTIFICATION.

△ MOUNTING SURFACE WHEN INSERTED IN .040 DIA MOUNTING HOLES.

OBsolete	.000015 MIN GOLD ON CONTACT LEADS,	.400	4	1-435704-6
OBsolete	OVER NICKEL.	.800	8	1-435704-4
	.000100 MIN. TIN OVER NICKEL	1.200	12	1-435704-2
		1.000	10	1-435704-0
		.900	9	435704-9
		.800	8	435704-8
		.700	7	435704-7
		.600	6	435704-6
OBsolete		.500	5	435704-5
		.400	4	435704-4
OBsolete		.300	3	435704-3
OBsolete		.200	2	435704-2

PLATING		A	NO. OF POSN	PART NO
DO NOT SCALE PRINT. UNLESS SPECIFIED DIMENSIONS TOLERANCES ON: 2 PLC DEC ± 3 PLC DEC ± .005 ANGLES ±	DR 12 OCT 1989 M. CYRUS	AMP INCORPORATED Harrisburg, Pa. 17105		
MATERIAL HOUSING: BLACK POLYESTER CONTACT: COPPER ALLOY	CHK - APPD - APPD - PRODUCT SPEC -			
FINISH SEE TABLE	APPLICATION SPEC - WEIGHT -	NAME SHUNT, DIP, PROGRAMMABLE 7600 SERIES	SIZE <b>B</b>	CAGE CODE 00779
		DRAWING NO 435704	SCALE 5:1	SHEET 1 OF 1

AMP 1470-15 REV 6-89  
06-MAY-98 13:39:38 amp4354 /home/amp4354/atomd

CUSTOMER DRAWING