

4

3

2

1

THIS DRAWING IS UNPUBLISHED. RELEASED FOR PUBLICATION 1825058. ALL RIGHTS RESERVED.

LOC		DIBT		REVISIONS			
F	LR	DESCRIPTION		DATE	BY	APPD	
P		REVISED PER ECO-11-004587		11MAR11	RK	HMR	

SPECIFICATIONS:

MATERIAL
 BASE, PPS, UL94V-0, BLACK
 COVER, PPS, UL94V-0, BLACK
 ACTUATOR, PA6T, UL94V-0, WHITE
 FIXED CONTACT/TERMINAL, CU ALLOY-GOLD FLASH OVER NICKEL
 MOVING CONTACT, CU ALLOY, PLATE-GOLD FLASH/NICKEL

ELECTRICAL
 MAX CONTACT RATING SWITCHING, 100MILLIAMPS @ 24 VDC
 MIN CONTACT RATING SWITCHING, .1MICROAMP @ 1 MILLIVOLT
 MAX CONTACT NON-SWITCHING, 1AMP @ 5 VDC
 INITIAL CONTACT RESISTANCE, 50 MILLIOHMS MAX.
 CONTACT RESISTANCE (AFTER ENVIRONMENTAL TEST), 100 MILLIOHMS
 CONTACT RESISTANCE (AFTER GAS TEST), 300 MILLIOHMS
 INSULATION RESISTANCE, 1,000 MEGOHMS MIN. @ 100 VDC
 DIELECTRIC STRENGTH, 500 VAC RMS @ SEA LEVEL
 LIFE EXPECTANCY, 1,000 CYCLES

MECHANICAL
 OPERATING FORCE, LESS THAN 800 GRAMS
 CONTACT PRESSURE, 280,000 PSI

ENVIRONMENTAL
 OPERATING TEMPERATURE, -30 TO +85 DEGREES C
 STORAGE TEMPERATURE, -45 TO +105 DEGREES C
 CLEANING, AQUEOUS OR SOLVENT
 SOLDER HEAT RESISTANCE, PER 109-201, COND B, SWITCH "OFF".
 SOLDERABILITY PER JIS C 0050 & JIS C 0053

- SWITCHES TO BE RECEIVED IN THE "OFF" POSITION AND PACKAGED IN CLEAR TUBES TO ACCOMMODATE AUTO-INSERTION.
- TOP SURFACE TO BE CLEARLY MARKED AS SHOWN.
- SWITCHES TO BE BLACK WITH WHITE ACTUATORS AND MARKINGS.
- TERMINAL OPTION: OLD T&B P/N ADExxS, SA OR SB
 S= OUTSIDE "L" TERMINALS; SA= INSIDE "L" TERMINALS;
 SB= BUTT TERMINALS
- ALL MATERIALS AND FINISHES SHALL COMPLY WITH EU DIRECTIVE 2002/95/EC OF 27JAN2003 (ROHS)
- OBsolete PARTS: OBSOLETE CIS STREAMLINING PER D.RENAUD/D.SINISI

SEE SHEET 2 FOR PART NUMBER TABLE AND MOUNTING OPTIONS

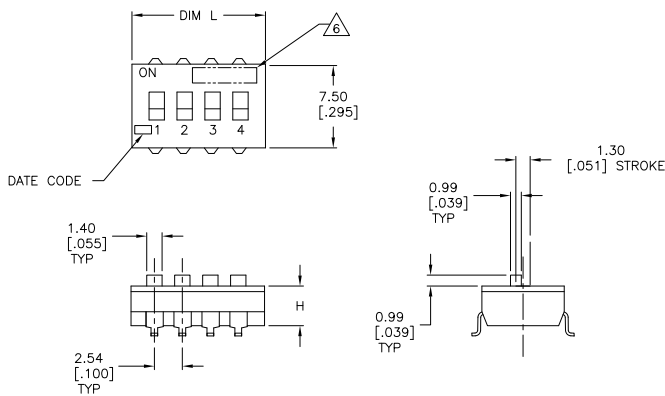

THIS DRAWING IS A CONTROLLED DOCUMENT.		DWG NO. S.S.VISVESWARA 10FE805			
DIMENSIONS: mm [INCHES]		DWG CHK. M. SARVER DATE 12/08/08 PRODUCT SPEC.			
TOLERANCES UNLESS OTHERWISE SPECIFIED: 0 PLC ± .25 1 PLC ± .125 2 PLC ± .050 3 PLC ± .030 (0.125) 4 PLC ± .010 ANGLES ± .5°		APPLICATION SPEC. - WEIGHT - MATERIAL - FINISH -		SIZE A2	CASE CODE - DRAWING NO. C=1825058 RESTRICTED TO -
CUSTOMER DRAWING			SCALE 4:1	SHEET 1 of 2	REV P

4

3

2

1

THIS DRAWING IS UNPUBLISHED. RELEASED FOR PUBLICATION 1825058 ALL RIGHTS RESERVED.
 © COPYRIGHT 1825058

LOC	DIST	REVISIONS					
AD	0	F	LWR	DESCRIPTION	DATE	BY	APPD
		-	-	SEE SHEET 1	-	-	-

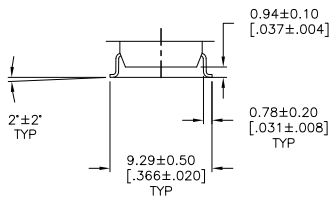
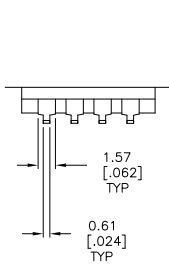

SURFACE MOUNT S (OUTSIDE "L")

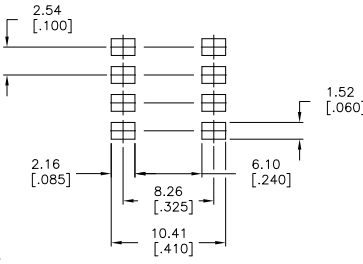

RECOMMENDED PAD LAYOUT

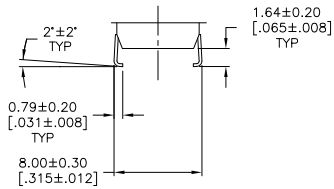
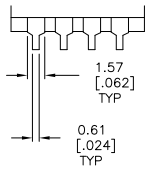

SURFACE MOUNT SA (INSIDE "L")

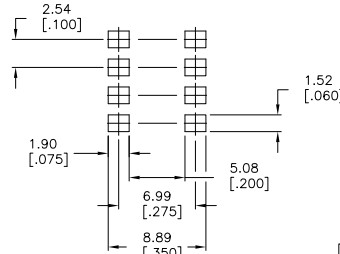

RECOMMENDED PAD LAYOUT

ADE12SB04	3.61	.142	32.51	1.280	12	3-1825058-0
ADE12SA04	3.61	.142	32.51	1.280	12	2-1825058-9
ADE12S04	3.61	.142	32.51	1.280	12	2-1825058-8
ADE10SB04	3.50	.138	27.36	1.078	10	2-1825058-7
ADE10SA04	3.50	.138	27.36	1.078	10	2-1825058-6
ADE10S04	3.50	.138	27.36	1.078	10	2-1825058-5
ADE09SB04	3.50	.138	24.54	.978	9	2-1825058-4
ADE09SA04	3.50	.138	24.54	.978	9	2-1825058-3
ADE09S04	3.50	.138	24.54	.978	9	2-1825058-2
ADE08SB04	3.50	.138	22.30	.878	8	2-1825058-1
ADE08SA04	3.50	.138	22.30	.878	8	2-1825058-0
ADE08S04	3.50	.138	22.30	.878	8	1-1825058-9
OBSOLETE ADE07SB04	3.50	.138	19.76	.778	7	1-1825058-8
ADE07SA04	3.50	.138	19.76	.778	7	1-1825058-7
ADE07S04	3.50	.138	19.76	.778	7	1-1825058-6
ADE06SB04	3.50	.138	17.22	.678	6	1-1825058-5
ADE06SA04	3.50	.138	17.22	.678	6	1-1825058-4
ADE06S04	3.50	.138	17.22	.678	6	1-1825058-3
OBSOLETE ADE05SB04	3.50	.138	14.68	.578	5	1-1825058-2
ADE05SA04	3.50	.138	14.68	.578	5	1-1825058-1
ADE05S04	3.50	.138	14.68	.578	5	1-1825058-0
ADE04SB04	3.50	.138	12.14	.478	4	1825058-9
ADE04SA04	3.50	.138	12.14	.478	4	1825058-8
ADE04S04	3.50	.138	12.14	.478	4	1825058-7
OBSOLETE ADE03SB04	3.50	.138	9.60	.378	3	1825058-6
ADE03SA04	3.50	.138	9.60	.378	3	1825058-5
ADE03S04	3.50	.138	9.60	.378	3	1825058-4
ADE02SB04	3.50	.138	7.06	.278	2	1825058-3
ADE02SA04	3.50	.138	7.06	.278	2	1825058-2
ADE02S04	3.50	.138	7.06	.278	2	1825058-1
T&B P/N		DIM H	DIM L	POSITION	PART NO.	

THIS DRAWING IS A CONTROLLED DOCUMENT. DIM S.S.VISWESWARA 10FE805

TE Connectivity

DIP SWITCH, ADE-SMT SERIES

DATE: 03/2012

SCALE: 4:1 SHEET 2 of 2 REV P

1825058

A