

multimec[®] 3F/4F WA/1WD/1WP

Technical Data

- through-hole or SMD
- 50mA/24VDC
- single pole/momentary
- 10.000.000 operations life time
- IP67 sealing
- temperature range:
low temp: -40/+115°C
high temp: -40/+160°C



Keycaps in frosted white shown on this page can also be used on **illumec™ switch 4F**

Dimensions (through-hole) 3F 1WA

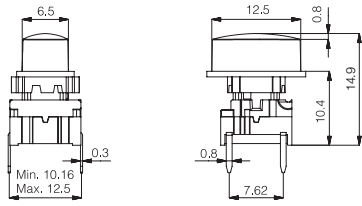

PCB layout

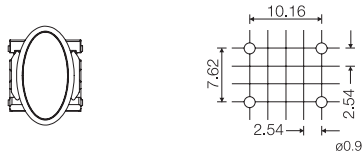

Dimensions (w/LED) 3F 1WD

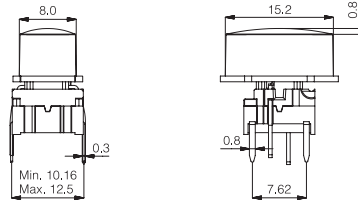

PCB layout (top view)

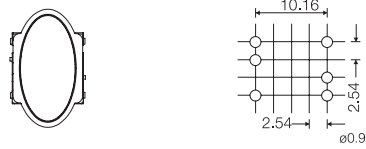

Dimensions (SMD) 3F 1WP

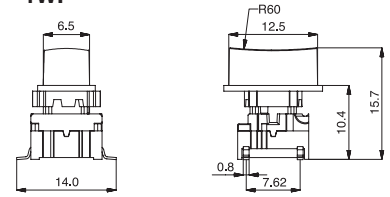

PCB layout

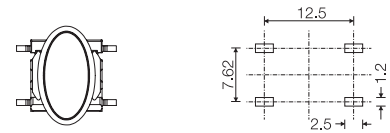

8 different position options

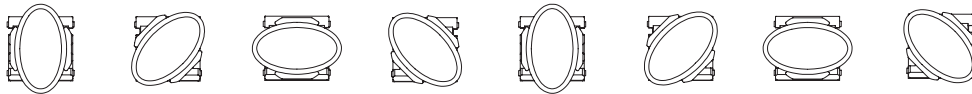

How to order

3 F

Switch



Mounting

T through-hole
S surface mount



L 6 low temp.
H 9 high temp.

+



Cap



00 blue
03 grey
08 red
09 black
30 ultra blue
40 pigeon blue
42 aqua blue
53 metal light grey
57 metal dark grey

3 F

Switch



Mounting

T through-hole



L 6 low temp.
H 9 high temp.



LED
24 green
45 yellow
89 red

+



Cap

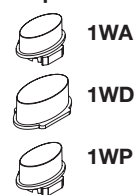

16 frosted white

Ordering example: 3FTL6 + 1WA09 or 3FTL689 + 1WP16

For updates of products and/or changes of specifications please see www.mec.dk