

### Technical Data

- Max. 250mA/120V/9W AC/6W DC
- 2 pole
- momentary or alternate
- 8 contact functions
- temperature range:
  - low temp: -40/+75°C
  - high temp: -40/+160°C
- through-hole version

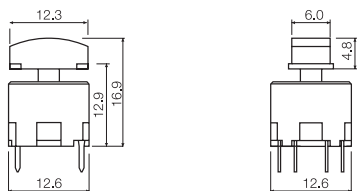

### Dimensions 16300



### PCB layout

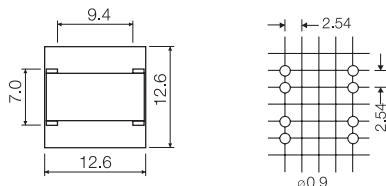

### Dimensions 16700

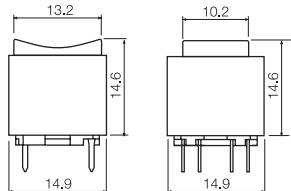

### PCB layout

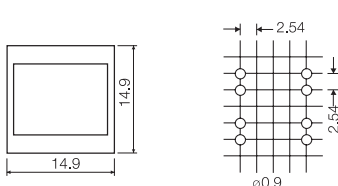

### Dimensions 16800

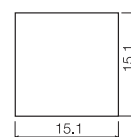
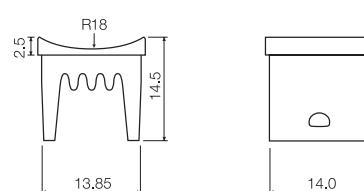

Blanking Cap  
can be used with  
VARIO SUPPORT

### How to order

**1 5** + **1 6 3 0 0**



- Switch**
- 15501 mom. silver
  - 15551 alt. silver
  - 15502 mom. gold
  - 15552 alt. gold
  - 15500 silent silver
  - 15401 mom. silver high temp.
  - 15402 mom. gold high temp.
  - 15420 silent gold high temp.
  - 15451 alt. silver high temp.

**1 6 3 0 0**



- Cap**
- |           |               |                     |
|-----------|---------------|---------------------|
| 00 blue   | 30 ultra blue | 50 metal dark blue  |
| 01 brown  | 40 dusty blue | 53 metal light grey |
| 02 green  | 42 aqua blue  | 57 metal dark grey  |
| 03 grey   | 32 mint green | 58 metal bordeaux   |
| 04 yellow | 33 tele grey  |                     |
| 05 golden | 34 melon      |                     |
| 06 white  | 38 noble red  |                     |
| 07 orange |               |                     |
| 08 red    |               |                     |
| 09 black  |               |                     |

**1 5** + **1 6 7 0 0**



### Switch

- Cap**
- |           |          |
|-----------|----------|
| 00 blue   | 06 white |
| 02 green  | 08 red   |
| 03 grey   | 09 black |
| 04 yellow |          |

**1 6 8 0 0**

### Blanking Cap



- |           |           |                       |
|-----------|-----------|-----------------------|
| 00 blue   | 06 white  | 11 transparent        |
| 01 brown  | 07 orange | 12 transparent green  |
| 02 green  | 08 red    | 14 transparent yellow |
| 03 grey   | 09 black  | 18 transparent red    |
| 04 yellow |           |                       |
| 05 golden |           |                       |

Ordering example: 15551 + 1670009

For updates of products and/or changes of specifications please see [www.mec.dk](http://www.mec.dk)