

PF Series 5 Tumbler Miniature Snap-in Switchlocks

SWITCH AND LOCK FUNCTION

| SINGLE & DOUBLE POLE SWITCHES | | | | | | | |
|-------------------------------|--------------------------------|---------------------|-----------------|----------|--------------------|--------------------|----------|
| NO. POLES | MODEL NO. | CONNECTED TERMINALS | | | KEY PULL POSITIONS | LOCK CONFIGURATION | INDEXING |
| | | POS. 1 | POS. 2 | POS. 3 | | | |
| DP | PF201U | 8-1, 4-5 | 1-2, 5-6 | 2-3, 6-7 | Positions 1 & 3 | | 45° |
| SP DP | PF011U PF211U | 8-1 8-1, 4-5 | 1-3 1-3, 5-7 | | Positions 1 & 2 | | 90° |

All models with all options when ordered with 'Q' contact material.

LEGEND

- = Detent Positions (45° or 90°)
- ⊙ = Key pull possible in these positions.
- ⊙ = Stop Positions

TERMINAL NUMBERS

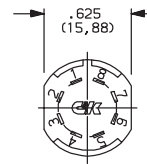

Terminal numbers molded on housing.

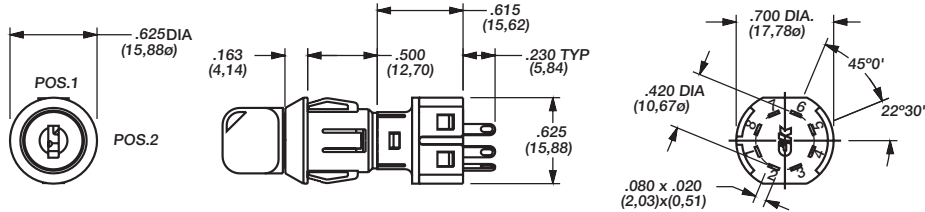

Part number shown: PF011UEBM03KQ22

KEYING

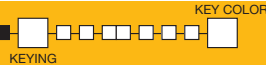

E TWO NICKEL PLATED BRASS KEYS WITH INSERT MOLDED PLASTIC HEAD

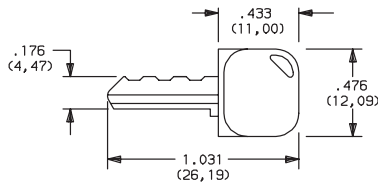

Key part number: 334C1004102

| OPTION CODE | KEY COLOR |
|-------------|-----------|
| 2 | BLACK |

NOTE: All orders keyed alike, standard. For more than one key code, replacement keys, or other special features, consult Customer Service Center.

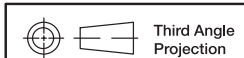

Dimensions are shown: Inch (mm)
Specifications and dimensions subject to change



PF Series 5 Tumbler Miniature Snap-in Switchlocks

LOCK TYPE 

B 5 TUMBLER LOCK WITH DETENT

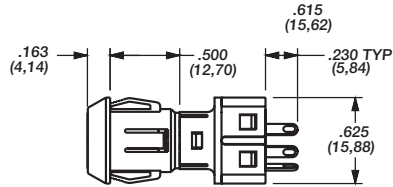

| OPTION CODE | LOCK COLOR |
|-------------|------------|
| 2 | BLACK |

LOCK FINISH 

M PLASTIC LOCK WITH MATTE FINISH



TERMINATIONS 

03 SOLDER LUG WITH HOLE

WC WIRE LEAD

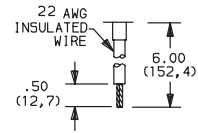
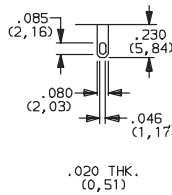

Black wire standard, other colors and lengths available, consult Customer Service Center. UL style 1015.

LOCK STYLE 

K CONE SHAPED FACING

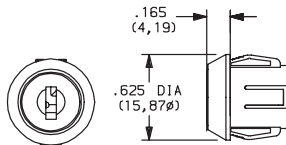

Switch and Lock Assembly Instructions

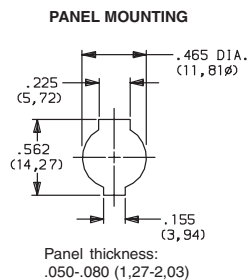
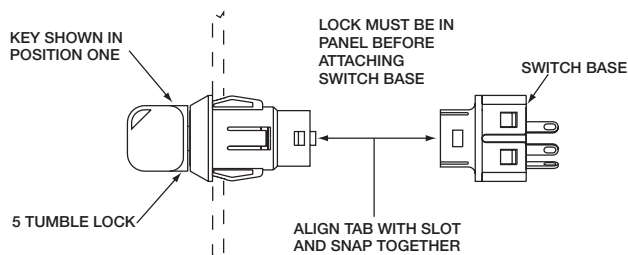

NOTE: Switch installation is permanent. Switch cannot be removed from lock after assembly. Attempts to separate switch and lock may damage switch.

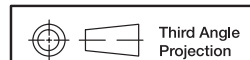

Dimensions are shown: Inch (mm)
Specifications and dimensions subject to change



Switchlock

PF Series 5 Tumbler Miniature Snap-in Switchlocks

CONTACT MATERIAL

| OPTION CODE | RoHS COMPLIANT* | RoHS COMPATIBLE* | CONTACT AND TERMINAL MATERIAL | RATING | |
|-------------|-----------------|------------------|-------------------------------|-----------------------|---|
| | | | | | |
| Q | YES | YES | SILVER ² | POWER | 4 AMPS @ 125 V AC or 28 V DC; 2 AMPS @ 250 V AC (UL/CSA). |
| B | YES | YES | GOLD ¹ | LOW LEVEL/DRY CIRCUIT | 0.4 VA MAX. @ 20 V AC or DC MAX. |

* Note: See Technical Data section of this catalog for RoHS compliant and compatible definitions and specifications.

¹ CONTACTS & TERMINALS: Copper, with gold plate over nickel plate.

² CONTACTS & TERMINALS: Copper, silver plated (standard with all termination options).

All models  with all options when ordered with 'Q' contact material.

AVAILABLE HARDWARE



Key Code: 041

PART NO. (ONE KEY)

334C1004102 BLACK

Material: Brass
Finish: Nickel plate
6/6 Nylon insert molded head



Switchlock

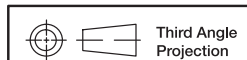

Third Angle Projection

Dimensions are shown: Inch (mm)
Specifications and dimensions subject to change

www.ck-components.com