

XStick®

USB to XBee® Wireless PAN Adapter for Laptops & PCs

The XStick provides local connectivity to a wireless XBee network from a laptop or PC, enabling local commissioning of the network and its devices.



Overview

Digi's XStick is an easy-to-use USB to XBee Wireless Personal Area Network (WPAN) adapter, providing local connectivity to wireless networks. Simply plug the XStick into the USB port of a laptop or PC for instant access to an XBee network and its connected devices. This compact, USB-powered wireless adapter enables local network configuration, diagnostics or device monitoring.

Two versions are available. The XStick 802.15.4 version is compatible with XBee and XBee-PRO® 802.15.4 devices and uses a fast multipoint network. The XStick ZB version is compatible with XBee or XBee-PRO ZB devices and utilizes the ZigBee PRO Feature Set for robust mesh networks.

XStick and XBee products are part of Digi's Drop-in Networking family of solutions, offering users seamless wireless communication between devices, including adapters, routers and gateways.

Application Highlight

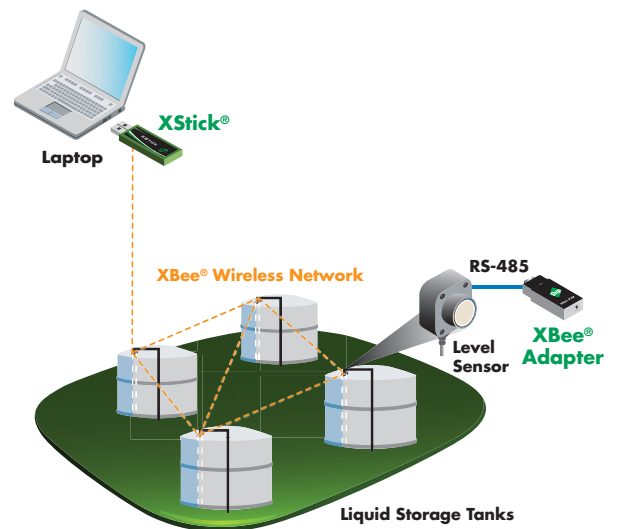

Features/Benefits

- USB to XBee Wireless Personal Area Network adapter (WPAN)
- Provides local connectivity for access, configuration and network commissioning
- Available in self-healing, self-configuring ZigBee mesh or fast 802.15.4 multipoint versions
- USB powered
- LEDs for power status and network association

Related Products

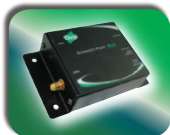

Gateways

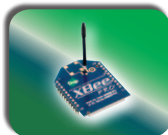

Modules



Adapters



Development Kits



Network Extenders



Sensors



www.digi.com

Specifications

XStick® ZB

XStick® 802.15.4

Performance		
Indoor/Urban Range	66 ft (20 m)	49 ft (15 m)
Outdoor/RF Line-of-Sight Range	164 ft (50 m)	131 ft (40 m)
Transmit Power Output (Nominal 25° C)	2.8 mW (4.5 dBm)	1 mW (0 dBm)
RF Data Rate	250 Kbps	
Serial Interface Data Rate (Software Selectable)	1200 bps - 115.2 Kbps	
Receiver Sensitivity	-90 dBm	
Power Requirements		
Supply Voltage	5V from USB port of PC	
Transmit Current	51 mA	64 mA
Receive Current	47 mA	64 mA
Power-Down Current	XStick should not be put into sleep mode	
General		
Frequency Band	2.4 GHz ISM	
Dimensions (L x W x H)	2.29 in x 0.80 in x 0.43 in (5.83 cm x 2.03 cm x 1.08 cm)	
Operating Temperature	-40° C to +85° C	
Connector	USB Type A	
Antenna Options	Internal only	
Networking & Security		
Supported Network Topologies	ZigBee Mesh	Point-to-Point, Point-to-Multipoint, Peer-to-Peer
Number of Channels (Software Selectable)	16	
Addressing Options	PAN, Channel, Address	
Regulatory Approvals		
FCC Part 15.247 (USA)	Yes (MCQ-XSTICK2)	Pending (MCQ-XSTICK1)
IC (Canada)	Yes (1846A-XSTICK2)	Pending (1846A-XSTICK1)
ETSI (Europe)	Yes	Pending
TELEC (Japan)	Yes	No

XStick - Top View

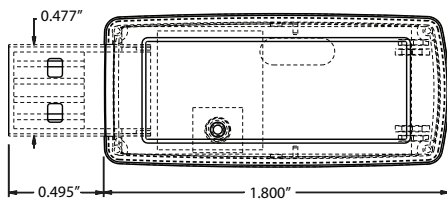

XStick - Side View

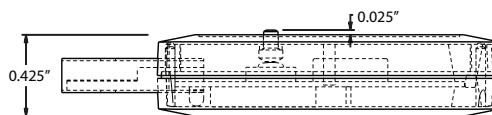

XStick - Connector

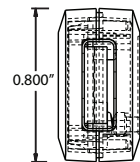

Visit www.digi.com for part numbers.

DIGI SERVICE AND SUPPORT - You can purchase with confidence knowing that Digi is here to support you with expert technical support and a strong five-year warranty. www.digi.com/support

Digi International
877-912-3444
952-912-3444
info@digi.com

Digi International France
+33-1-55-61-98-98
www.digi.fr

Digi International KK
+81-3-5428-0261
www.digi-intl.co.jp

Digi International (HK) Limited
+852-2833-1008
www.digi.cn



91001463
B1/210

BUY ONLINE • www.digi.com



© 2008-2010 Digi International Inc. All rights reserved. Digi, Digi International, the Digi logo, the Making Wireless M2M Easy logo, XBee, XBee-PRO and XStick are trademarks or registered trademarks of Digi International Inc. in the United States and other countries worldwide. All other trademarks are the property of their respective owners. All information provided is subject to change without notice.