

Power Supply Specifications for Roving Networks Products.

PART NUMBER	voltage	Min. current	Db-9 serial port *
RN-240M (F) firefly	5vdc – 12vdc	100ma	Pin 9
RN-220XP blueport	5vdc only!	100-500ma	Do not connect!
RN-422M	5vdc only!	150ma	Pin 6

* note: firefly can accept 5-12Vdc on pin 9 of serial connector.

Power Connector Specifications:

(millimeters)

A = 3.5

B = 1.3

C = 6 (or longer is ok)

CENTER PIN IS POSITIVE (+) VOLTAGE, outer is GROUND.

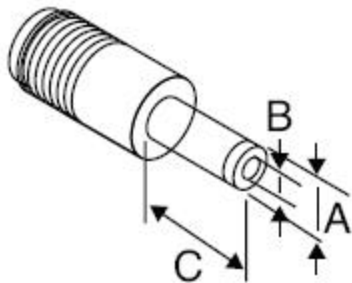

Roving Networks power supply options:

PART NUMBER		
RN-PS-US	5vdc 1A, USA plug	
RN-PS-INT	5vdc 1A, 4 plugs = USA, EU, GB, U/NZ	
RN-PS-USB	USB cable (100ma limit)	