

OPERATING CHARACTERISTICS AT T<sub>A</sub> = 25°C

DIFFUSED LENS COLOR	PEAK EMISSION WAVELENGTH (nm)	VIEWING ANGLE (°) 2 @ 1/2	CAPACITANCE (pF); @V <sub>r</sub> = 0; f = 1MHz		LUMINOUS INTENSITY (mcd) @ I <sub>f</sub> = 10 mA; 25°C		FORWARD VOLTAGE (V) @ I <sub>f</sub> = 20 mA; 25°C		REVERSE CURRENT (μA); 25°C
			TYP.	MIN.	TYP.	TYP.	MAX.	MAX.	
RED	635	60	20	7.4	10.0	2.0	2.8	100 @ V <sub>r</sub> = 5 V	
GREEN	565	60	35	4.7	12.6	2.1	2.8	100 @ V <sub>r</sub> = 5 V	
YELLOW	585	60	15	7.4	10.0	2.1	2.8	100 @ V <sub>r</sub> = 5 V	

REV	ECN NO	REVISIONS	DRN	CKD	APP	DATE
A		NEW RELEASE	TWC			

ABSOLUTE MAXIMUM RATINGS AT 25° C AMBIENT	RED	GREEN	YELLOW	UNITS
POWER DISSIPATION	100	100	60	mW
CONTINUOUS FORWARD CURRENT	30	30	20	mA
PEAK FORWARD CURRENT (1/10 DUTY CYCLE, 0.1 ms PULSE WIDTH)	120	120	80	mA
DERATING LINEAR FROM 50° C	0.4	0.4	0.25	mA/°C
REVERSE VOLTAGE	5			V
SOLDERING TEMPERATURE (.063/(1.60) FROM BODY	260°C FOR 5 SEC			°C
OPERATING TEMPERATURE	-55 TO +100			°C
STORAGE TEMPERATURE	-55 TO +100			°C

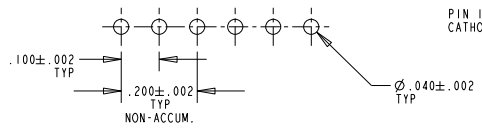
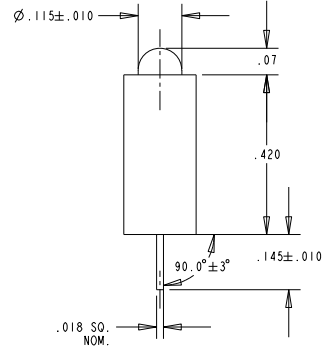
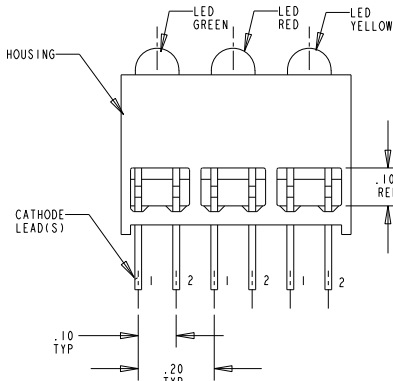
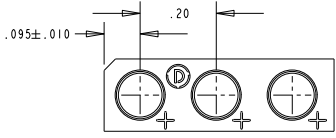

RECOMMENDED PC BOARD HOLE PATTERN

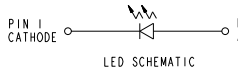

NOTES:

- LEADS TO FIT INTO HOLES SPACED AS PER PATTERN.
- LED LEAD DIMENSIONS SHOWN ARE MEASURED AT HOUSING EXIT.
- PIN NUMBERS FOR REFERENCE ONLY, DESIGNATION IS NON-EXISTENT ON PARTS.
- PACKAGE 50 PC'S PER ANTISTATIC AUTOBAG WITH P/N, QTY, DATE CODE AND MFG. PRINTED ON BAG.
- DIALIGHT PART NUMBER: 562-0003-801F
- THIS ASSEMBLY CONTAINS ELECTROSTATIC DISCHARGE SENSITIVE DEVICES (ESDS). MAINTAIN ALL PRECAUTIONARY MEASURES DURING ASSEMBLY, HANDLING AND STORAGE IN ACCORDANCE WITH IPC-A-610.

RoHS Compliant 562-0003-801F

Part Numbers with the "F" suffix ending are RoHS Compliant. Packaging is marked with "RoHS Compliant" label or equivalent markings. Parts can be wave soldered, dip soldered or hand soldered using typical lead-free soldering process with max 260°C temp. for 5 sec.

**ATTENTION:**  
OBSERVE PRECAUTIONS FOR HANDLING ELECTROSTATIC SENSITIVE DEVICES



THIS DRAWING AND THE CONTENTS HEREIN ARE CONFIDENTIAL AND THE SOLE PROPERTY OF DIALIGHT. REPRODUCTION OF THIS DRAWING OR CONSTRUCTION OF ANY PARTS WITHIN THIS DRAWING ARE FORBIDDEN WITHOUT THE WRITTEN CONSENT OF DIALIGHT.		
SCALE: DRAWING SCALE ALL DIM'S IN: INCHES (MM)	DRAWING NUMBER C-17368	REV A
TOLERANCES: UNLESS OTHERWISE SPECIFIED FRACTIONS: ±1/4 DECIMALS (.XX): ±.01 DECIMALS (.XXX): ±.005 DECIMALS (.XXXX): ±.0005 ANGLES: ±1°	TITLE 3X1 CBI RoHS COMPLIANT	MATERIAL
FINISH:	Dialight 1501 ROUTE 34 SOUTH FARMINGDALE, NJ 07727	
FSCM 83330	SHEET 1 OF 1 FAMILY TABLE:	