

AE-7395-N B

NO. OF CCTS. —

WAFER ASSY. OPTION -

PLATING TYPE
BLANK: TIN
G: GOLD

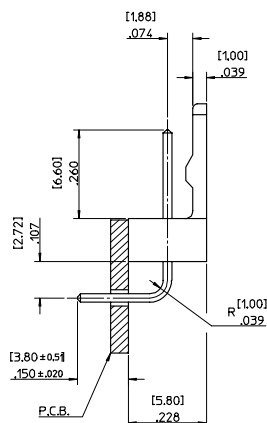

NO. OF CCTS	DIM. A	DIM. B
2	2.54/100	5.08/200
3	5.08/200	7.62/300
4	7.62/300	10.16/400
5	10.16/400	12.70/500
6	12.70/500	15.24/600
7	15.24/600	17.78/700
8	17.78/700	20.32/800
9	20.32/800	22.86/900
10	22.86/900	25.40/1000
11	25.40/1000	27.94/1100
12	27.94/1100	30.48/1200
13	30.48/1200	33.02/1300
14	33.02/1300	35.56/1400
15	35.56/1400	38.10/1500
16	38.10/1500	40.64/1600
17	40.64/1600	43.18/1700
18	43.18/1700	45.72/1800
19	45.72/1800	48.26/1900
20	48.26/1900	50.80/2000

PIN FINISH:
[0.005]/0.0002 MIN. TIN
OVER
[0.003]/0.0001 MIN. COPPER

PIN FINISH:
[0.0005]/0.00002 MIN. GOLD
OVER
[0.0008]/0.00003 MIN. NICKEL

ENG. NO.	PART NO.	ENG. NO.	PART NO.
AE-7395-2B	22-05-7028	AE-7395-2BG	22-12-4022
AE-7395-3B	22-05-7038	AE-7395-3BG	22-12-4032
AE-7395-4B	22-05-7048	AE-7395-4BG	22-12-4042
AE-7395-5B	22-05-7058	AE-7395-5BG	22-12-4052
AE-7395-6B	22-05-7068	AE-7395-6BG	22-12-4062
AE-7395-7B	22-05-7078	AE-7395-7BG	22-12-4072
AE-7395-8B	22-05-7088	AE-7395-8BG	22-12-4082
AE-7395-9B	22-05-7098	AE-7395-9BG	22-12-4092
AE-7395-10B	22-05-7108	AE-7395-10BG	22-12-4102
AE-7395-11B	22-05-7118	AE-7395-11BG	22-12-4112
AE-7395-12B	22-05-7128	AE-7395-12BG	22-12-4122
AE-7395-13B	22-05-7138	AE-7395-13BG	22-12-4132
AE-7395-14B	22-05-7148	AE-7395-14BG	22-12-4142
AE-7395-15B	22-05-7158	AE-7395-15BG	22-12-4152
AE-7395-16B	22-05-7168	AE-7395-16BG	22-12-4162
AE-7395-17B	22-05-7178	AE-7395-17BG	22-12-4172
AE-7395-18B	22-05-7188	AE-7395-18BG	22-12-4182
AE-7395-19B	22-05-7198	AE-7395-19BG	22-12-4192
AE-7395-20B	22-05-7208	AE-7395-20BG	22-12-4202

NOTES:-

1. MATERIALS:
 WAFER: NYLON 6/6, UL 94, V-0, NATURAL COLOUR
 PIN: [0.64]/0.25 SQUARE HARD DRAWN BRASS
 FINISH: SEE CHART
2. PIN SOLDERABILITY PER MOLEX SPECIFICATION NUMBER 152
3. PIN PUSH OUT FORCE [0.907 KG]/2.0 LBS MIN.
4. PARTS TO BE FLAT WITHIN [0.13]/.005 IN/IN
5. WAFERS STACKABLE END TO END

ORIGINAL RELEASE EC NO: E2005-0071 DRAWN BY: JENNEY 2005/06/20 CHECKED BY: GMSWCENEY 2005/06/20 APPROVED BY: JENNEY 2005/07/07	QUALITY SYMBOLS ▽=0 ▽=0	GENERAL TOLERANCES (UNLESS SPECIFIED)		DIMENSION STYLE MM ONLY		SCALE 5:1	DESIGN UNITS METRIC	THIRD ANGLE PROJECTION		
			mm	INCH	DRAWN BY JENNEY	DATE 2005/05/13	WAFER, R/A FRICTION LOCK (2.54)/.100 CENTERS (0.64)/.025 SQ. PIN MOLEX INCORPORATED			
		4 PLACES ± .010	---	---	CHECKED BY DATE					
		3 PLACES ± .010	---	---	GMSWCENEY	2005/05/27				
		2 PLACES ± 0.25	---	---	APPROVED BY DATE	MOLEX INCORPORATED MATERIAL NO. _____ DOCUMENT NO. SD-7395-001 SHEET NO. 1 OF 1				
		1 PLACE ± 0.38	---	---	JENNEY				2005/05/27	
		ANGULAR ± 2°	---	---						
		DRAFT WHERE APPLICABLE MUST REMAIN WITHIN DIMENSIONS					SEE CHART			
		SIZE A					THIS DRAWING CONTAINS INFORMATION THAT IS PROPRIETARY TO MOLEX INCORPORATED AND SHOULD NOT BE USED WITHOUT WRITTEN PERMISSION			