

MAT'L NO.	ENG NO.
15-24-4745	A-8981-4V5-LF

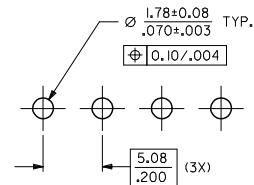
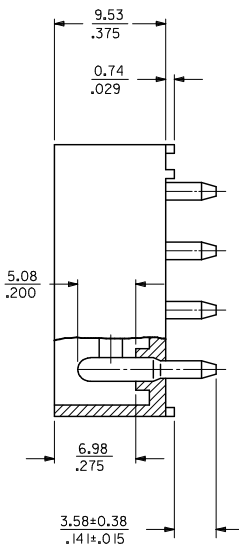
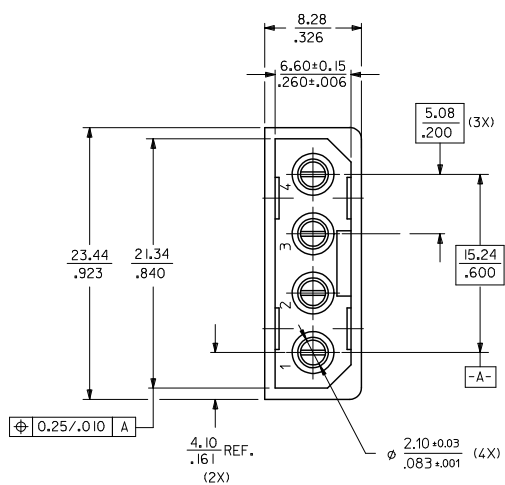

RECOMMENDED PCB HOLE LAYOUT

NOTES :

1. PLATING  
POSTPLATE 0.00254/.000100 MIN. TIN  
OVER 0.00127/.000050 MIN. NICKEL OVERALL.
2. PART TO MATE WITH HOUSING 8981-4P2  
AND TERMINAL 8980-3\*.
3. PRODUCT SPEC PS-8981-4V4/4R1-P APPLIES.
4. MATERIAL:  
HOUSING - PCT, GLASS FILLED, UL94V-0  
COLOR BLACK  
TERMINAL - PHOS BRONZE

<b>ADD CKT INDICATION</b> EEC NO: S2009-0836 DRAWNSKANG 2009/05/08 CHYKATSEE 2009/05/08 APPR:MLONG 2009/05/11	<b>QUALITY SYMBOLS</b> 	<b>GENERAL TOLERANCES (UNLESS SPECIFIED)</b>		<b>DIMENSION STYLE</b> MM/IN	<b>SCALE</b> NTS	<b>DESIGN UNITS</b> METRIC	<b>THIRD ANGLE PROJECTION</b>	
		4 PLACES ± --- ± ---	3 PLACES ± --- ± .008	DRAWN BY SKTOH DATE 1991/10/17	<b>TITLE</b> POWER CONNECTOR, 4 CKTS VERTICAL MOUNT			
		2 PLACES ± 0.20 ± ---	1 PLACE ± --- ± ---	CHECKED BY MLAI DATE 1991/10/17	<b>MATERIAL NO.</b> SEE TABLE			
		ANGULAR ± 3°		APPROVED BY RWONG DATE 1991/10/18	<b>DOCUMENT NO.</b> SD-8981-4V5			
DRAFT WHERE APPLICABLE MUST REMAIN WITHIN DIMENSIONS		SIZE A3		THIS DRAWING CONTAINS INFORMATION THAT IS PROPRIETARY TO MOLEX INCORPORATED AND SHOULD NOT BE USED WITHOUT WRITTEN PERMISSION				
<b>REVISIONS</b> REV 1		<b>DESCRIPTION</b> POWER CONNECTOR, 4 CKTS VERTICAL MOUNT		<b>SHEET NO.</b> 1 OF 1		<b>MOLEX INCORPORATED</b>		