

SECT.A-A

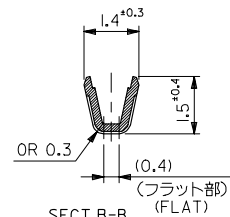

SECT.B-B

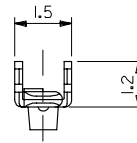
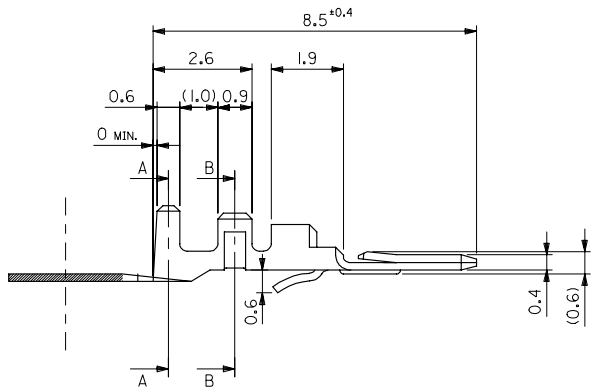

注記  
NOTES

1. 適合ハウジング : 51006  
APPLICABLE HOUSING : 51006
2. 嵌合相手 : 50013  
MATE WITH : 50013
3. ELV 及 RoHS 適合品  
ELV AND RoHS COMPLIANT.

材料 MATERIAL	リン青銅 銅メッキ (t=0.2) PHOS. BRO. PRE-TINNED (t=0.2)
仕上げ FINISH	—
適用導線範囲 WIRE RANGE	AWG#24 - #28
挿入径 INS. RANGE	φ0.9 - φ1.15

REVISED	EC NO. J2008-0075	2007/07/16
DRW: HIRABEI	CHKD: HARUYAMA	2007/07/17
APPR: NUKITA	2007/07/17	
DESCRIPTION		

GENERAL TOLERANCES (UNLESS SPECIFIED)	
10 UNDER	±0.2
10 OVER 30 UNDER	±0.25
30 OVER	±0.3
ANGULAR	±3 °
DRAFT WHERE APPLICABLE MUST REMAIN WITHIN DIMENSIONS	

DIMENSION STYLE MM ONLY	
DRAWN BY	T. YASUI
DATE	'95/08/21
CHECKED BY	H. HIRAMOTO
DATE	'95/08/22
APPROVED BY	M. FUKUSHIMA
DATE	'95/08/22
MATERIAL NO.	
SIZE	A3

SCALE	10:1
DESIGN UNITS	METRIC
THIRD ANGLE PROJECTION	☑
TITLE	
2.0 WIRE TO WIRE CONN. CRIMP PIN	
MOLEX INCORPORATED	
DOCUMENT NO.	SD-50012-001
SHEET NO.	1 OF 1