

13 12 11 10 9 8 7 6 5 4 3 2 1

70929	4	3	2	1
ENGINEERING NUMBER	ORDERING NUMBER	DIM. 'A'	PACKAGING SPEC.	
A-70929-1001	15-92-2251	.092±.012 (2.34±0.30)	PK-70873-0226	
A-70929-1003	70929-1003	.570±.012 (14.48±0.30)	PK-70873-640	

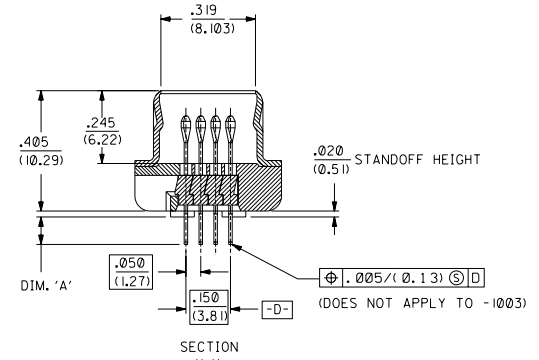
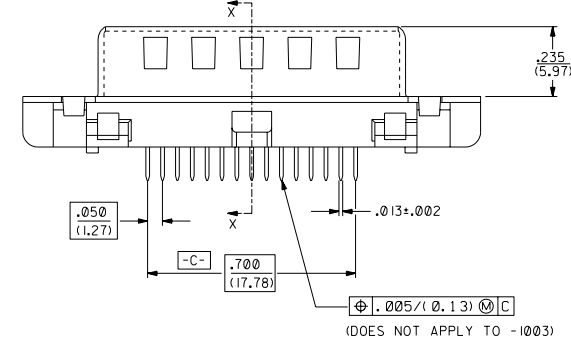
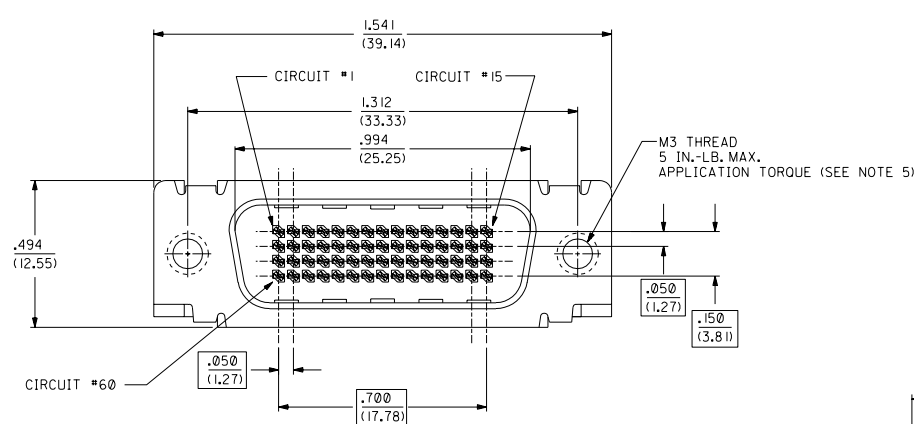

NOTES:
 1) MATERIALS:
 HOUSING: GLASS FILLED LCP (LIQUID CRYSTAL POLYMER), UL 94V-0, COLOR: BLACK.
 MOLDED STICK: GLASS FILLED LCP (LIQUID CRYSTAL POLYMER), UL 94V-0, COLOR: BLACK.
 MALE TERMINAL: PHOSPHOR BRONZE
 OUTER SHELL: DEEP DRAWN STEEL.
 2) PLATING :
 TERMINAL: .000030/(0.000762) MINIMUM GOLD IN SELECTIVE AREA;
 .000100/(0.00254) MINIMUM TIN IN SELECTIVE AREA;
 OVER NICKEL UNDERPLATE OVERALL.
 OUTER SHELL: .000100/(0.00254) MINIMUM BRIGHT NICKEL OVER COPPER FLASH (OPTIONAL).

NOTE FOR LEAD FREE CONVERSION:
 THE PRIMARY SHIPPING CARTON WILL BE LABELED *COMPLIANT TO ROHS DIRECTIVE 2002/95/EC AND ELV ANNEX II OF DIRECTIVE 2000/53/EC*. CARTONS WITHOUT THIS LABEL MAY CONTAIN PRODUCT WITH LEAD.

3) CONFORMS TO PRODUCT SPECIFICATION PS-70928.
 4) PARTS TO BE PACKAGED PER CHART.
 5) THREAD GAUGE MAY REQUIRE UP TO 1 IN.-LB. OF TORQUE DURING GAUGING PROCESS.

DIMENSIONS SHOWN METRIC/INCH		TOLERANCES ANGULAR ± 1/2°		REVISIONS	
INCH	METRIC	INCH	METRIC	DATE	BY
1 PLACE	---	1 PLACE	---	01/21/92	CD
2 PLACE	±	2 PLACE	±		
3 PLACE	±	3 PLACE	±		
DRAWING INFORMATION					
PART NO. 70929		ECN# 06P004/1998		DATE 01/21/92	
REV. 1		DMORGAN 04/04/14		BY CD	
REV. 2		OBSOLETE -1002		DATE 01/05/18	
REV. 3		JDT2001-1316		BY CD	
REV. 4		SCHMIDG 01/05/18		DATE 01/05/18	
REV. 5				BY CD	
REV. 6				DATE 01/05/18	
REV. 7				BY CD	
REV. 8				DATE 01/05/18	
REV. 9				BY CD	
REV. 10				DATE 01/05/18	
REV. 11				BY CD	
REV. 12				DATE 01/05/18	
REV. 13				BY CD	

13 12 11 10 9 8 7 6 5 4 3 2 1

