

SMD Inductors(Coils) For Power Line(Wound, Magnetic Shielded)

Conformity to RoHS Directive

SLF Series SLF6045

FEATURES

- Miniature size
Mount area: 6×6mm
Height: 4.8mm max.
- Generic use for portable DC to DC converter line.
- High magnetic shield construction should actualize high resolution for EMC protection.
- Available for automatic mounting in tape and reel package.
- The products do not contain lead and support lead-free soldering.

APPLICATIONS

LCD-TVs, PDP-TVs, LCD displays, DVD recorders, HDDs, DSCs, etc.

SHAPES AND DIMENSIONS

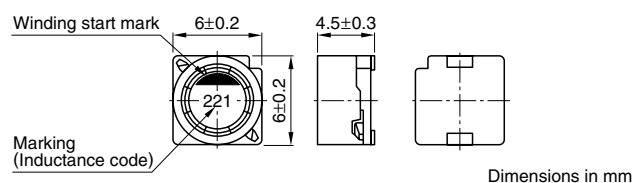

RECOMMENDED PC BOARD PATTERN

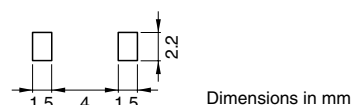

ELECTRICAL CHARACTERISTICS

Part No.	Inductance (μ H)	Inductance tolerance(%)	Test frequency (kHz)	DC resistance (m Ω)	Rated current(A)*	
					Based on inductance change	Based on temperature rise
SLF6045T-1R5N4R0-3PF	1.5	± 30	100	$16 \pm 30\%$	4	4.1
SLF6045T-2R2N3R3-3PF	2.2	± 30	100	$18 \pm 30\%$	3.3	3.8
SLF6045T-3R3N2R8-3PF	3.3	± 30	100	$21.5 \pm 30\%$	2.8	3.4
SLF6045T-4R7N2R4-3PF	4.7	± 30	100	$26.5 \pm 30\%$	2.4	3.2
SLF6045T-6R8N2R0-3PF	6.8	± 30	100	$33 \pm 30\%$	2	2.8
SLF6045T-100M1R6-3PF	10	± 20	100	$39 \pm 20\%$	1.6	2.7
SLF6045T-150M1R3-3PF	15	± 20	100	$59.5 \pm 20\%$	1.3	2.2
SLF6045T-220M1R1-3PF	22	± 20	100	$82 \pm 20\%$	1.1	1.8

* Rated current: Value obtained when current flows and the temperature has risen to 30°C or when DC current flows and the nominal value of inductance has fallen by 10%, whichever is smaller.

- Operating temperature range: -40 to +105°C (Including self-temperature rise)

• Conformity to RoHS Directive: This means that, in conformity with EU Directive 2002/95/EC, lead, cadmium, mercury, hexavalent chromium, and specific bromine-based flame retardants, PBB and PBDE, have not been used, except for exempted applications.

• All specifications are subject to change without notice.