

RECOMMENDED MOUNTING HOLE PATTERN FOR 1.78 MAX THICK P.C. BOARD COMPONENT SIDE SHOWN

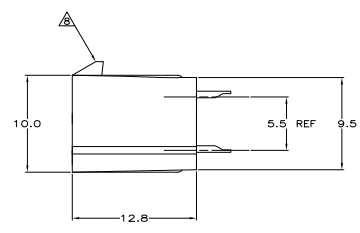

- ⚠ MATERIAL:  
HOUSING: NYLON, UL94V-0 (COLOR - NATURAL, COLOR OF PARTS MAY VARY).  
CONTACTS - 0.25 THK COPPER ALLOY.
- ⚠ CONTACT FINISH: 0.003 MIN THK TIN-LEAD OVER 0.00127 MIN THK NICKEL OVER ENTIRE CONTACT.
- ⚠ CONTACT FINISH: 0.00076 MIN THK GOLD PLATE ON PIN MATING SURFACE, 0.003 MIN THK TIN-LEAD PLATE ON SOLDER TAIL, ALL OVER 0.00127 MIN THK NICKEL BASE PLATE.
- 4. SOLDER TAIL MEETS AMP SOLDERABILITY SPECIFICATION 109-11-2.
- 5. MATES WITH SIMILARLY PLATED AMP-DUAC® POWER CONNECTOR RECEPTACLE HOUSINGS/SOCKET CONTACTS.
- ⚠ RIBS ON FOUR CORNERS OPTIONAL.
- ⚠ AMP LOGO AND MATERIAL ID MAY BE LOCATED ON EITHER LONG SIDE OF PART.
- ⚠ SIZE, SHAPE OR STYLE OF THIS FEATURE MAY VARY.
- ⚠ CONTACT FINISH: 0.003 MIN THK TIN OVER 0.00127 MIN THK NICKEL OVER ENTIRE CONTACT.
- ⚠ CONTACT FINISH: 0.00076 MIN THK GOLD PLATE ON PIN MATING SURFACE, 0.003 MIN THK TIN PLATE ON SOLDER TAIL, ALL OVER 0.00127 MIN THK NICKEL BASE PLATE.

SUPERSEDED BY 1-794487-2  
 SUPERSEDED BY 1-794487-1

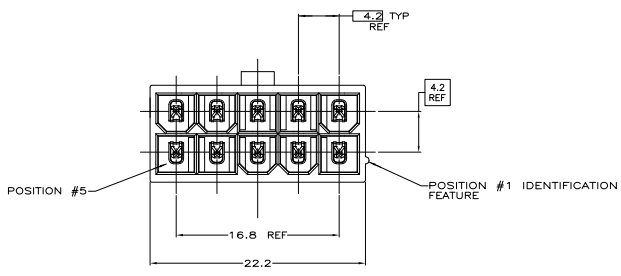

⚠	⚠	⚠	⚠	1-794487-2
⚠	⚠	⚠	⚠	1-794487-1
⚠	⚠	⚠	⚠	794487-2
⚠	⚠	⚠	⚠	794487-1

MATERIAL	CONTACT	FINISH	MATERIAL	HOUSING	COLOR	PART NO

THIS DRAWING IS A CONTROLLED DOCUMENT.

DESIGNED BY	DATE	APPROVED BY	DATE
108-1699			

ASSEMBLY, HEADER, VERTICAL, 10 POSITION, W/ DRAIN HOLES, 94V-0 (AMP-DUACTM)

SIZE: A1 00779 (C=794487)

CUSTOMER DRAWING: SEE TABLE