

LOC		DIST		REVISIONS			
P	LYR	DESCRIPTION	DATE	OWN	APPR	DATE	OWN
E		MATERIAL	09M17006	J. D.	Y. P.		
F		NOTES 5, 6 ADDED	18DEC2000	GW	PEG		

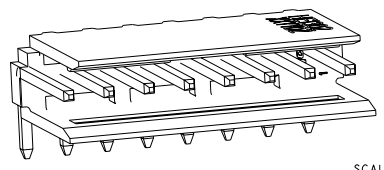

SCALE 6:1

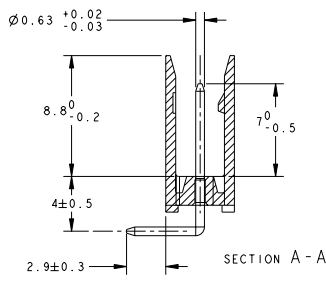
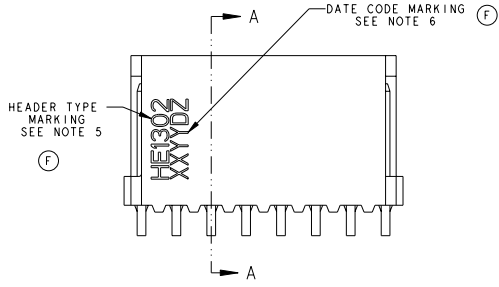
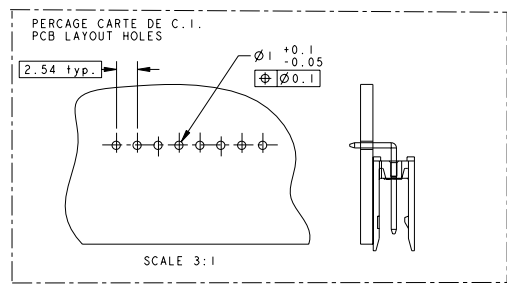
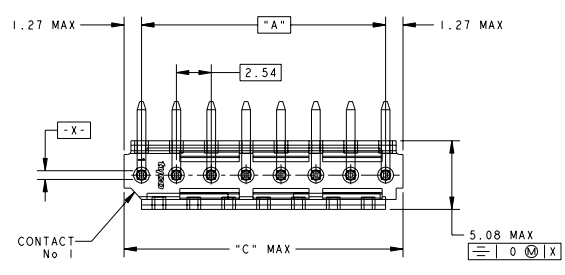

45.72	43.18	18	1-281699-8 *
43.18	40.64	17	1-281699-7
38.10	35.56	15	1-281699-5 *
30.48	27.94	12	1-281699-2 *
25.40	22.86	10	1-281699-0 *
20.32	17.78	8	0-281699-8 *
17.78	15.24	7	0-281699-7
15.24	12.70	6	0-281699-6 *
12.70	10.16	5	0-281699-5 *
10.16	7.62	4	0-281699-4 *
7.62	5.08	3	0-281699-3 *
5.08	2.54	2	0-281699-2
C	A	Nb DE POS	PART NUMBER
DIMENSIONS			

- NOTES:
- CES EMBASES SONT PREVUES POUR ETRE ACCOUPLEES AVEC LES FICHES "HE1402" SIMPLE RANGEE. (These headers are designed to be mated with "HE1402" connectors single row)
 - LES REFERENCES SUIVIES D'UN * SONT LES VERSIONS NORMALISEES SELON LA NORME CEI 603-B (The parts numbers followed by * are covered by the international standard IEC 603-8)
 - REVETEMENT DES CONTACTS: ETAIN PUR SUR NICKEL (Contacts plating: lead free tin over nickel)
 - MATIERE PLASTIQUE: TERMO-PLASTIQUE HAUTE TEMPERATURE, UL-94V0, COULEUR BLEUE (Plastic material: High temperature thermoplastic, UL-94V0, Blue color)
MATIERE DES CONTACTS: BRONZE PHOSPHOREUX (Contacts material: phosphor bronze)
 - MARQUAGE DU TYPE D'EMBASE (HE1302) A L'ENCRE NOIRE (Type marking (HE1302) with black ink)
 - MARQUAGE DE LA DATE A L'ENCRE NOIRE : (date code marking with black ink)

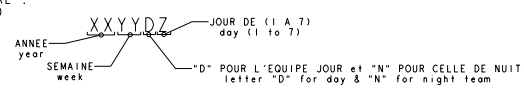

DIMENSIONS: mm TOLERANCES NON SPECIFIEES 1. DIMENSIONS DE HOUSSES 2. PLC (PREC: 0.3) 3. PLC (PREC: 0.2) 4. PLC (PREC: 0.1) ANGLES: 45°		DIMENSIONS: mm TOLERANCES NON SPECIFIEES 1. DIMENSIONS DE HOUSSES 2. PLC (PREC: 0.3) 3. PLC (PREC: 0.2) 4. PLC (PREC: 0.1) ANGLES: 45°	DIMENSIONS: mm TOLERANCES NON SPECIFIEES 1. DIMENSIONS DE HOUSSES 2. PLC (PREC: 0.3) 3. PLC (PREC: 0.2) 4. PLC (PREC: 0.1) ANGLES: 45°	DIMENSIONS: mm TOLERANCES NON SPECIFIEES 1. DIMENSIONS DE HOUSSES 2. PLC (PREC: 0.3) 3. PLC (PREC: 0.2) 4. PLC (PREC: 0.1) ANGLES: 45°	DIMENSIONS: mm TOLERANCES NON SPECIFIEES 1. DIMENSIONS DE HOUSSES 2. PLC (PREC: 0.3) 3. PLC (PREC: 0.2) 4. PLC (PREC: 0.1) ANGLES: 45°	DIMENSIONS: mm TOLERANCES NON SPECIFIEES 1. DIMENSIONS DE HOUSSES 2. PLC (PREC: 0.3) 3. PLC (PREC: 0.2) 4. PLC (PREC: 0.1) ANGLES: 45°	DIMENSIONS: mm TOLERANCES NON SPECIFIEES 1. DIMENSIONS DE HOUSSES 2. PLC (PREC: 0.3) 3. PLC (PREC: 0.2) 4. PLC (PREC: 0.1) ANGLES: 45°	DIMENSIONS: mm TOLERANCES NON SPECIFIEES 1. DIMENSIONS DE HOUSSES 2. PLC (PREC: 0.3) 3. PLC (PREC: 0.2) 4. PLC (PREC: 0.1) ANGLES: 45°	DIMENSIONS: mm TOLERANCES NON SPECIFIEES 1. DIMENSIONS DE HOUSSES 2. PLC (PREC: 0.3) 3. PLC (PREC: 0.2) 4. PLC (PREC: 0.1) ANGLES: 45°	DIMENSIONS: mm TOLERANCES NON SPECIFIEES 1. DIMENSIONS DE HOUSSES 2. PLC (PREC: 0.3) 3. PLC (PREC: 0.2) 4. PLC (PREC: 0.1) ANGLES: 45°
--	--	--	--	--	--	--	--	--	--	--