

1. TRUE POSITION TOLERANCE OF POST TIPS APPLIES WHEN HEADERS ARE HELD FLAT AGAINST POINTED CIRCUIT BOARD.

- △ OBSOLETE PART NUMBER
- △ .000100-.000200 BRIGHT TIN OVER .000050-.000100 NICKEL
- △ .000100-.000200 BRIGHT TIN-LEAD OVER .000050-.000100 NICKEL
- △ PRELIMINARY PART
- △ .000100-.000200 MATTE TIN OVER .000050 NICKEL
- △ OBSOLETE PARTS: OBSOLETE CIS STREAMLINING PER D.RENAUD/D.SINISI

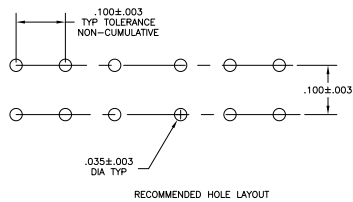
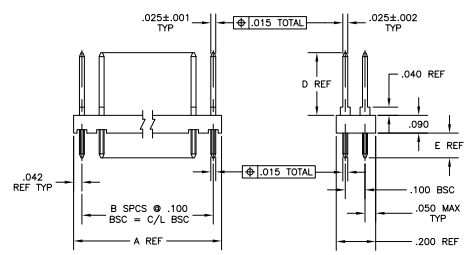

△	.125	.318	3,900	39	3,984	80	9-87543-0
△	.125	.318	2,400	24	2,484	50	7-87543-5
△	.125	.318	1,900	19	1,984	40	7-87543-0
△	.125	.318	1,600	16	1,684	34	6-87543-7
△	.125	.318	1,400	14	1,484	30	6-87543-5
△	.125	.318	1,200	12	1,284	26	6-87543-1
△	.125	.318	1,000	10	1,084	22	6-87543-1
△	.125	.318	900	9	.984	20	6-87543-0
△	.125	.318	700	7	.784	16	5-87543-8
△	.125	.318	600	6	.684	14	5-87543-7
△	.125	.318	500	5	.584	12	5-87543-6
△	.125	.318	400	4	.484	10	5-87543-5
△	.125	.318	300	3	.384	8	5-87543-4
△	.125	.318	200	2	.284	6	5-87543-3
△	.125	.318	-	-	.084	2	5-87543-1
△	.125	.318	500	5	.584	12	4-87543-3
△	.125	.318	4,100	41	4,184	80	4-87543-2
△	.125	.318	4,000	40	4,084	80	4-87543-1
△	.125	.318	3,900	39	3,984	80	4-87543-0
△	.125	.318	3,800	38	3,884	78	3-87543-9
△	.125	.318	3,700	37	3,784	76	3-87543-8
△	.125	.318	3,600	36	3,684	74	3-87543-7
△	.125	.318	3,500	35	3,584	72	3-87543-6
△	.125	.318	3,400	34	3,484	70	3-87543-5
△	.125	.318	3,300	33	3,384	68	3-87543-4
△	.125	.318	3,200	32	3,284	66	3-87543-3
△	.125	.318	3,100	31	3,184	64	3-87543-2
△	.125	.318	3,000	30	3,084	62	3-87543-1
△	.125	.318	2,900	29	2,984	60	3-87543-0
△	.125	.318	2,800	28	2,884	58	2-87543-9
△	.125	.318	2,700	27	2,784	56	2-87543-8
△	.125	.318	2,600	26	2,684	54	2-87543-7
△	.125	.318	2,500	25	2,584	52	2-87543-6
△	.125	.318	2,400	24	2,484	50	2-87543-5
△	.125	.318	2,300	23	2,384	48	2-87543-4
△	.125	.318	2,200	22	2,284	46	2-87543-3
△	.125	.318	2,100	21	2,184	44	2-87543-2
△	.125	.318	2,000	20	2,084	42	2-87543-1
△	.125	.318	1,900	19	1,984	40	2-87543-0
△	.125	.318	1,800	18	1,884	38	1-87543-9
△	.125	.318	1,700	17	1,784	36	1-87543-8
△	.125	.318	1,600	16	1,684	34	1-87543-7
△	.125	.318	1,500	15	1,584	32	1-87543-6
△	.125	.318	1,400	14	1,484	30	1-87543-5
△	.125	.318	1,300	13	1,384	28	1-87543-4
△	.125	.318	1,200	12	1,284	26	1-87543-3
△	.125	.318	1,100	11	1,184	24	1-87543-2
△	.125	.318	1,000	10	1,084	22	1-87543-1
△	.125	.318	900	9	.984	20	1-87543-0
△	.125	.318	800	8	.884	18	87543-9
△	.125	.318	700	7	.784	16	87543-8
△	.125	.318	600	6	.684	14	87543-7
△	.125	.318	500	5	.584	12	87543-6
△	.125	.318	400	4	.484	10	87543-5
△	.125	.318	300	3	.384	8	87543-4
△	.125	.318	200	2	.284	6	87543-3
△	.125	.318	100	1	.184	4	87543-2
△	.125	.318	-	-	.084	2	87543-1

FINISH	E	D	C	B	A	NO OF POSN	PART NUMBER
THIS DRAWING IS A CONTROLLED DOCUMENT.							
DRAWING NO. 100779				REV. 01			
DATE 08/11/03				BY 11111			
DRAWN BY 11111				CHECKED BY 11111			
DESIGNED BY 11111				APPROVED BY 11111			
TITLE ASSEMBLY, MOD II, HEADER, DOUBLE ROW, .100X.100				CUSTOMER DRAWING			
PART NO. 100779				REV. 01			
DATE 08/11/03				BY 11111			
DRAWN BY 11111				CHECKED BY 11111			
DESIGNED BY 11111				APPROVED BY 11111			