

DWG. NO. SD-5045-NA

8 7 6 5 4 3 2 1

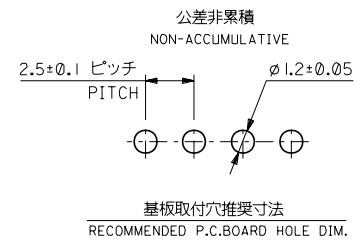
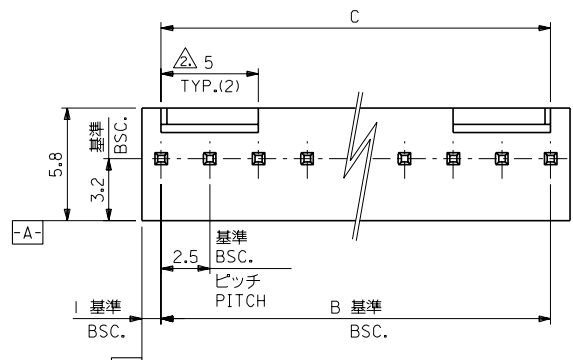

注) NOTE.

1. 材料
MATERIAL
ピン: □0.635×14.2 黄銅、銅下地錫メッキ
PIN: 0.635×14.2 BRASS TIN OVER COPPER PLATING.
ウェハー: ナイロン66, UL94V-0
WAFER: NYLON66, UL94V-0
△6極以上に適用
TO BE APPLIED FOR 6 CKT. AND MORE THEN 6 CKT.
3. 5極以下はロック部スリットなし
NO SLIT IS PROVIDED FOR 5 CKT. AND LESS THAN 5 CKT.

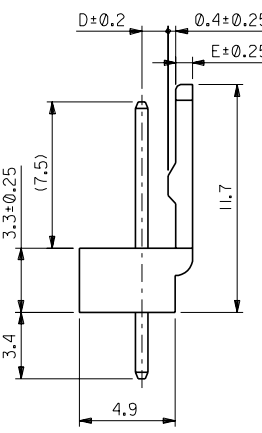
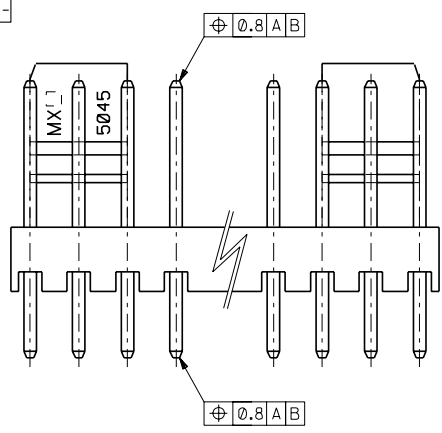

| L35 | 0.85 | 47.5 | 47.5 | 22-04-120I | 5045-20A | 20 |
|-----|------|------|------|------------|----------|---------|
| | | 45 | 45 | -119I | -19A | 19 |
| | | 42.5 | 42.5 | -118I | -18A | 18 |
| | | 40 | 40 | -117I | -17A | 17 |
| | | 37.5 | 37.5 | -116I | -16A | 16 |
| | | 35 | 35 | -115I | -15A | 15 |
| | | 32.5 | 32.5 | -114I | -14A | 14 |
| | | 30 | 30 | -113I | -13A | 13 |
| | | 27.5 | 27.5 | -112I | -12A | 12 |
| | | 25 | 25 | -111I | -11A | 11 |
| | | 22.5 | 22.5 | -110I | -10A | 10 |
| | | 20 | 20 | -109I | -09A | 9 |
| | | 17.5 | 17.5 | -108I | -08A | 8 |
| | | 15 | 15 | -107I | -07A | 7 |
| | | 12.5 | 12.5 | -106I | -06A | 6 |
| | | 10 | 10 | -105I | -05A | 5 |
| L35 | 0.85 | 7.5 | 7.5 | -104I | -04A | 4 |
| L2 | 1 | 5 | 5 | -103I | -03A | 3 |
| L2 | 1 | 2.5 | 2.5 | 22-04-102I | 5045-02A | 2 |
| D | E | C | B | EDP.NO. | ENG.NO. | 極数 CKT. |

DO NOT SCALE DRAWING

REDRAWN

JC2000-0023

DRWN: K.KOHAMA

CHK: T.YAMAGUCHI

APPR: M.FUKUSHIMA

DESCRIPTION

WIRE RANGE

INS. RANGE

MATERIAL

注記参照

SEE NOTES

FINISH

仕上げ

WIRE RANGE

通用電線範囲

INS. RANGE

被覆外径

GENERAL TOLERANCES:

(UNLESS SPECIFIED)

一般公差

10 UNDER 未滿

10 OVER 以上

30 UNDER 未滿

30 OVER 以上

ANGLE 角度

+3°

SCALE

5:1

DESIGN UNITS

mm

INCH

PROJECTION

ANGLE

PROJECTION

mm

INCH

mm

ONLY

TITLE:

KK 2.5 WAFER ASS'Y
WITH LOCK

MATERIAL NO.

5045-***A

DRAWING NO.

SD-5045-NA

SHEET NO.

1

INCORPORATED AND SHOULD NOT BE USED WITHOUT WRITTEN PERMISSION.

EN-02J(097) MXJ-54

8 7 6 5 4 3 2 1