

REV	DATE	DESCRIPTION	BY	CHK
CM	0			
E	2006-06-01	3135		

- △ MATERIAL: NYLON, UL94V-0 (COLOR - NATURAL, COLOR OF PARTS MAY VARY).
- △ CONTACTS: 0.25 THK COPPER ALLOY.
- △ CONTACT FINISH: 0.003 MIN THK TIN-LEAD OVER 0.00127 MIN THK NICKEL OVER ENTIRE CONTACT.
- △ CONTACT FINISH: 0.00076 MIN THK GOLD PLATE ON PIN MATING SURFACE, 0.003 MIN THK TIN-LEAD PLATE ON SOLDER TAIL, ALL OVER 0.00127 MIN THK NICKEL BASE PLATE.
- 4. SOLDER TAIL MEETS AMP SOLDERABILITY SPECIFICATION 109-11-2.
- 5. MATES WITH SIMILARLY PLATED AMP-DUAC™ POWER CONNECTOR RECEPTACLE HOUSINGS/SOCKET CONTACTS
- △ RIBS ON FOUR CORNERS OPTIONAL.
- △ AMP LOGO AND MATERIAL ID MAY BE LOCATED ON EITHER LONG SIDE OF PART.
- △ SIZE, SHAPE OR STYLE OF THIS FEATURE MAY VARY.
- △ CONTACT FINISH: 0.003 MIN THK TIN OVER 0.00127 MIN THK NICKEL OVER ENTIRE CONTACT.
- △ CONTACT FINISH: 0.00076 MIN THK GOLD PLATE ON PIN MATING SURFACE, 0.003 MIN THK TIN PLATE ON SOLDER TAIL, ALL OVER 0.00127 MIN THK NICKEL BASE PLATE.

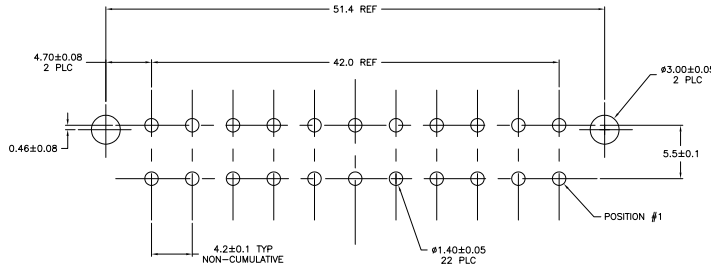

COMPONENT SIDE SHOWN
 RECOMMENDED MOUNTING HOLE PATTERN
 FOR 1.78 MAX THICK P.C. BOARD

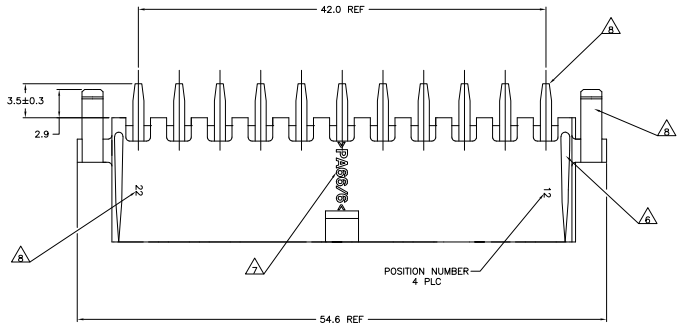
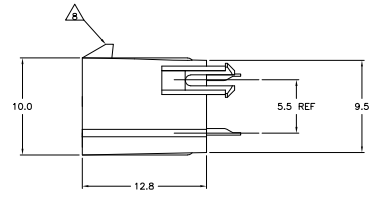
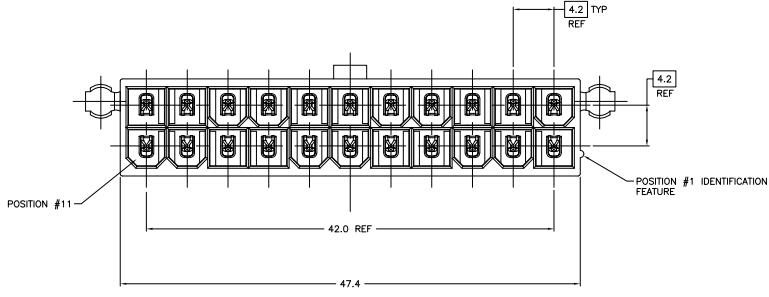

REVISION	DESCRIPTION	DATE	BY	CHK
1	1-794471-2			
2	1-794471-1			
3	794471-2			
4	794471-1			

MATERIAL	FINISH	MATERIAL	HOUSING COLOR	PART NO.
△	△	△	△	1-794471-2
△	△	△	△	1-794471-1
△	△	△	△	794471-2
△	△	△	△	794471-1

CONTACT		HOUSING	
MATERIAL	FINISH	MATERIAL	COLOR
△	△	△	△

THIS DRAWING IS A CONTROLLED DOCUMENT		TYS ELECTRONICS CORPORATION	
REVISION	DATE	DESCRIPTION	BY
1	10B-1699	ASSEMBLY, HEADER, VERTICAL, 22 POSITION, W/PEGS, W/DRAIN HOLES, 94V-0 AMP-DUAC	

SIZE: A1 DATE: 100779 CUSTOMER DRAWING: 794471