

This document is the property of Amphenol Corporation and is delivered on the express condition that it is not to be distributed, reproduced or used in whole or in part, for manufacturing of parts by anyone other than Amphenol Corporation without the prior consent in writing in printed or electronic form or to use any information in this document.

ORDERING INFORMATION

E 842 - 816 - XX XX - X XX X

Date code
 Nil - No date code
 E - Date code printed Δ

No. of contact

Body & pin configuration
 (Refer to Table III)

Lock & Eject (L&E) and mounting stud options

- 0 - no L&E, no stud
- 1 - short L&E, no stud
- 2 - short L&E, short stud
- 3 - short L&E, long stud
- 4 - long L&E, no stud
- 5 - long L&E, short stud
- 6 - long L&E, long stud
- F - long L&E, M2.5 stud

Nil - standard
 S - standard with polarizing key slot for size 10 Δ

Plating
 AA - gold flash duplex
 19 - 15u" gold plated duplex
 35 - 30u" gold plated duplex

REVISIONS			
SYM	EDN	DESCRIPTION	DATE
		SEE SHEET 1	

Notes:

- Connectors purchased under this drawing will mate with MIL-C-83503/7B socket connector with strain relief or without strain relief and Amphenol's 812 connector.
- This assembly is designed to meet requirements of MIL-C-83503.
- Δ The polarizing key slot on this end does not exist on size 10 and 14.
- Δ Prefix "E" only applies to the four-sided version & polarizing key slot is available for all size including size 10.
- Δ Suffix "S" only applies to the size 10 since the polarizing key slot is absent from the standard size 10.
- This connector is both UL and CSA approved.
- Refer to Amphenol S-816-001 for product specification.
- MATERIAL SHOULD BE FULFILLED AMPHENOL SPEC#SSN001.

Table III

Standard product - four side grey	Non-standard product - three side grey (specific quantity required)	K
30 - straight solder tail, for 0.062" [1.6 mm] PCB	20 - obsoleted	0.109 \pm 0.002 [2.61 \pm 0.34] coined tail
31 - straight solder tail, for 0.125" [3.2 mm] PCB	21 - obsoleted	0.171 \pm 0.002 [4.14 \pm 0.36] coined tail
32 - right angle solder tail, for 0.062" [1.6 mm] PCB	22 - obsoleted	0.109 \pm 0.002 [2.61 \pm 0.34] coined tail
33 - right angle solder tail, for 0.125" [3.2 mm] PCB	23 - obsoleted	0.171 \pm 0.002 [4.14 \pm 0.36] coined tail
37 - straight wire wrap tail	27 - obsoleted	0.61 \pm 0.015 [15.49 \pm 0.38] square tail
39 - right angle wire wrap tail	29 - obsoleted	0.61 \pm 0.015 [15.49 \pm 0.38] square tail

Table IV

Size	A	B	C	D	E	F
10	1.26 [32.07]	1.10 [27.94]	0.860 [21.84]	0.708 [17.98]	0.400 [10.16]	4
14	1.76 [37.08]	1.30 [33.02]	1.060 [26.92]	0.908 [23.06]	0.600 [15.24]	6
16	1.56 [39.62]	1.40 [35.56]	1.160 [29.46]	1.008 [25.60]	0.700 [17.78]	7
20	1.76 [44.70]	1.60 [40.64]	1.360 [34.54]	1.208 [30.68]	0.900 [22.86]	9
26	2.06 [52.32]	1.90 [48.26]	1.660 [42.16]	1.508 [38.30]	1.200 [30.40]	12
30	2.26 [57.40]	2.10 [53.34]	1.860 [47.24]	1.708 [43.38]	1.400 [35.56]	14
34	2.46 [62.48]	2.30 [58.42]	2.060 [52.32]	1.908 [48.46]	1.600 [40.64]	16
40	2.76 [70.10]	2.60 [66.04]	2.360 [59.94]	2.208 [56.08]	1.900 [48.26]	19
50	3.26 [82.80]	3.10 [78.94]	2.860 [72.64]	2.708 [68.78]	2.400 [60.96]	24
60	3.76 [95.50]	3.60 [91.44]	3.360 [85.34]	3.208 [81.48]	2.900 [73.66]	29
64	3.96 [100.58]	3.80 [96.52]	3.560 [90.42]	3.408 [86.60]	3.100 [78.74]	31

Recommended PCB layout

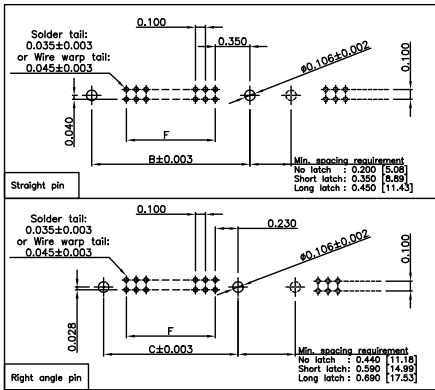

Customer Drawing

UNLESS OTHERWISE SPECIFIED TOLERANCES U.S. METRIC	APPROVAL	DATE	Amphenol
	DRAWN ALEX/LEE	07/18/05	
.X +/- .020 0.51	CHECKED TSUI	07/18/05	TITLE 816 Protected Header
.XX +/- .010 0.25	CHECKED		
.XXX +/- .006 0.15	DRAWING FILE: \DRAWING\816\816L.DWG		SIZE DRAWING NO. A3 C816-XXXX-XXX
FRACTIONS +/-	ANGLE OF PROJECTION		
ANGLES +/- 3.0° 3.0°	REMOVE SHARP EDGES		SCALE NONE SHEET 2 OF 2
DIMENSIONS		REV. T	
U.S. INCHES	ANGLE OF PROJECTION		
METRIC MM	ANGLE OF PROJECTION		

This document is the property of Amphenol Corporation and is delivered on the express condition that it is not to be distributed, reproduced, or used, in whole or in part, for manufacture of parts by anyone other than Amphenol Corporation without the prior consent of that the right is granted in drawings or to use any information in this document.

REVISIONS				
SYM	ECH	DESCRIPTION	DATE	APPROVED
Q	HK1421	RELEASE TO CUSTOMER	06/12/97	NELSON
R	HK1513	"**" TAIL SIZE MODIFIED	06/01/98	Michael Tuff
S	HK2043	Revise L&E options/delete three side option	8/24/01	Michael P
T	HK3437	UPDATE DRAWING TO COMPLY WITH RoHS	07/18/05	Michael P

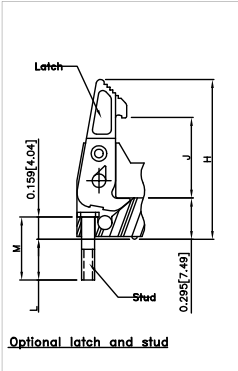
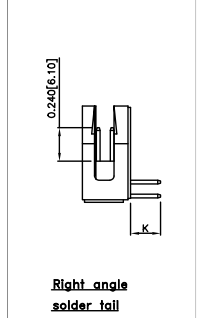
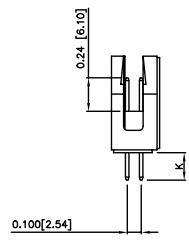
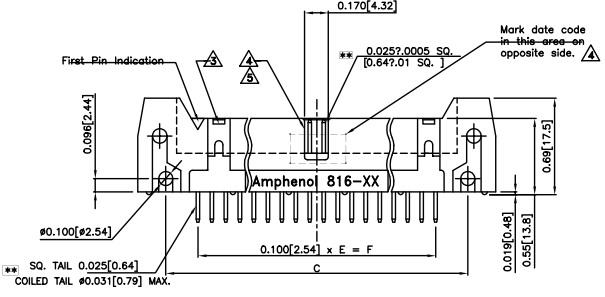
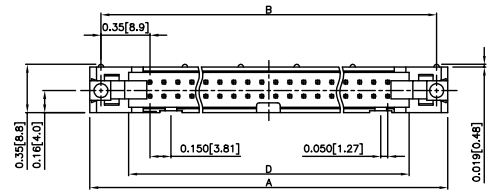

Amphenol 816-XX

** SQ. TAIL 0.025(0.64) COILED TAIL #0.031(0.79) MAX.

** 0.0257,0005 SQ. (0.649,01 SQ.)

Size 14 P/N: X842-816-14XX-XXX

Size 34 or above P/N: X842-816-XXXX-XXX

Size 10 with CPK slot P/N: 842-816-10XX-XXXX, or P/N: E842-816-10XX-XXX with date code

Size 20 P/N: X842-816-20XX-XXX

Size 10 without CPK slot P/N: 842-816-10XX-XXX

Size 16 P/N: X842-816-16XX-XXX

Customer Drawing

Table I

Latch & Eject	J	H
Short: for use with non strain relief socket	0.425 [10.80]	1.015 [25.78]
Long for use with strain relief socket	0.575 [14.61]	1.135 [28.83]

Table II

Stud	L	M
Short stud 2-56	0.29 [7.4]	0.45 [11.43]
Long stud 2-56	0.36 [9.1]	0.52 [13.21]
Stud M2.5	0.18 [4.6]	0.34 [8.6]

Note: unit in inch [mm]

UNLESS OTHERWISE SPECIFIED TOLERANCES		APPROVAL	DATE
.X	+/- .020	DRAWN ALEX LEE	07/18/05
.XX	+/- .010	CHECKED TSH	07/18/05
.XXX	+/- .005		
FRACTIONS	+/- .005		
ANGLES	+/- 2.5°		
FOR MATERIALS AND FINISHES SEE NOTES		DRAWING FILE: \DRAWING\816\C816LDWG	
REMOVE SHARP EDGES		ANGLE OF PROJECTION	
DIMENSIONS			
U.S.	INCHES	SIZE DRAWING NO.	
METRIC	MM	A3 C816-XXXX-XXX	
		SCALE	NONE
		SHEET	1 OF 2

Amphenol

TITLE

816 Protected Header

REV. T