

13 12 11 10 9 8 7 6 5 4 3 2 1

OPTIONAL PICK AND PLACE CAP  
SEE NOTES 4 & 9.

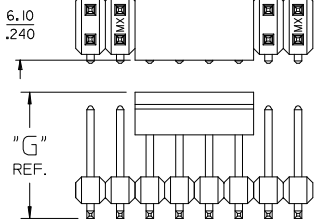

DIM. "M"	DIM. "G"
6.10 .240	10.67 .420
8.13 .320	12.70 .500

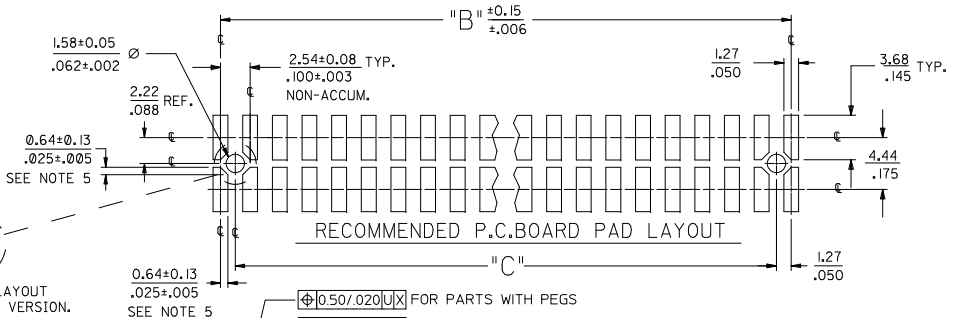

P.C. BOARD PAD LAYOUT AT ENDS FOR NO PEG VERSION.

RECOMMENDED P.C. BOARD PAD LAYOUT

PEG OPTIONS

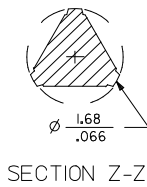
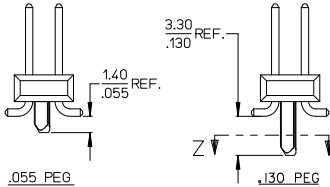

NOTES:

- MATERIALS: INSULATOR: GLASS FILLED LIQUID CRYSTAL POLYMER (LCP), UL94 V-0, COLOR: BLACK  
TERMINAL: COPPER ALLOY
- FINISH:  
59 TIN - 0.00150/0.00059 MINIMUM BRIGHT TIN OVER NICKEL OVERALL.  
150 TIN - 0.00381/0.00150 MINIMUM BRIGHT TIN OVER NICKEL OVERALL.  
15 GOLD - 0.00038/0.00015 MINIMUM GOLD IN SELECT AREA OVER 0.00191/0.00075 MINIMUM TIN IN SELECT AREA OVER NICKEL OVERALL.  
30 GOLD - 0.00076/0.00030 MINIMUM GOLD IN SELECT AREA OVER 0.00191/0.00075 MINIMUM TIN IN SELECT AREA OVER NICKEL OVERALL.  
50 GOLD - 0.00127/0.00050 MINIMUM GOLD IN SELECT AREA OVER 0.00254/0.00100 MINIMUM TIN IN SELECT AREA OVER NICKEL OVERALL.  
\* THE PRIMARY SHIPPING CARTON WILL BE LABELED "COMPLIANT TO RoHS DIRECTIVE 2002/95/EC AND ELV ANNEX II OF DIRECTIVE 2000/53/EC". CARTONS WITHOUT THIS LABEL MAY CONTAIN PRODUCT WITH LEAD.
- PART TO CONFORM TO PS-71308.
- PACKAGING (SEE CHARTS):  
BULK: PER PK-70873-0353  
TUBES: PER PK-70873-0041  
71308-82\*\* IN TUBES: PER PK-70873-042.  
TUBES W/ VAC CAPS: PER PK-70873-0691  
TAPE AND REEL W/ VAC CAPS: PER PK-70873-0805.  
SEE SHEET 3 FOR TAPE & REEL PRODUCT WITH SHALLOW POCKET REQUIREMENTS.
- TYP. DIMENSIONS FOR LANDS SURROUNDING HOLES FOR RETENTION PEGS.
- PIN SOLERABILITY PER MOLEX SPEC, ES-152.
- SEE SHEETS 2-5 FOR CHARTED DIMS., PART/EDP NO'S, AND VOIDED CIRCUITS.
- PIN PUSHOUT FORCE: 3 LBS. MINIMUM.
- PICK-N-PLACE CAPS WILL BE PLACED SO THAT VACUUM PICK UP AREA WILL BE IN CENTER OF PART.
- COPLANARITY FOR CIRCUIT SIZES UP TO 40 IS 0.15 MM/0.06 INCH. FOR CIRCUIT SIZES 42 AND LARGER, CONTACT MOLEX SALES DEPARTMENT.
- THIS PART CONFORMS TO CLASS B REQUIREMENTS OF COSMETIC SPECIFICATION PS-45499-002.

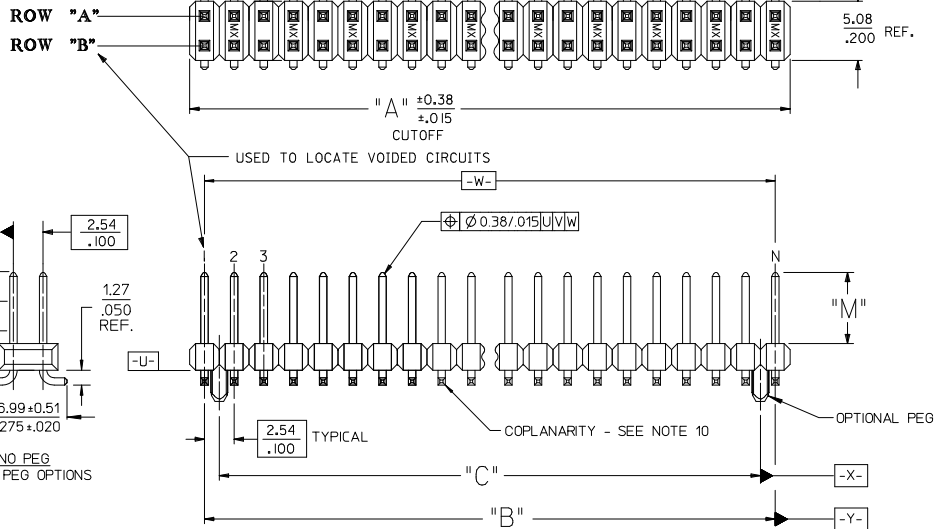
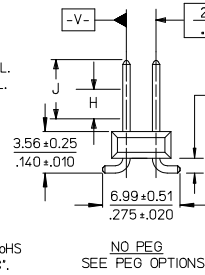

ADD PEG DIMENSIONS	QUALITY SYMBOLS	GENERAL TOLERANCES (UNLESS SPECIFIED)		DIMENSION STYLE		SCALE	DESIGN UNITS	THIRD ANGLE PROJECTION
		mm	INCH	MM/IN	MM/IN			
EC NO: UCP2011-1028 DRAWN: JUPPER 2010/12/14 CHKD: JEBELL APPR: FSMITH REV: 2010/12/17	DESCRIPTION	4 PLACES	±---	±---	KMS	DATE	1999/10/15	TITLE SALES ASSY INSULATOR DUAL ROW SMT W/BREAK-OFF .025SQ PIN GULLWING .100 MOLEX INCORPORATED
		3 PLACES	±---	±.005	KMS	DATE	1999/10/15	
		2 PLACES	±.13	±.010	KMS	DATE	1999/10/15	
		1 PLACE	±0.25	±---	KMS	DATE	1999/10/15	
		ANGULAR ±1/2°						
		DRAFT WHERE APPLICABLE MUST REMAIN WITHIN DIMENSIONS		SEE TABLES		MATERIAL NO.	DOCUMENT NO.	SHEET NO.
							SD-71308-001	1 OF 6

12 11 10 9 8 7 6 5 4 3 2 1

		13		12		11		10		9		8		7		6		5		4		3		2		1			
J	CKTS	PACKAGING SEE NOTE 4 SHT 1		4-6 CKT		BULK		TAPE-N-REEL W/ VAC CAPS		N/A		BULK		TAPE-N-REEL W/ VAC CAPS		N/A		BULK		TAPE-N-REEL W/ VAC CAPS		N/A		BULK		BULK			
				8-100 CKT		TUBES		TAPE-N-REEL W/ VAC CAPS		TUBES W/ VAC CAPS		TUBES		TAPE-N-REEL W/ VAC CAPS		TUBES W/ VAC CAPS		TUBES		TAPE-N-REEL W/ VAC CAPS		TUBES W/ VAC CAPS		TUBES		TUBES			
		DIM. M±0.25 MM						6.10 (.240)						6.10 (.240)						6.10 (.240)						8.13 (.320)		8.13 (.320)	
		PLATING						150 TIN						15 GOLD						30 GOLD						15 GOLD		30 GOLD	
		DIM. H						2.54 (.100)						2.54 (.100)						2.54 (.100)						4.57 (.180)		4.57 (.180)	
		DIM. J						5.08 (.200)						5.08 (.200)						5.08 (.200)						7.11 (.280)		7.11 (.280)	
I	MM	IN	DIM. A		DIM. B		EDP NUMBER		EDP NUMBER		EDP NUMBER		EDP NUMBER		EDP NUMBER		EDP NUMBER		EDP NUMBER		EDP NUMBER		EDP NUMBER		EDP NUMBER		EDP NUMBER		CKTS
			MM	IN	MM	IN	MM	IN	MM	IN	MM	IN	MM	IN	MM	IN	MM	IN	MM	IN	MM	IN	MM	IN	MM	IN	MM	IN	
04	5.08	.200	2.54	.100	015-91-2040	015-91-6040	N/A	015-91-0040	015-91-6042	N/A	015-91-3040	015-91-6043	N/A	015-91-0048	015-91-5049	04													
06	7.62	.300	5.08	.200	015-91-2060	015-91-6060	N/A	015-91-0060	015-91-6062	N/A	015-91-3060	015-91-6063	N/A	015-91-0068	015-91-5069	06													
08	10.16	.400	7.62	.300	015-91-2080	015-91-6080	015-91-3087	015-91-0080	015-91-6082	015-91-3086	015-91-3080	015-91-6083	015-91-3088	015-91-0088	015-91-5089	08													
10	12.70	.500	10.16	.400	015-91-2100	015-91-6100	015-91-3107	015-91-0100	015-91-6102	015-91-3106	015-91-3100	015-91-6103	015-91-3108	015-91-0108	015-91-5109	10													
12	15.24	.600	12.70	.500	015-91-2120	015-91-6120	015-91-3127	015-91-0120	015-91-6122	015-91-3126	015-91-3120	015-91-6123	015-91-3128	015-91-0128	015-91-5129	12													
14	17.78	.700	15.24	.600	015-91-2140	015-91-6140	015-91-3147	015-91-0140	015-91-6142	015-91-3146	015-91-3140	015-91-6143	015-91-3148	015-91-0148	015-91-5149	14													
16	20.32	.800	17.78	.700	015-91-2160	015-91-6160	015-91-3167	015-91-0160	015-91-6162	015-91-3166	015-91-3160	015-91-6163	015-91-3168	015-91-0168	015-91-5169	16													
18	22.86	.900	20.32	.800	015-91-2180					015-91-3186	015-91-3180		015-91-3188	015-91-0188	015-91-5189	18													
20	25.40	1.000	22.86	.900	015-91-2200	015-91-6200	015-91-3207	015-91-0200	015-91-6202	015-91-3206	015-91-3200	015-91-6203	015-91-3208	015-91-0208	015-91-5209	20													
22	27.94	1.100	25.40	1.000	015-91-2220					015-91-3226	015-91-3220		015-91-3228	015-91-0228	015-91-5229	22													
24	30.48	1.200	27.94	1.100	015-91-2240					015-91-3246	015-91-3240		015-91-3248	015-91-0248	015-91-5249	24													
26	33.02	1.300	30.48	1.200	015-91-2260	015-91-6260	015-91-3267	015-91-0260	015-91-6262	015-91-3266	015-91-3260		015-91-3268	015-91-0268	015-91-5269	26													
28	35.56	1.400	33.02	1.300	015-91-2280					015-91-3286	015-91-3280		015-91-3288	015-91-0288	015-91-5289	28													
30	38.10	1.500	35.56	1.400	015-91-2300					015-91-3306	015-91-3300		015-91-3308	015-91-0308	015-91-5309	30													
32	40.64	1.600	38.10	1.500	015-91-2320					015-91-3326	015-91-3320		015-91-3328	015-91-0328	015-91-5329	32													
34	43.18	1.700	40.64	1.600	015-91-2340					015-91-3346	015-91-3340		015-91-3348	015-91-0348	015-91-5349	34													
36	45.72	1.800	43.18	1.700	015-91-2360					015-91-3366	015-91-3360		015-91-3368	015-91-0368	015-91-5369	36													
38	48.26	1.900	45.72	1.800	015-91-2380					015-91-3386	015-91-3380		015-91-3388	015-91-0388	015-91-5389	38													
40	50.80	2.000	48.26	1.900	015-91-2400	015-91-6400	015-91-3407	015-91-0400	015-91-6402	015-91-3406	015-91-3400	015-91-6403	015-91-3408	015-91-0408	015-91-5409	40													
42	53.34	2.100	50.80	2.000	015-91-2420					015-91-3426	015-91-3420		015-91-3428	015-91-0428	015-91-5429	42													
44	55.88	2.200	53.34	2.100	015-91-2440					015-91-3446	015-91-3440		015-91-3448	015-91-0448	015-91-5449	44													
46	58.42	2.300	55.88	2.200	015-91-2460					015-91-3466	015-91-3460		015-91-3468	015-91-0468	015-91-5469	46													
48	60.96	2.400	58.42	2.300	015-91-2480					015-91-3486	015-91-3480		015-91-3488	015-91-0488	015-91-5489	48													
50	63.50	2.500	60.96	2.400	015-91-2500	015-91-6500	015-91-3507	015-91-0500	015-91-6502	015-91-3506	015-91-3500	015-91-6503	015-91-3508	015-91-0508	015-91-5509	50													
52	66.04	2.600	63.50	2.500	015-91-2520					015-91-3526	015-91-3520		015-91-3528	015-91-0528	015-91-5529	52													
54	68.58	2.700	66.04	2.600	015-91-2540					015-91-3546	015-91-3540		015-91-3548	015-91-0548	015-91-5549	54													
56	71.12	2.800	68.58	2.700	015-91-2560					015-91-3566	015-91-3560		015-91-3568	015-91-0568	015-91-5569	56													
58	73.66	2.900	71.12	2.800	015-91-2580					015-91-3586	015-91-3580		015-91-3588	015-91-0588	015-91-5589	58													
60	76.20	3.000	73.66	2.900	015-91-2600					015-91-3606	015-91-3600		015-91-3608	015-91-0608	015-91-5609	60													
62	78.74	3.100	76.20	3.000	015-91-2620					015-91-3626	015-91-3620		015-91-3628	015-91-0628	015-91-5629	62													
64	81.28	3.200	78.74	3.100	015-91-2640					015-91-3646	015-91-3640		015-91-3648	015-91-0648	015-91-5649	64													
66	83.82	3.300	81.28	3.200	015-91-2660					015-91-3666	015-91-3660		015-91-3668	015-91-0668	015-91-5669	66													
68	86.36	3.400	83.82	3.300	015-91-2680					015-91-3686	015-91-3680		015-91-3688	015-91-0688	015-91-5689	68													
70	88.90	3.500	86.36	3.400	015-91-2700					015-91-3706	015-91-3700		015-91-3708	015-91-0708	015-91-5709	70													
72	91.44	3.600	88.90	3.500	015-91-2720					015-91-3726	015-91-3720		015-91-3728	015-91-0728	015-91-5729	72													
74	93.98	3.700	91.44	3.600	015-91-2740					015-91-3746	015-91-3740		015-91-3748	015-91-0748	015-91-5749	74													
76	96.52	3.800	93.98	3.700	015-91-2760					015-91-3766	015-91-3760		015-91-3768	015-91-0768	015-91-5769	76													
78	99.06	3.900	96.52	3.800	015-91-2780					015-91-3786	015-91-3780		015-91-3788	015-91-0788	015-91-5789	78													
80	101.60	4.000	99.06	3.900	015-91-2800					015-91-3806	015-91-3800		015-91-3808	015-91-0808	015-91-5809	80													
82	104.14	4.100	101.60	4.000	71308-0082					71308-0582	71308-0282		71308-0682	71308-1182	71308-1282	82													
84	106.68	4.200	104.14	4.100	71308-0084					71308-0584	71308-0284		71308-0684	71308-1184	71308-1284	84													
86	109.22	4.300	106.68	4.200	71308-0086					71308-0586	71308-0286		71308-0686	71308-1186	71308-1286	86													
88	111.76	4.400	109.22	4.300	71308-0088					71308-0588	71308-0288		71308-0688	71308-1188	71308-1288	88													
90	114.30	4.500	111.76	4.400	71308-0090					71308-0590	71308-0290		71308-0690	71308-1190	71308-1290	90													
92	116.84	4.600	114.30	4.500	71308-0092					71308-0592	71308-0292		71308-0692	71308-1192	71308-1292	92													
94	119.38	4.700	116.84	4.600	71308-0094					71308-0594	71308-0294		71308-0694	71308-1194	71308-1294	94													
96	121.92	4.800	119.38	4.700	71308-0096					71308-0596	71308-0296		71308-0696	71308-1196	71308-1296	96													
98	124.46	4.900	121.92	4.800	71308-0098					71308-0598	71308-0298		71308-0698	71308-1198	71308-1298	98													
100	127.00	5.000	124.46	4.900	71308-0101					71308-0600	71308-0300		71308-0700	71308-1200	71308-1300	100													

NO PEG VERSION  
(SEE ALSO SHEET 3)

SEE SHEET 1 EC NO. 1 (EP2011-1028) DRW:KIPER 2010/12/14 CHKD:JELL APPR:SMITH 2010/12/17 REV DESCRIPTION	QUALITY SYMBOLS	GENERAL TOLERANCES (UNLESS SPECIFIED)	DIMENSION STYLE	SCALE	DESIGN UNITS	THIRD ANGLE PROJECTION	
	$\nabla=0$ $\nabla=0$	mm INCH 4 PLACES ± --- ± --- 3 PLACES ± --- ± .005 2 PLACES ± 0.13 ± .010 1 PLACE ± 0.25 ± ---	MM/IN	DRAWN BY DATE KMS 1999/10/15 CHECKED BY DATE KMS 1999/10/15 APPROVED BY DATE KMS 1999/10/15	INCH	TITLE SALES ASSY INSULATOR DUAL ROW SMT W/BREAK-OFF .025SQ PIN GULLWING .100	
		ANGULAR ±1/2°		MATERIAL NO.	DOCUMENT NO.		
		DRAFT WHERE APPLICABLE MUST REMAIN WITHIN DIMENSIONS	SEE TABLE	SD-71308-001		SHEET NO. 2 OF 6	

		13	12	11	10	9	8	7	6	5	4	3	2	1		
		IN TAPE AND REEL WITH SHALLOW POCKET TAPE										BULK / IN TUBES				
J	PACKAGING SEE NOTE 4, SHT 1	4-8 CKT		TAPE-N-REEL W/ VAC CAPS		TAPE-N-REEL W/ VAC CAPS						BULK		BULK		
		10-100 CKT		TAPE-N-REEL W/ VAC CAPS		TAPE-N-REEL W/ VAC CAPS						TUBES		TUBES		
		DIM. M ±0.25 MM		6.10 (.240)		6.10 (.240)						8.13 (.320)		13.59 (.535)		
		PLATING		30 GOLD		15 GOLD						150 TIN		150 TIN		
		DIM. H		2.54 (.100)		2.54 (.100)						4.57 (.180)		4.57 (.180)		
		DIM. J		5.08 (.200)		5.08 (.200)						7.11 (.280)		7.11 (.280)		
I	CKTS	DIM. A		DIM. B		EDP NUMBER	EDP NUMBER					EDP NUMBER	EDP NUMBER	CKTS		
		MM	IN	MM	IN											
	04	5.08	.200	2.54	.100									04		
	06	7.62	.300	5.08	.200		015-91-6068							06		
	08	10.16	.400	7.62	.300		015-91-6088							08		
	10	12.70	.500	10.16	.400		015-91-6108					713088010	71308-8210	10		
	12	15.24	.600	12.70	.500									12		
	14	17.78	.700	15.24	.600	015-91-6148								14		
	16	20.32	.800	17.78	.700							713088016		16		
	18	22.86	.900	20.32	.800									18		
	20	25.40	1.000	22.86	.900									20		
	22	27.94	1.100	25.40	1.000									22		
	24	30.48	1.200	27.94	1.100									24		
	26	33.02	1.300	30.48	1.200									26		
	28	35.56	1.400	33.02	1.300									28		
	30	38.10	1.500	35.56	1.400									30		
	32	40.64	1.600	38.10	1.500									32		
	34	43.18	1.700	40.64	1.600									34		
	36	45.72	1.800	43.18	1.700									36		
	38	48.26	1.900	45.72	1.800									38		
	40	50.80	2.000	48.26	1.900									40		
	42	53.34	2.100	50.80	2.000									42		
	44	55.88	2.200	53.34	2.100									44		
	46	58.42	2.300	55.88	2.200									46		
	48	60.96	2.400	58.42	2.300									48		
	50	63.50	2.500	60.96	2.400									50		
	52	66.04	2.600	63.50	2.500									52		
	54	68.58	2.700	66.04	2.600									54		
	56	71.12	2.800	68.58	2.700									56		
	58	73.66	2.900	71.12	2.800									58		
	60	76.20	3.000	73.66	2.900									60		
	62	78.74	3.100	76.20	3.000									62		
	64	81.28	3.200	78.74	3.100									64		
	66	83.82	3.300	81.28	3.200									66		
	68	86.36	3.400	83.82	3.300									68		
	70	88.90	3.500	86.36	3.400									70		
	72	91.44	3.600	88.90	3.500									72		
	74	93.98	3.700	91.44	3.600									74		
	76	96.52	3.800	93.98	3.700									76		
	78	99.06	3.900	96.52	3.800									78		
	80	101.60	4.000	99.06	3.900									80		
	82	104.14	4.100	101.60	4.000									82		
	84	106.68	4.200	104.14	4.100									84		
	86	109.22	4.300	106.68	4.200									86		
	88	111.76	4.400	109.22	4.300									88		
	90	114.30	4.500	111.76	4.400									90		
	92	116.84	4.600	114.30	4.500									92		
	94	119.38	4.700	116.84	4.600									94		
	96	121.92	4.800	119.38	4.700									96		
	98	124.46	4.900	121.92	4.800									98		
	100	127.00	5.000	124.46	4.900									100		

NO PEG VERSION  
(ALSO SEE SHEET 2)

SEE SHEET 1 EC NO. UEP2011-1028 DRAWN: IPER 2010/12/14 CHKD: JEBELL APPR: F SMITH 2010/12/17 DESCRIPTION REV	QUALITY SYMBOLS	GENERAL TOLERANCES (UNLESS SPECIFIED)	DIMENSION STYLE	SCALE	DESIGN UNITS	THIRD ANGLE PROJECTION
	$\nabla=0$ $\nabla=0$	mm INCH 4 PLACES ± --- ± --- 3 PLACES ± --- ± .005 2 PLACES ± 0.13 ± .010 1 PLACE ± 0.25 ± --- ANGULAR ± 1/2°	MM/IN	INCH	INCH	
			DRAWN BY DATE	TITLE		
			KMS 1999/10/15	SALES ASSY INSULATOR DUAL ROW SMT W/BREAK-OFF .025SQ PIN GULLWING .100		
			CHECKED BY DATE			
			KMS 1999/10/15			
			APPROVED BY DATE			
			KMS 1999/10/15			
			MATERIAL NO.	DOCUMENT NO.		SHEET NO.
			SEE TABLE	SD-71308-001		3 OF 6
			THIS DRAWING CONTAINS INFORMATION THAT IS PROPRIETARY TO MOLEX INCORPORATED AND SHOULD NOT BE USED WITHOUT WRITTEN PERMISSION			



	13	12	11	10	9	8	7	6	5	4	3	2	1	
J	PACKAGING SEE NOTE 4 SHT 1			4-8 CKT	BULK	TAPE-N-REEL W/ VAC CAPS	BULK	TAPE-N-REEL W/ VAC CAPS						
				10-100 CKT	TUBES	TAPE-N-REEL W/ VAC CAPS	TUBES	TAPE-N-REEL W/ VAC CAPS						
	DIM. M ±0.25 MM			6.10 (.240)			6.10 (.240)							
	PLATING			30 GOLD			150 TIN							
	DIM. H			2.54 (.100)			2.54 (.100)							
	DIM. J			5.08 (.200)			5.08 (.200)							
I	CKTS	DIM. A		DIM. B		DIM. C		EDP NUMBER	EDP NUMBER	EDP NUMBER	EDP NUMBER	EDP NUMBER	EDP NUMBER	CKTS
		MM	IN	MM	IN	MM	IN							
	04	5.08	.200	2.54	.100	----	----	015-91-1048	015-91-6047					04
	06	7.62	.300	5.08	.200	2.54	.100	015-91-1068	015-91-6067	71308-6106	71308-6206			06
	08	10.16	.400	7.62	.300	5.08	.200	015-91-1088	015-91-6087	71308-6108	71308-6208			08
	10	12.70	.500	10.16	.400	7.62	.300	015-91-1108	015-91-6107	71308-6110	71308-6210			10
	12	15.24	.600	12.70	.500	10.16	.400	015-91-1128						12
	14	17.78	.700	15.24	.600	12.70	.500	015-91-1148	015-91-6147					14
	16	20.32	.800	17.78	.700	15.24	.600	015-91-1168	015-91-6167					16
	18	22.86	.900	20.32	.800	17.78	.700	015-91-1188						18
	20	25.40	1.000	22.86	.900	20.32	.800	015-91-1208	015-91-6207					20
	22	27.94	1.100	25.40	1.000	22.86	.900	015-91-1228						22
	24	30.48	1.200	27.94	1.100	25.40	1.000	015-91-1248						24
	26	33.02	1.300	30.48	1.200	27.94	1.100	015-91-1268		71308-6126				26
	28	35.56	1.400	33.02	1.300	30.48	1.200	015-91-1288						28
	30	38.10	1.500	35.56	1.400	33.02	1.300	015-91-1308						30
	32	40.64	1.600	38.10	1.500	35.56	1.400	015-91-1328						32
	34	43.18	1.700	40.64	1.600	38.10	1.500	015-91-1348						34
	36	45.72	1.800	43.18	1.700	40.64	1.600	015-91-1368						36
	38	48.26	1.900	45.72	1.800	43.18	1.700	015-91-1388						38
	40	50.80	2.000	48.26	1.900	45.72	1.800	015-91-1408	015-91-6407					40
	42	53.34	2.100	50.80	2.000	48.26	1.900	015-91-1428						42
	44	55.88	2.200	53.34	2.100	50.80	2.000	015-91-1448						44
	46	58.42	2.300	55.88	2.200	53.34	2.100	015-91-1468						46
	48	60.96	2.400	58.42	2.300	55.88	2.200	015-91-1488						48
	50	63.50	2.500	60.96	2.400	58.42	2.300	015-91-1508	015-91-6507					50
	52	66.04	2.600	63.50	2.500	60.96	2.400	015-91-1528						52
	54	68.58	2.700	66.04	2.600	63.50	2.500	015-91-1548						54
	56	71.12	2.800	68.58	2.700	66.04	2.600	015-91-1568						56
	58	73.66	2.900	71.12	2.800	68.58	2.700	015-91-1588						58
	60	76.20	3.000	73.66	2.900	71.12	2.800	015-91-1608						60
	62	78.74	3.100	76.20	3.000	73.66	2.900	015-91-1628						62
	64	81.28	3.200	78.74	3.100	76.20	3.000	015-91-1648						64
	66	83.82	3.300	81.28	3.200	78.74	3.100	015-91-1668						66
	68	86.36	3.400	83.82	3.300	81.28	3.200	015-91-1688						68
	70	88.90	3.500	86.36	3.400	83.82	3.300	015-91-1708						70
	72	91.44	3.600	88.90	3.500	86.36	3.400	015-91-1728						72
	74	93.98	3.700	91.44	3.600	88.90	3.500	015-91-1748						74
	76	96.52	3.800	93.98	3.700	91.44	3.600	015-91-1768						76
	78	99.06	3.900	96.52	3.800	93.98	3.700	015-91-1788						78
	80	101.60	4.000	99.06	3.900	96.52	3.800	015-91-1808						80
	82	104.14	4.100	101.60	4.000	99.06	3.900	71308-6082						82
	84	106.68	4.200	104.14	4.100	101.60	4.000	71308-6084						84
	86	109.22	4.300	106.68	4.200	104.14	4.100	71308-6086						86
	88	111.76	4.400	109.22	4.300	106.68	4.200	71308-6088						88
	90	114.30	4.500	111.76	4.400	109.22	4.300	71308-6090						90
	92	116.84	4.600	114.30	4.500	111.76	4.400	71308-6092						92
	94	119.38	4.700	116.84	4.600	114.30	4.500	71308-6094						94
	96	121.92	4.800	119.38	4.700	116.84	4.600	71308-6096						96
	98	124.46	4.900	121.92	4.800	119.38	4.700	71308-6098						98
	100	127.00	5.000	124.46	4.900	121.92	4.800	71308-6100						100

SHORT PEG VERSION (.055")

SEE SHEET 1 EC NO: UCPE2011-1028 DRAWN BY: PPR 2010/12/14 CHKD: JBL APPR: ESM/TH 2010/12/17	QUALITY SYMBOLS	GENERAL TOLERANCES (UNLESS SPECIFIED)	DIMENSION STYLE	SCALE	DESIGN UNITS	THIRD ANGLE PROJECTION
	$\nabla=0$ $\nabla=0$	mm INCH 4 PLACES ±.005 ±.005 3 PLACES ±.010 ±.005 2 PLACES ±.025 ±.010 1 PLACE ±.050 ±.025 ANGULAR ±1/2°	MM/IN	INCH	INCH	
			DRAWN BY: KMS	DATE: 1999/10/15	TITLE: SALES ASSY INSULATOR DUAL ROW SMT W/BREAK-OFF .025SQ PIN GULLWING .100	
			CHECKED BY: KMS	DATE: 1999/10/15	APPROVED BY: KMS	
				DATE: 1999/10/15		MATERIAL NO. SD-71308-001
				DATE: 1999/10/15		DOCUMENT NO. SD-71308-001
		DRAFT WHERE APPLICABLE MUST REMAIN WITHIN DIMENSIONS	SIZE: SEE TABLE	THIS DRAWING CONTAINS INFORMATION THAT IS PROPRIETARY TO MOLEX INCORPORATED AND SHOULD NOT BE USED WITHOUT WRITTEN PERMISSION		SHEET NO. 5 OF 6

13 12 11 10 9 8 7 6 5 4 3 2 1

J

I

H

G

F

E

D

C

B

A

J

I

H

G

F

E

D

C

B

A

PEG OPTION

NO PEG VERSION

NO PEG VERSION

LONG PEG VERSION (.130")

SHORT PEG VERSION (.055")

PACKAGING SEE NOTE 4, SHT 1	4-6 CKT	BULK	TAPE-N-REEL W/VAC CAPS	N/A	4-8 CKT	TAPE-N-REEL W/VAC CAPS	BULK	BULK	BULK	TAPE-N-REEL W/VAC CAPS	BULK	BULK	TAPE-N-REEL W/VAC CAPS
	8-100 CKT	TUBES	TAPE-N-REEL W/VAC CAPS	TUBES W/ VAC CAPS	10-100 CKT	TAPE-N-REEL W/VAC CAPS	TUBES	TUBES	TUBES	TAPE-N-REEL W/VAC CAPS	TUBES	BULK	TAPE-N-REEL W/ VAC CAPS

DIM. M±0.25 MM	6.10 (.240)	8.13(.320)	13.59(.535)	6.10(.240)	8.13(.320)	6.10 (.240)
PLATING	59 TIN	59 TIN	59 TIN	59 TIN	59 TIN	59 TIN
DIM. H	2.54(.100)	4.57(.180)	4.57(.180)	2.54(.100)	4.57(.180)	2.54(.100)
DIM. J	5.08(.200)	7.11(.280)	7.11(.280)	5.08(.200)	7.11(.280)	5.08(.200)

CKTS	DIM. A		DIM. B		DIM. C		EDP NUMBER	EDP NUMBER	EDP NUMBER	EDP NUMBER	EDP NUMBER	EDP NUMBER	EDP NUMBER	EDP NUMBER	EDP NUMBER	EDP NUMBER	EDP NUMBER	EDP NUMBER	CKTS	
	MM	IN	MM	IN	MM	IN														
04	5.08	.200	2.54	.100	---	---	71308-5404	71308-5504	N/A				71308-6404	71308-6504	71308-6604				04	
06	7.62	.300	5.08	.200	2.54	.100	71308-5406	71308-5506	N/A				71308-6406	71308-6506	71308-6606	71308-6706	71308-6806		06	
08	10.16	.400	7.62	.300	5.08	.200	71308-5408	71308-5508	71308-5608				71308-6408	71308-6508	71308-6608	71308-6708	71308-6808		08	
10	12.70	.500	10.16	.400	7.62	.300	71308-5410	71308-5510	71308-5610			71308-5810	71308-5910	71308-6410	71308-6510	71308-6610	71308-6710	71308-6810		10
12	15.24	.600	12.70	.500	10.16	.400	71308-5412	71308-5512	71308-5612					71308-6412	71308-6512	71308-6612				12
14	17.78	.700	15.24	.600	12.70	.500	71308-5414	71308-5514	71308-5614					71308-6414	71308-6514	71308-6614				14
16	20.32	.800	17.78	.700	15.24	.600	71308-5416	71308-5516	71308-5616			71308-5816		71308-6416	71308-6516	71308-6616				16
18	22.86	.900	20.32	.800	17.78	.700	71308-5418		71308-5618					71308-6418		71308-6618				18
20	25.40	1.000	22.86	.900	20.32	.800	71308-5420	71308-5520	71308-5620					71308-6420		71308-6620				20
22	27.94	1.100	25.40	1.000	22.86	.900	71308-5422		71308-5622					71308-6422		71308-6622				22
24	30.48	1.200	27.94	1.100	25.40	1.000	71308-5424		71308-5624			71308-5724	71308-5824	71308-6424		71308-6624				24
26	33.02	1.300	30.48	1.200	27.94	1.100	71308-5426		71308-5626					71308-6426		71308-6626	71308-6726			26
28	35.56	1.400	33.02	1.300	30.48	1.200	71308-5428		71308-5628					71308-6428		71308-6628				28
30	38.10	1.500	35.56	1.400	33.02	1.300	71308-5430		71308-5630					71308-6430		71308-6630				30
32	40.64	1.600	38.10	1.500	35.56	1.400	71308-5432		71308-5632					71308-6432		71308-6632				32
34	43.18	1.700	40.64	1.600	38.10	1.500	71308-5434		71308-5634					71308-6434		71308-6634				34
36	45.72	1.800	43.18	1.700	40.64	1.600	71308-5436		71308-5636					71308-6436		71308-6636				36
38	48.26	1.900	45.72	1.800	43.18	1.700	71308-5438		71308-5638					71308-6438		71308-6638				38
40	50.80	2.000	48.26	1.900	45.72	1.800	71308-5440	71308-5540	71308-5640					71308-6440		71308-6640				40
42	53.34	2.100	50.80	2.000	48.26	1.900	71308-5442		71308-5642					71308-6442		71308-6642				42
44	55.88	2.200	53.34	2.100	50.80	2.000	71308-5444		71308-5644					71308-6444		71308-6644				44
46	58.42	2.300	55.88	2.200	53.34	2.100	71308-5446		71308-5646					71308-6446		71308-6646				46
48	60.96	2.400	58.42	2.300	55.88	2.200	71308-5448		71308-5648					71308-6448		71308-6648				48
50	63.50	2.500	60.96	2.400	58.42	2.300	71308-5450	71308-5550	71308-5650					71308-6450	71308-6550	71308-6650				50
52	66.04	2.600	63.50	2.500	60.96	2.400	71308-5452		71308-5652					71308-6452		71308-6652				52
54	68.58	2.700	66.04	2.600	63.50	2.500	71308-5454		71308-5654					71308-6454		71308-6654				54
56	71.12	2.800	68.58	2.700	66.04	2.600	71308-5456		71308-5656					71308-6456		71308-6656				56
58	73.66	2.900	71.12	2.800	68.58	2.700	71308-5458		71308-5658					71308-6458		71308-6658				58
60	76.20	3.000	73.66	2.900	71.12	2.800	71308-5460		71308-5660					71308-6460		71308-6660				60
62	78.74	3.100	76.20	3.000	73.66	2.900	71308-5462		71308-5662					71308-6462		71308-6662				62
64	81.28	3.200	78.74	3.100	76.20	3.000	71308-5464		71308-5664					71308-6464		71308-6664				64
66	83.82	3.300	81.28	3.200	78.74	3.100	71308-5466		71308-5666					71308-6466		71308-6666				66
68	86.36	3.400	83.82	3.300	81.28	3.200	71308-5468		71308-5668					71308-6468		71308-6668				68
70	88.90	3.500	86.36	3.400	83.82	3.300	71308-5470		71308-5670					71308-6470		71308-6670				70
72	91.44	3.600	88.90	3.500	86.36	3.400	71308-5472		71308-5672					71308-6472		71308-6672				72
74	93.98	3.700	91.44	3.600	88.90	3.500	71308-5474		71308-5674					71308-6474		71308-6674				74
76	96.52	3.800	93.98	3.700	91.44	3.600	71308-5476		71308-5676					71308-6476		71308-6676				76
78	99.06	3.900	96.52	3.800	93.98	3.700	71308-5478		71308-5678					71308-6478		71308-6678				78
80	101.60	4.000	99.06	3.900	96.52	3.800	71308-5480		71308-5680					71308-6480		71308-6680				80
82	104.14	4.100	101.60	4.000	99.06	3.900	71308-5482		71308-5682					71308-6482		71308-6682				82
84	106.68	4.200	104.14	4.100	101.60	4.000	71308-5484		71308-5684					71308-6484		71308-6684				84
86	109.22	4.300	106.68	4.200	104.14	4.100	71308-5486		71308-5686					71308-6486		71308-6686				86
88	111.76	4.400	109.22	4.300	106.68	4.200	71308-5488		71308-5688					71308-6488		71308-6688				88
90	114.30	4.500	111.76	4.400	109.22	4.300	71308-5490		71308-5690					71308-6490		71308-6690				90
92	116.84	4.600	114.30	4.500	111.76	4.400	71308-5492		71308-5692					71308-6492		71308-6692				92
94	119.38	4.700	116.84	4.600	114.30	4.500	71308-5494		71308-5694					71308-6494		71308-6694				94
96	121.92	4.800	119.38	4.700	116.84	4.600	71308-5496		71308-5696					71308-6496		71308-6696				96
98	124.46	4.900	121.92	4.800	119.38	4.700	71308-5498		71308-5698					71308-6498		71308-6698				98
100	127.00	5.000	124.46	4.900	121.92	4.800	71308-5500		71308-5700					71308-6500		71308-6700				100

59 TIN PLATE ASSEMBLIES

SEE SHEET 1 EC NO. UCP2011-1028 DRAWN BY PPR 2010/12/14 CHKD: JBEL APPR: SMITH 2010/12/17 DESCRIPTION REV	QUALITY SYMBOLS	GENERAL TOLERANCES (UNLESS SPECIFIED)	DIMENSION STYLE	SCALE	DESIGN UNITS	THIRD ANGLE PROJECTION
	$\nabla=0$ $\nabla=0$	4 PLACES ±.005 ±.005 3 PLACES ±.005 ±.005 2 PLACES ±0.13 ±.010 1 PLACE ±0.25 ±.005 ANGULAR ±1/2°	MM/IN DRAWN BY DATE KMS 1999/10/15 CHECKED BY DATE KMS 1999/10/15 APPROVED BY DATE KMS 1999/10/15	1:1	INCH	SALES ASSY INSULATOR DUAL ROW SMT W/BREAK-OFF .025SQ PIN GULLWING .100 MOLEX INCORPORATED
		DRAFT WHERE APPLICABLE MUST REMAIN WITHIN DIMENSIONS	SEE TABLE	MATERIAL NO.	DOCUMENT NO.	
						SHEET NO. 6 OF 6

12 11 10 9 8 7 6 5 4 3 2 1

1b\_frame\_C.P. AM.T Rev. E 2006/04/15