

PRODUCT NUMBER
98424-X52-XX-XXXLF

PLATING _____ WHEN REQUIRED, ADD SUFFIX LETTER "LF"
S = 0.38µm GOLD/CXT ON CONTACT AREA INDICATES THE PRODUCT IS RoHS
3.81µm TIN LEAD COMPATIBLE, SEE NOTE 8
ON TAIL POLARIZATION (SEE NOTE 7)
G = 0.76µm GOLD/CXT ON CONTACT AREA PACKAGING OPTIONAL LETTER (SEE NOTE 5)
3.81µm TIN LEAD ON TAIL TOTAL NB OF POSITIONS, 04 TO 50
F = GOLD FLASH ON CONTACT AREA
3.81µm TIN LEAD ON TAIL

NOTES:

1. MATERIAL HOUSING: HIGH TEMP. THERMOPLASTIC
UL 94V-0, COLOR CREAM
2. MATERIAL TERMINAL: COPPER ALLOY
3. TO DETERMINE DIMENSIONS:
N = NUMBER OF POSITIONS PER ROW
4. 7N MIN. PIN RETENTION IN EITHER DIRECTION.
5. PACKAGING:
= PLASTIC BOX
- = PLASTIC BOX WHEN POLARISATION FEATURE APPLICABLE
U = TUBE AVAILABLE FROM 08 TO 50 POS
A = TAPE AND REEL WITH PICK UP CAP INSTALLED IN THE CENTER OF
THE PRODUCT FOR PICK AND PLACE, SEE TA884 FOR AVAILABILITY.
K = TAPE AND REEL WITHOUT PICK UP CAP
C = TAPE AND REEL WITH SPECIAL LARGE CAP, ONLY FOR 98424-Y52-06CLF
FOR ALL SPECIAL PACKAGING, FCI TO BE CONTACTED

6. DIM "C" = (N x 2) + 1.4
EXAMPLE: N = 7
DIM "C" = (7 x 2) + 1.4 = 15.4 mm
7. FOR POLARIZATION, SPECIFIED PIN
EXAMPLE : A03 = ROW A, POSITION 03 TO OMIT PIN
OMIT FROM PRODUCT NUMBER IF THIS FEATURE IS NOT APPLICABLE

8. RoHS COMPATIBLE PRODUCT SPECIFICATIONS

- PLATING:**
- "LF" MEANS THE PRODUCT IS LEAD-FREE,
2µm MINIMUM MATTE TIN OVER 1.27µm
MINIMUM NICKEL UNDERPLATE.
- MANUFACTURING PROCESS COMPATIBILITY**
- THE HOUSING WILL WITHSTAND EXPOSURE TO
260°C PEAK TEMPERATURE FOR 30 SECONDS
MAX IN A CONVECTION, INFRA-RED OR VAPOR
PHASE OR REFLOW OVEN.
- LABELLING:**
- MEETS PACKAGING SPECS AS PER GS-14-920
- THIS PRODUCT MEETS EUROPEAN DIRECTIVES
AND OTHER COUNTRY REGULATIONS AS DISCRIBED
IN GS-22-008.

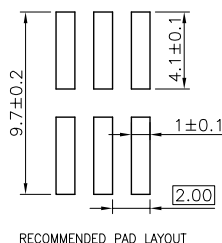
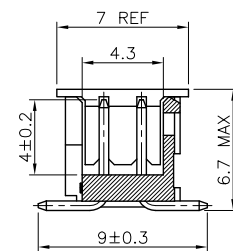
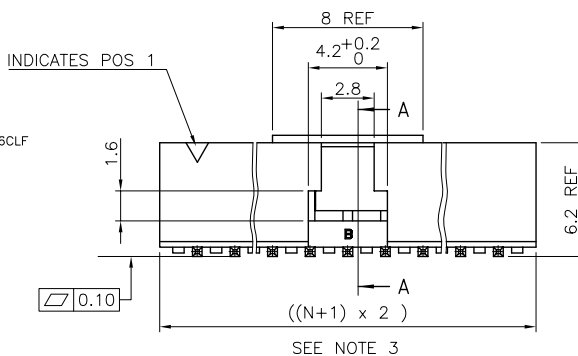
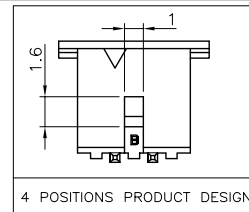
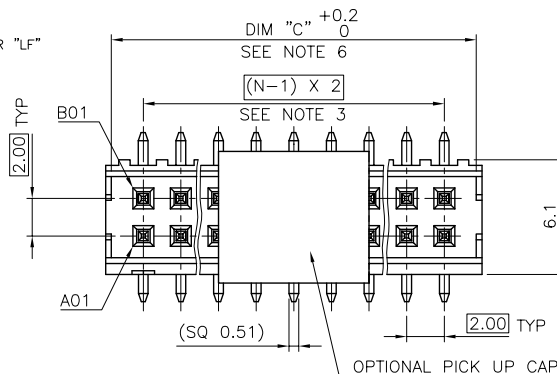

mat'l. code				surface		tolerance		projection		product family	
SEE NOTES				ISO 1302		ISO 406 ISO 101				MINITEK	
ltr	ecn no	dr	date	tolerances unless otherwise specified							
N	F10-0007	JCO	10.01.28	angles		linear				title	
						X.X ±0.3				SHR HEADER	
H	F05-0124	LMU	05.02.07			X.XXX ±0.13		scale 1:1		2.00 VERTICAL SMT	
J	F06-0210	LMU	06.07.05	dr	L.MULIN		04.09.27				
K	F06-0259	LMU	06.08.28	eng	J.COMPAGNON		04.09.27				
L	F08-0113	LMU	08.01.17	chr							
M	F08-0149	ELA	17.04.08	app	JMC		04.09.27		dwg no		
									sheet 1 of 2		
									size		
									98424		
									A3		
									type		
									CUSTOMER Drawing		
sheet	revision	N	A								
index	sheet	1	2								

PDM: Rev:N

STATUS Released

Printed: Apr 02, 2010

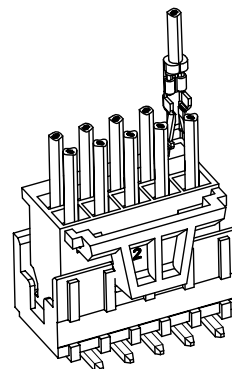
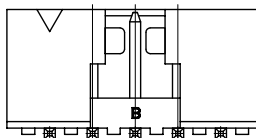
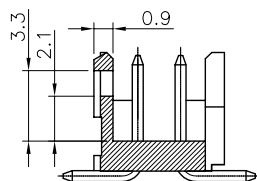
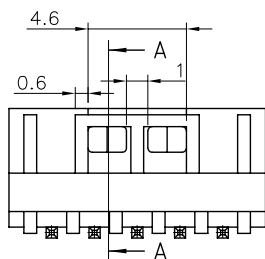
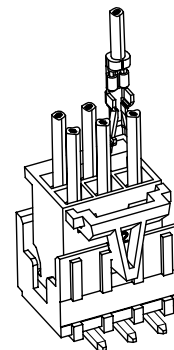
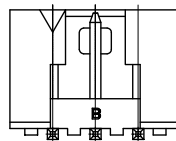
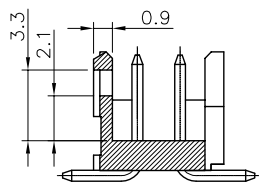
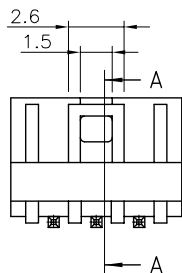

LATCHING FEATURES WHEN USED IN COMBINATION
WITH ACTIVE LATCH HOUSING 10073599

mat'l. code SEE NOTES				surface ISO 1302	tolerance ISO 406 ISO	projection 101	product family MINITEK	
ltr	ecr	no	dr	date		tolerances unless otherwise specified		title
A	F08-0113	LMU	08.01.17			angles	linear	mm
						X.X ±0.3		scale 1:1
						X.XX ±0.13		
						X.XXX ±0.05		
				dr	L.MULIN	07.11.06	FCI	
				engr	J.COMPAGNON	07.11.06		
				chr				
				appd	J.M.C	07.11.06		
sheet	revision							
index	sheet							

dwg no		sheet 2 of	size
98424			A3
type		CUSTOMER Drawing	

PDM: Rev:N

STATUS Released

Printed: Apr 02, 2010