

REV.	ECN NO. OR DESCRIPTION	REVISED	DATE
C	修改與實物相符	EVEN	11/14-03

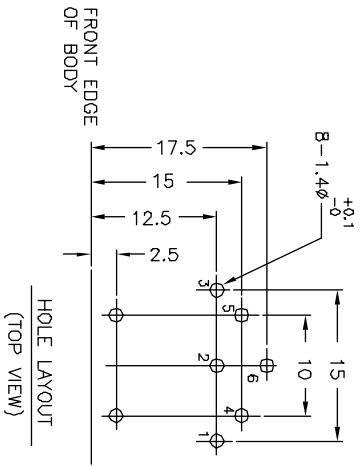
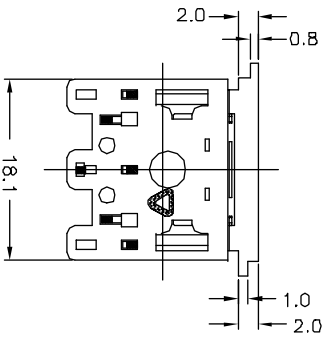
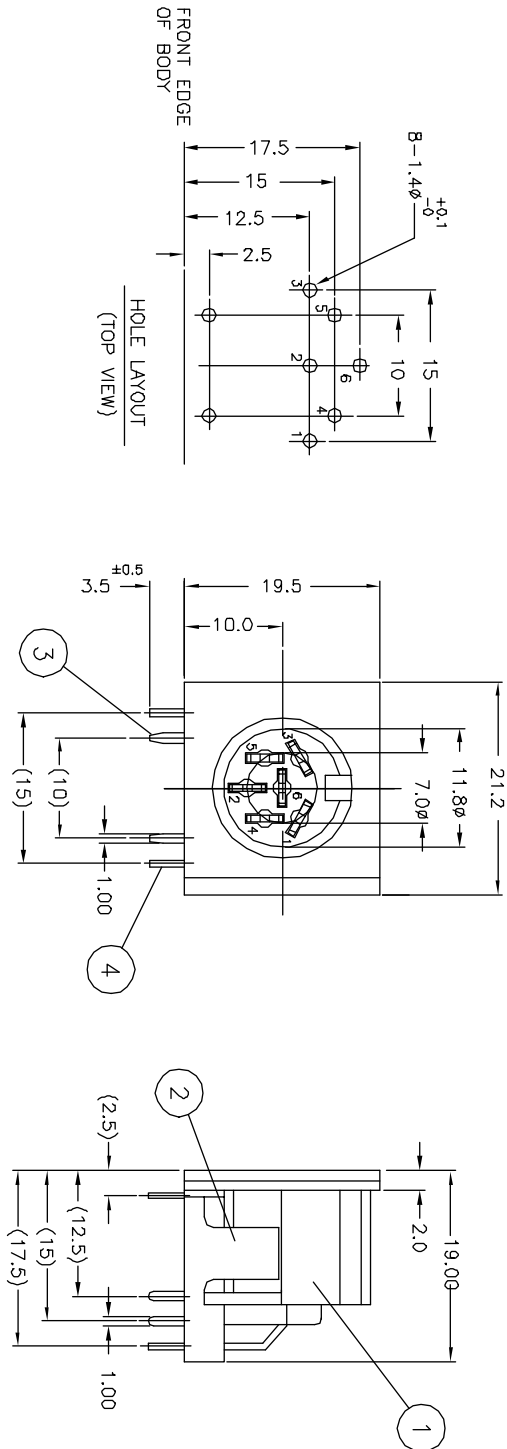

- SPECIFICATIONS:**
- CURRENT CARRYING CAPACITY:
    - AC: 100V 1A MAX.
    - DC: 24V 2A MAX.
  - CONTACT RESISTANCE:
    - INITIAL, BEFORE LIFE CYCLE TEST, CONTACTOR TO PLUG PIN: 20mΩ MAX. EARTH TERMINAL TO PLUG SHELL: 100mΩ MAX.
    - AFTER LIFE CYCLE TEST, CONTACTOR TO PLUG PIN: 100mΩ MAX. EARTH TERMINAL TO PLUG SHELL: 150mΩ MAX.
  - INSULATION RESISTANCE: BETWEEN ANY ADJACENT OPEN CONTACTS SHALL NOT BE LESS THAN 100MΩ AS SPECIFIED BELOW WITH AT 500V DC INSULATION RESISTANCE TEST.
  - DIELECTRIC STRENGTH: A POTENTIAL OF 500V AC RMS, 50/60HZ SHALL BE APPLIED BETWEEN ANY OPEN CONTACTS FOR ONE MINUTE WITHOUT BREAKDOWN.
  - INSERTION FORCE: 5.0kg MAX.
  - WITHDRAWAL FORCE: 1.0kg MIN.
  - LIFE CYCLE TEST: CONNECTOR SHALL BE SUBJECT TO 5,000 CYCLES AT 10 TO 20 CYCLES PER MINUTE WITH NO ELECTRICAL LOAD.

4	CONTACT TERMINAL	6	BRASS 0.7t	TIN ALLOY PLATING
3	EARTH TERMINAL	1	PHOSPHOR BRONZE 0.25t	TIN ALLOY PLATING
2	COVER	1	PBT UL 94V-0	BLACK COLOR
1	BODY	1	PBT UL 94V-0	BLACK COLOR
NO	DESCRIPTION	QTY	MATERIAL	PLATING & COLOR
UNLESS OTHERWISE SPECIFIED TOLERANCES				
Singatron Enterprise Co., Ltd. 信音企業股份有限公司				
TITLE: 6P 240V DIN CONNECTOR				
DECIMALS:	ANGLES:	TITLE: 6P 240V DIN CONNECTOR		
X : ±0.3	X : ±2°	DWN	EN 11/14-03	PART NO. 2DJ-0196PA02
X.X : ±0.2	X.X : ±1°	CHKD	SN 11/18-03	SCALE: 2/1
X.XX : ±0.1		APVD	ANDY 11/18-03	SIZE: A3
				SHEET: 1 OF 1
				REV: C