

4

3

2

1

THIS DRAWING IS UNPUBLISHED. RELEASED FOR PUBLICATION
 © COPYRIGHT BY TYCO ELECTRONICS CORPORATION. ALL RIGHTS RESERVED.

LOC		DIST		REVISIONS			
FT	0	P	LTR	DESCRIPTION	DATE	MIN	APVD
		C		REVISED PER ECO-06-10652	5/8/06	SS	SH

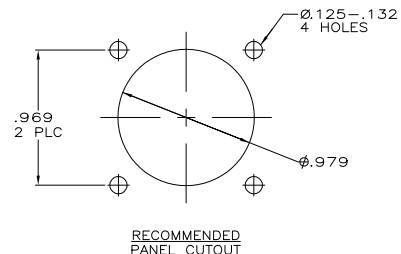
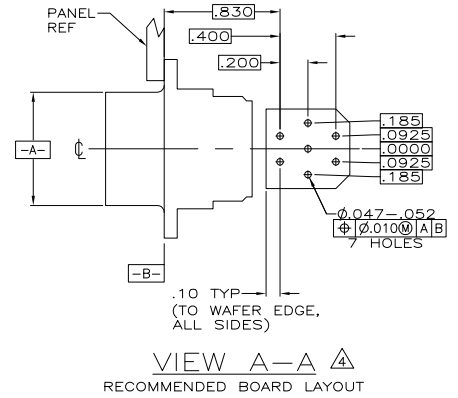
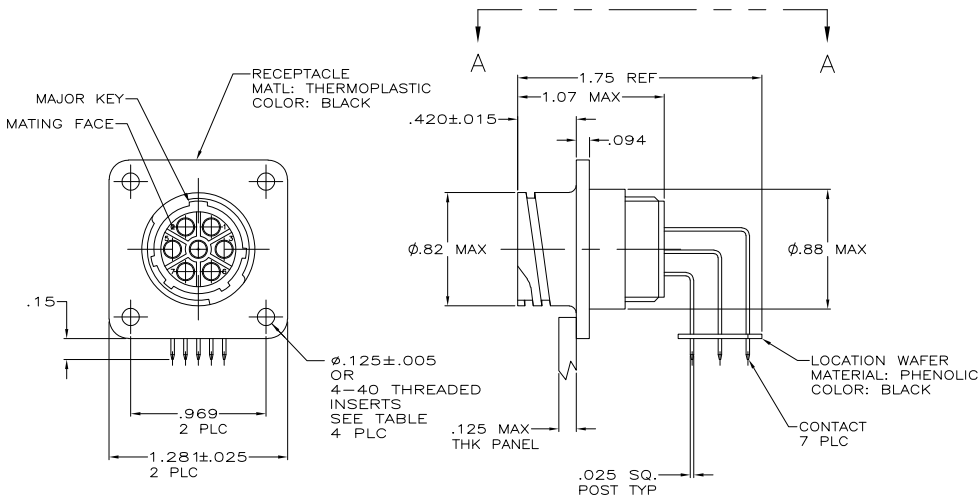

- CONTACT CAVITIES IDENTIFIED BY CHARACTERS ON FRONT AND REAR FACES OF CONNECTOR.
- #4 FASTENER RECOMMENDED FOR MOUNTING.
- CONTACT BODY: .000030 MIN GOLD FOR A LENGTH OF .200 MIN FROM MATING END, WITH REMAINDER TO BE GOLD FLASH, BOTH OVER .000050 MIN NICKEL.
CONTACT POST: .000100 MIN TIN-LEAD OVER .000100 MIN COPPER.
- PC BOARD HOLE PATTERN IS DEFINED RELATIVE TO CONNECTOR C.L. AND PANEL MOUNTING FACE INDICATED.
- CONTACT BODY: .000030 MIN GOLD FOR A LENGTH OF .200 MIN FROM MATING END, WITH REMAINDER TO BE GOLD FLASH, BOTH OVER .000050 MIN NICKEL.
CONTACT POST: .000100 MIN TIN OVER .000100 MIN COPPER.

NO	△	1-796500-1
YES	△	796500-2
NO	△	796500-1
THREADED CONTACT INSERT		PART NUMBER

THIS DRAWING IS A CONTROLLED DOCUMENT.		REV	DATE	Tyco Electronics Corporation	
DIMENSIONS: INCHES		OK	4-7-00	Harrisburg, Pa 17105-3608	
MATERIAL		OK	4-10-00	RECEPTACLE ASSY, POSTED, RT ANGLE, RVS SEX, SIZE 13-7, SERIES 1, CPC	
FINISH		APP	4-10-00	SIZE	A2
		NAME		CAGE CODE	00779
		APPLICATION SPEC		DRAWING NO	C=796500
		HEIGHT		RESTRICTED TO	
		CUSTOMER DRAWING		SCALE	2:1
				SHEET	1 OF 1
				REV	C

AMP 1471-9 REV 31MM2000

796500

A