

THIS DRAWING IS UNAPPROVED FOR REVISIONS
 ALL RIGHTS RESERVED

REV	DATE	DESCRIPTION	BY	CHK	APP
0					
1		REVISED PER EDD-11-00927			

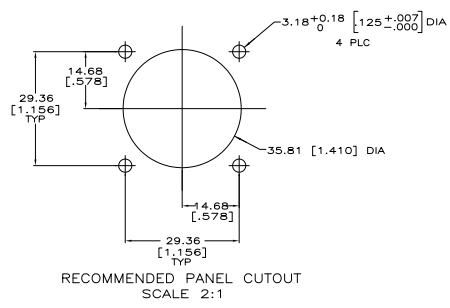
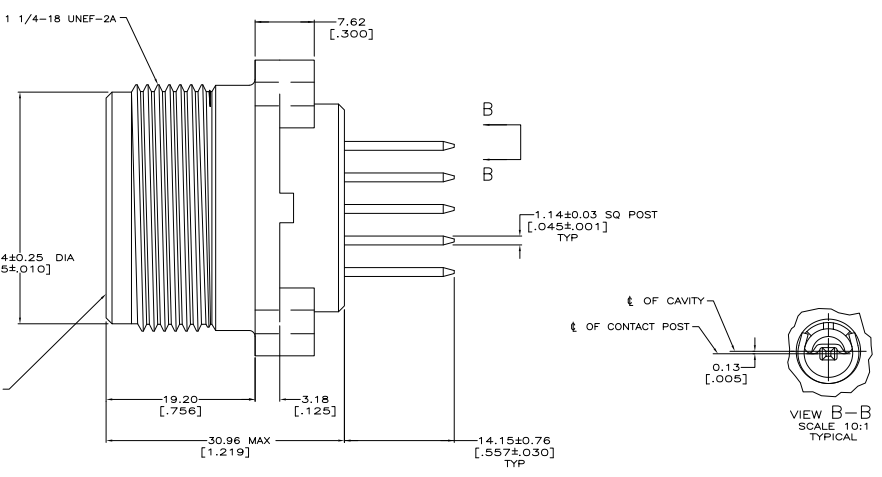
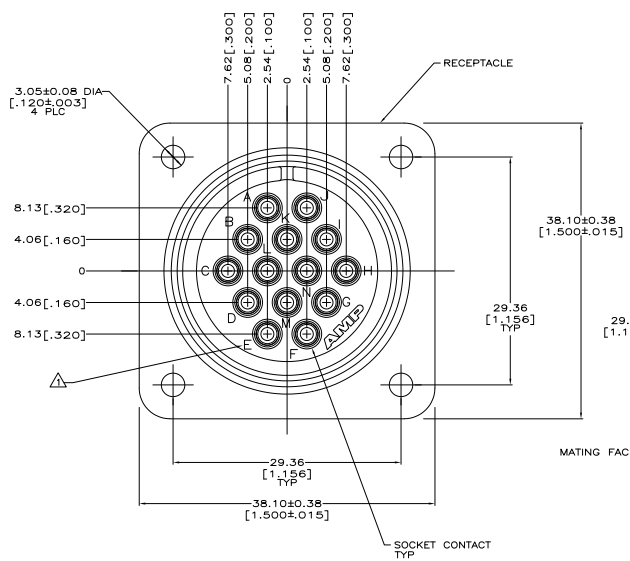

- △ CAVITY IDENTIFICATION CHARACTERS ON FRONT AND REAR FACE.
- △ RECEPTACLE: NYLON, UL 94V-0 RATED, BLACK.
CONTACT AND POST: BRASS.
SPRING: STAINLESS STEEL.
- △ SOCKET CONTACT AND POST: 2.54um [.000100] MIN TIN-LEAD OVER 1.27um [.000050] MIN NICKEL.
- △ SOCKET CONTACT AND POST: 2.54um [.000100] MIN TIN OVER 1.27um [.000050] MIN NICKEL.
- △ OBSOLETE PARTS: OBSOLETE CIS STREAMLINING PER D.RENAUD/D.SINISI

△ OBSOLETE	△	B, C, D, E, F, H, I, J, L, M, N	1-213928-4
	△	A, B, C, D, E, F, G, H, K	1-213928-3
	△	A, B, C, D, E, K	1-213928-2
	△	ALL	1-213928-1
△ OBSOLETE	△	B, C, D, E, F, H, I, J, L, M, N	213928-4
	△	A, B, C, D, E, F, G, H, K	213928-3
	△	A, B, C, D, E, K	213928-2
	△	ALL	213928-1

FINISH		POSITIONS LOADED		PART NUMBER

THIS DRAWING IS A CONTROLLED DOCUMENT. THE CUSTOMER MUST BE NOTIFIED IN WRITING OF ANY CHANGES TO THIS DRAWING.

DESCRIPTION	DATE	BY	CHK	APP
RECEPTACLE ASSEMBLY, 20-14, REVERSE SEX, CPC				

DATE: 00779 DATE: 213928 DRAWING NO: A100779 Q=213928