

REV	DATE	DESCRIPTION
01	03/08/2005	INITIAL RELEASE

REV	DATE	DESCRIPTION	BY	CHK
01	03/08/2005	INITIAL RELEASE	JMM	LJF

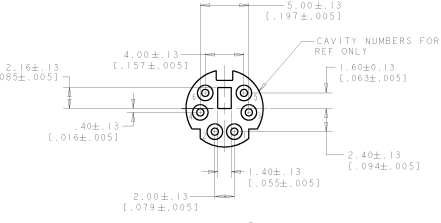

- △ RECEPTACLE CONTACTS: COPPER ALLOY.
- △ RECEPTACLE SHIELD: COPPER ALLOY.
- △ HOUSING: THERMOPLASTIC, BLACK, 94V-0 RATED.
- △ PLATING: RECEPTACLE CONTACTS - GOLD FLASH PLATED ON MATING END, MATTE-TIN PLATED .0030 MIN (.000120 MIN) THICK ON SOLDER TAIL ALL OVER .0013 MIN (.000050 MIN) THICK NICKEL.
- △ PLATING: SHIELD: PRE-TIN PLATED
- 4. RECEPTACLE ASSEMBLY MATES WITH 6 PIN 9.00 ± .10 (.354 ± .004) DIAMETER PLUG.
- △ DATUMS AND BASIC DIMENSION SUPPLIED BY CUSTOMER.

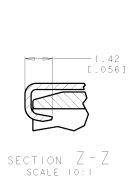
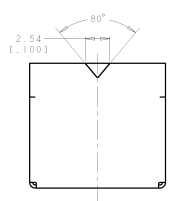
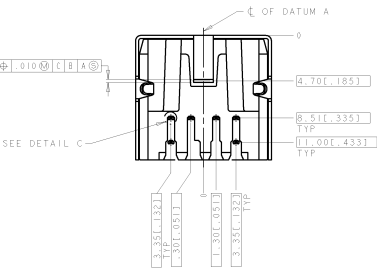
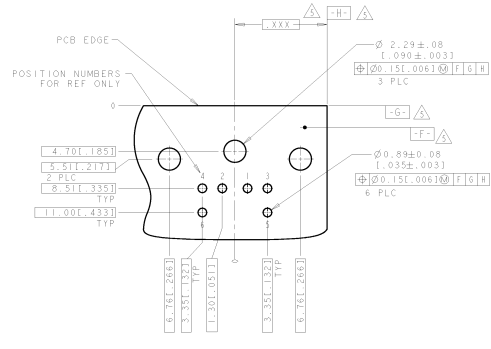
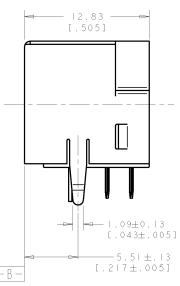
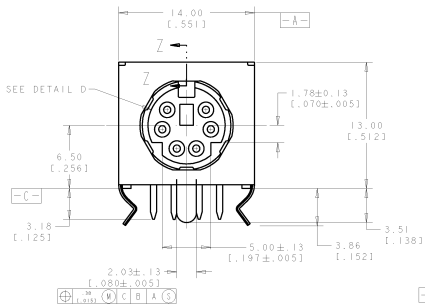

P/N: 5749231-1 AS SHOWN tyco Tyco Electronics Singapore Pte. Ltd.	
ORDERING INFORMATION: P/N: 5749231-1 P/N: 5749231-1 P/N: 5749231-1 P/N: 5749231-1	DATE: 03/20/2005 REV: 001 REV: 002 REV: 003 REV: 004 REV: 005 REV: 006 REV: 007 REV: 008 REV: 009 REV: 010
MATERIAL: THERMOPLASTIC, BLACK, 94V-0 RATED FINISH: COPPER ALLOY, GOLD FLASH PLATED, MATTE-TIN PLATED, NICKEL	TITLE: RECEPTACLE ASSY W/ HOLD DOWN, 6 POS., RIGHT ANGLE, MINIATURE CIRCULAR DIN CASE: 108-1225 REV: A1 DATE: 03/20/2005 DRAWN BY: JMM CHECKED BY: LJF