

REV.	DESCRIPTION	DATE
A	NEW DRAWING	3/1/2006

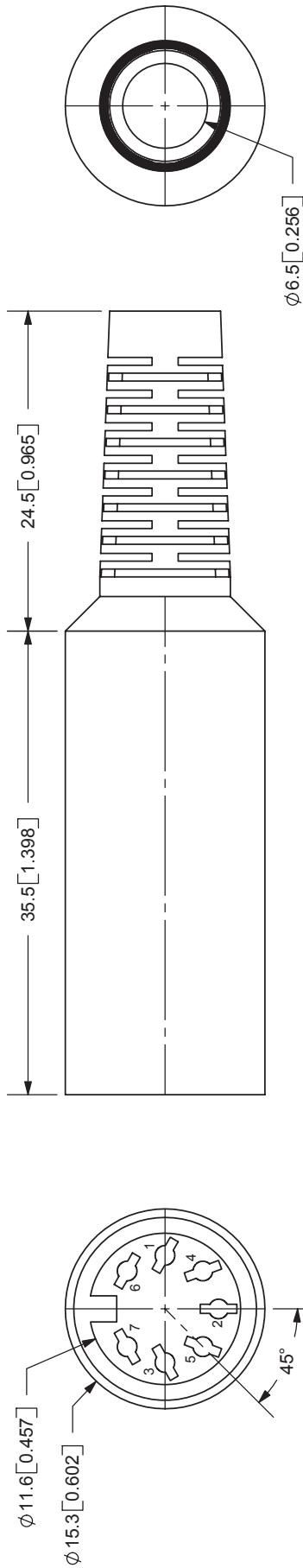

9615 SW Allen Blvd., Ste. 103
 Beaverton, OR 97005
 Phone: 503-643-4899
 800-275-4899
 Fax: 503-372-1266
 Website: www.cui.com

TOLERANCE:
 X.X ±0.1mm
 X.XX ±0.05mm

NOTES:
 RECOMMENDED WIRE RANGE: 24AWG~28AWG
SPECIFICATIONS:
 RATING: 100V AC @ 2A
 CONTACT RESISTANCE: PINS-10m OHMS MAX; SHELL-50m OHMS MAX
 INSULATION RESISTANCE: 100M OHMS MIN; 500V DC
 VOLTAGE WITHSTAND: 1000V AC R.M.S. FOR 1 MINUTE
 LIFE: 5,000 CYCLES
 OPERATING TEMP: -5° ~ +110°C

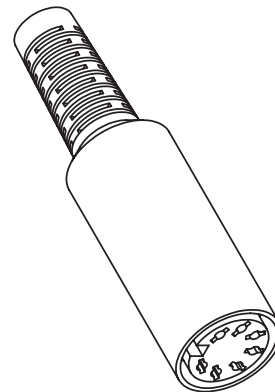

SCALE 1:1

TITLE:	IN-LINE RECEPTACLE	REV:	A
PART NO:	SD-70J	UNITS:	MM [INCHES]
DRAWN BY:	ZRJ	APPROVED BY:	
		SCALE:	2:1

	MATERIAL	PLATING
PINS	Brass	Silver
SHELL	Steel	Nickel
INSULATOR	PC	
BOOT	PVC	

PC FILE NAME: SD-70J

COPYRIGHT 2006 BY CUI INC.