

REV.	DESCRIPTION	DATE
A	NEW DRAWING	3/1/2006
B	Model update	9/26/2006

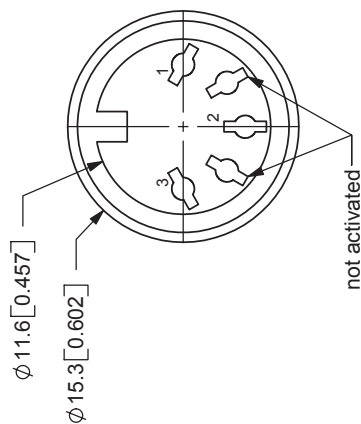

TOLERANCE:
X.X ±0.1mm
X.XX ±0.05mm

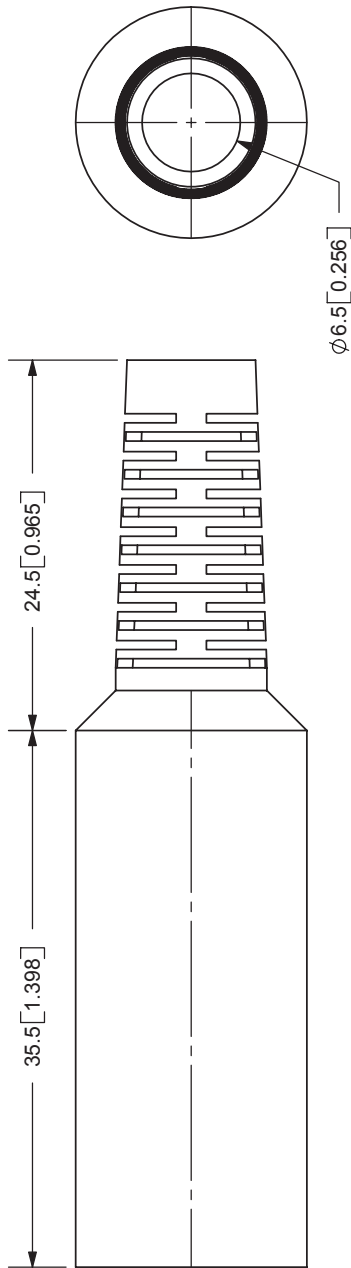

20050 SW 112th Ave.
Tualatin, OR 97062
Phone: 503-643-4899
800-275-4899
Fax: 503-372-1266
Website: www.cui.com

NOTES:
RECOMMENDED WIRE RANGE: 24AWG~28AWG

SPECIFICATIONS:
RATING: 100V AC @ 2A
CONTACT RESISTANCE: PINS-10m OHMS MAX; SHELL-50m OHMS MAX
INSULATION RESISTANCE: 100M OHMS MIN; 500V DC
VOLTAGE WITHSTAND: 1000V AC R.M.S. FOR 1 MINUTE
LIFE: 5,000 CYCLES
OPERATING TEMP: -5° ~ +110°C

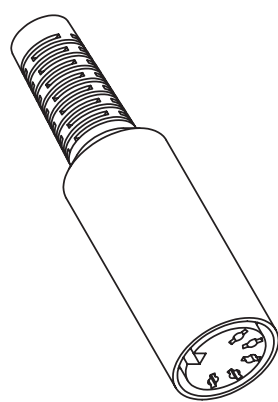

SCALE 1:1

TITLE: IN-LINE RECEPTACLE	REV: B
PART NO: SD-30J	UNITS: MM [INCHES]
DRAWN BY: ZRJ	APPROVED BY:
	SCALE: 2:1

PINS	MATERIAL	PLATING
SHELL	Brass	Silver
INSULATOR	Steel	Nickel
BOOT	PC	
	PVC	

PC FILE NAME: SD-30J

COPYRIGHT 2006 BY CUI INC.