

| REV. | DESCRIPTION | DATE |
|------|--|------------|
| A | NEW DRAWING | 12/5/2005 |
| B | Added pin dimensions | 5/4/2006 |
| C | housing material changed from PBT to LCP | 10/25/2010 |

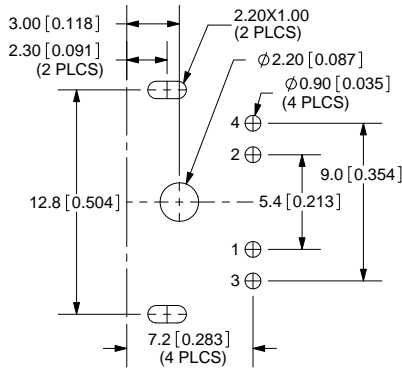

PCB LAYOUT
TOP VIEW

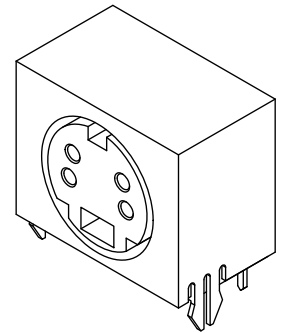
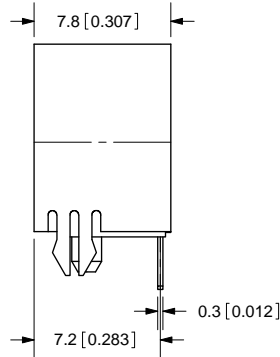
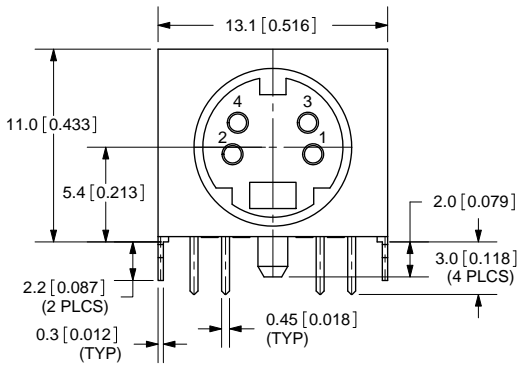
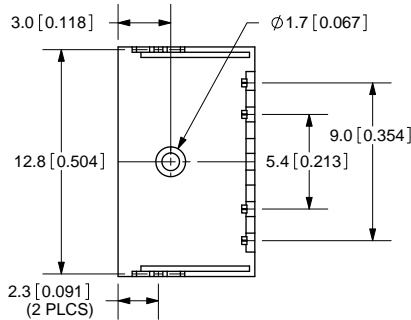

TOLERANCE:
X.X ±0.2mm
X.XX ±0.1mm
X.XXX ±0.05mm



SPECIFICATIONS:
 RATING: 12V DC @ 2A; 100V AC @ 1A
 CONTACT RESISTANCE: 30m OHMS MAX
 INSULATION RESISTANCE: 50M OHMS MIN; 250V DC
 VOLTAGE WITHSTAND: 250V AC R.M.S. FOR 1 MINUTE
 INSERTION FORCE: 4.5KG MAX
 WITHDRAWAL FORCE: 0.8KG-3.5KG
 LIFE: 5,000 CYCLES

| | MATERIAL | PLATING |
|-----------------|-----------------|---------|
| TERMINALS (1-4) | Phosphor Bronze | Silver |
| EARTH TERMINAL | Brass | Tin |
| HOUSING | LCP | |



20050 SW 112th Ave.
 Tualatin, OR 97062
 Phone: 503-612-2300
 800-275-4899
 Fax: 503-612-2383
 Website: www.cui.com

| | | |
|---|--------------------|------------|
| TITLE: MINIATURE CIRCULAR DIN CONNECTOR | | REV: C |
| PART NO. MD2-40ST | UNITS: MM [INCHES] | |
| DRAWN BY: ZRJ | APPROVED BY: | SCALE: 3:1 |

PC FILE NAME:
MD2-40ST

COPYRIGHT 2010 BY CUI INC.