

REV.	DESCRIPTION	DATE
A	NEW DRAWING	3/1/2006

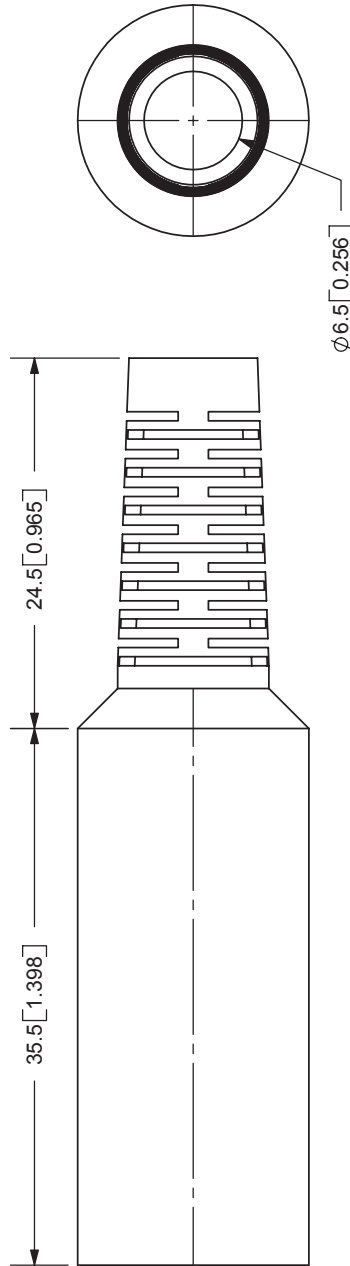

9615 SW Allen Blvd., Ste. 103  
 Beaverton, OR 97005  
 Phone: 503-643-4899  
 800-275-4899  
 Fax: 503-372-1266  
 Website: www.cui.com

TOLERANCE:  
 X.X ±0.1mm  
 X.XX ±0.05mm

NOTES:  
 RECOMMENDED WIRE RANGE: 24AWG~28AWG  
 SPECIFICATIONS:  
 RATING: 100V AC @ 2A  
 CONTACT RESISTANCE: PINS-10m OHMS MAX; SHELL-50m OHMS MAX  
 INSULATION RESISTANCE: 100M OHMS MIN: 500V DC  
 VOLTAGE WITHSTAND: 1000V AC R.M.S. FOR 1 MINUTE  
 LIFE: 5,000 CYCLES  
 OPERATING TEMP: -5° ~ +110°C

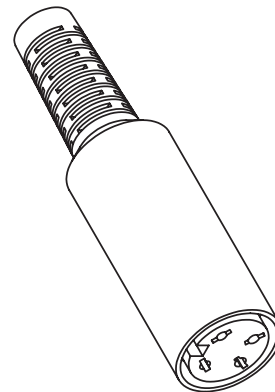

SCALE 1:1

TITLE: IN-LINE RECEPTACLE	REV: A
PART NO: SD-40J	UNITS: MM [INCHES]
DRAWN BY: ZRJ	APPROVED BY:
	SCALE: 2:1

PINS	MATERIAL	PLATING
SHELL	Brass	Silver
INSULATOR	Steel	Nickel
BOOT	PC	
	PVC	