

REVISIONS				
REV.	ECO. NO	DESCRIPTION	DATE	BY
A	1741	INITIAL RELEASE	3/7/2008	MNH

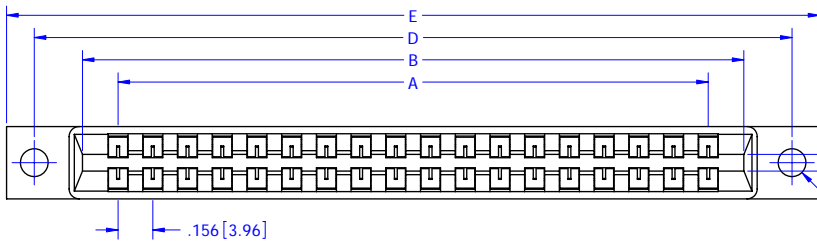

.075 [1.91]  
CARDSLOT

'H' MTG = 2X Ø.125 [3.18]  
'P' MTG = 2X Ø.142 [3.61]

.156 [3.96]

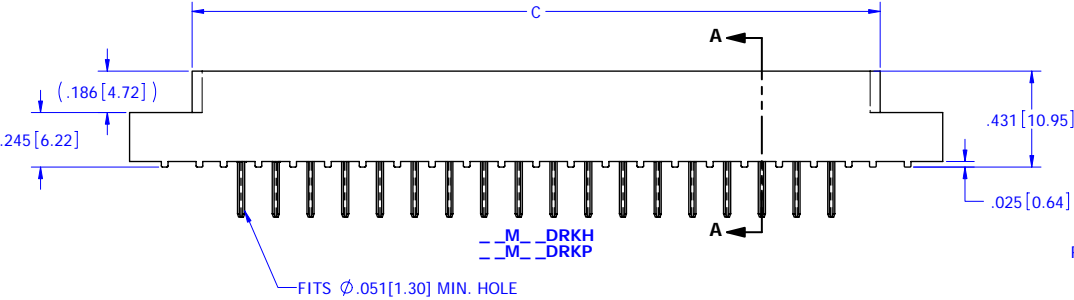

M\_DRKH  
M\_DRKP

FITS Ø.051 [1.30] MIN. HOLE

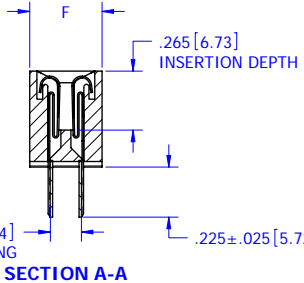

SECTION A-A

CONTACT MARKINGS  
(LETTERS G, I, O, & Q NOT USED)

SIZE 02 THRU 25:  
1 2 3 ... 23 24 ...  
A B C ... AA BB ...

SIZE 28 THRU 44:  
1 2 3 ... 23 24 ...  
A B C ... A B ...

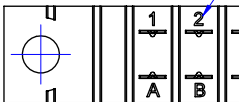

CONTACT ID  
SCALE 4:1

- NOTES:
- INSULATOR MATERIAL: SEE PART NUMBER CODING.
  - CONTACT MATERIAL: SEE PART NUMBER CODING.
  - PLATING: SEE PART NUMBER CODING.
  - TEMPERATURE: SEE PART NUMBER CODING.
  - PROCESSING TEMP: SEE PART NUMBER CODING.
  - UL FLAMMABILITY RATING: 94V-0.
  - VOLTAGE RATING: 1800 VDC MINIMUM AT SEA LEVEL.
  - CURRENT RATING: SEE PART NUMBER CODING.
  - VOLTAGE DROP: 30 MILLI VOLT AT RATED CURRENT.
  - INSULATION RESISTANCE: 5000 MEGA OHMS.
  - CONNECTOR IDENTIFICATION: THE PART SHALL BE MARKED WITH A PART NUMBER AND BARCODE.
  - BOARD THICKNESS ACCOMMODATED: .062 ± .008 [1.57 ± 0.20].
  - BOARD INSERTION FORCE: 16 OZ MAX PER CONTACT PAIR WHEN USING A .062 [1.57] TEST BLADE. INTERNAL INSPECTION TO BE PER SULLIN'S WORK INSTRUCTION W17.3-01.
  - BOARD WITHDRAWAL FORCE: 1 OUNCE MINIMUM PER CONTACT PAIR USING .062 [1.57] PCB.
  - MATERIAL COLOR VARIATIONS:
    - ADD -S38 TO END OF PART NUMBER FOR BLACK PBT (MATERIAL CODE E AND H ONLY).
    - ADD -S81 TO END OF PART NUMBER FOR GREEN PBT (MATERIAL CODE E AND H ONLY).
    - ADD -S328 TO END OF PART NUMBER FOR BROWN PPS (MATERIAL CODE R AND A ONLY).



RoHS COMPLIANT

UNLESS OTHERWISE SPECIFIED:  
DIMENSIONS ARE IN INCHES (MM)  
TOLERANCES:  
ANGULAR: ± .30°  
XX = ± .02 [ .508]  
XXX = ± .005 [ .127]  
XXXX = ± .0005 [ .0127]  
SURFACE FINISH: 63 Rm  
REMOVE ALL BURRS AND SHARP EDGES .010 MAX  
INTERPRET DIMENSIONS AND GEOMETRIC TOLERANCING PER: ANSI Y14.5M-1994

CUSTOMER COPY

DATE	NAME	
	MNH	
THE INFORMATION HEREIN CONTAINS PROPRIETARY INFORMATION OF SULLINS ELECTRONICS AND IS NOT TO BE REPRODUCED, USED OR DISCLOSED TO OTHERS FOR ANY PURPOSE EXCEPT AS SPECIFICALLY AUTHORIZED IN WRITING BY AN OFFICER OF SULLINS ELECTRONICS.		
DESCRIPTION: EDGE CARD, .156 CC, LP		
PART NUMBER: M_DRK		
SIZE: C	DWG. NO.: C11120	REV: A
SCALE: 3:1		SHEET 1 OF 3

8 7 6 5 4 3 2 1

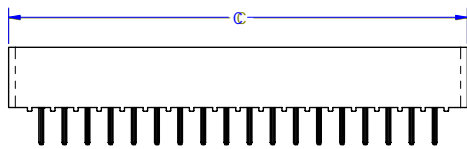
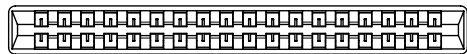

--M--DRKN

2X #4-40  
THREADED  
INSERTS

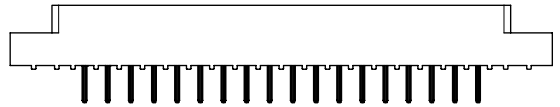
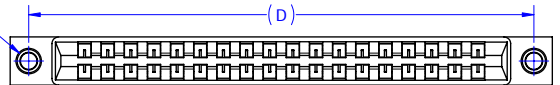

--M--DRKI

2X FLOATING BOBBIN  
Ø.116 [2.95] CLEARANCE  
FOR # 4 SCREW

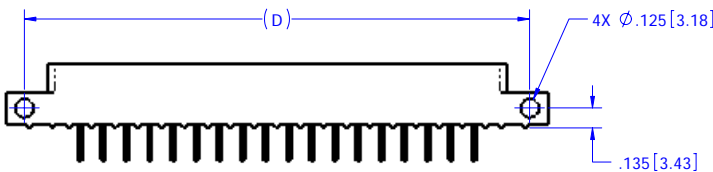

--M--DRKS

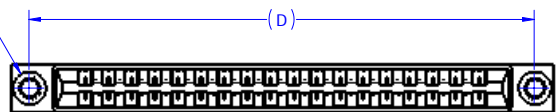

--M--DRKF

**CUSTOMER COPY**



RoHS COMPLIANT

UNLESS OTHERWISE SPECIFIED:  
DIMENSIONS ARE IN INCHES(MM)  
TOLERANCES:  
ANGULAR: ± .30°  
XX- ± .02 [ .508]  
XXX- ± .005 [ .1270]  
XXXX- ± .0005 [ .0127]  
SURFACE FINISH: 63 Ra  
REMOVE ALL BURRS AND SHARP EDGES .010 MAX  
INTERPRET DIMENSIONS AND GEOMETRIC  
TOLERANCING  
PER: ANSI Y14.5M-1994

DATE	NAME
	MNH

THE INFORMATION HEREIN CONTAINS  
PROPERTY INFORMATION OF  
SULLINS ELECTRONICS AND IS NOT  
TO BE REPRODUCED, USED OR  
DISCLOSED TO OTHERS FOR ANY  
PURPOSE EXCEPT AS SPECIFICALLY  
AUTHORIZED IN WRITING BY AN  
OFFICER OF SULLINS ELECTRONICS.

<b>SULLINS</b> CONNECTOR SOLUTIONS	
DESCRIPTION: EDGE CARD, .156 CC, LP	
PART NUMBER: M_DRK	
SIZE: C	DWG. NO.: C11120
SCALE: 2:1	REV: A
SHEET 2 OF 3	

PART NUMBER	NO. OF POS.	A ± .008[0.20]		B ± .008[0.20]		C ± .015[0.38]		D ± .010[0.25]		E ± .020[0.51]		E ± .020[0.51]		F ± .005[0.13]	
		IN	MM	IN	MM	IN	MM	IN	MM	IN	MM	IN	MM	IN	MM
		"N" MOUNTING													
M02DRKN	2	0.156	3.96	0.476	12.09	0.596	15.14								
M03DRKN	3	0.312	7.92	0.632	16.05	0.752	19.10								
M06DRK	6	0.780	19.81	1.100	27.94	1.220	30.99	1.533	38.94	1.782	45.26	1.882	47.80		
M08DRK	8	1.092	27.74	1.412	35.86	1.532	38.91	1.845	46.86	2.094	53.19	2.194	55.73		
M10DRK	10	1.404	35.66	1.724	43.79	1.844	46.84	2.157	54.79	2.406	61.11	2.506	63.65		
M11DRK	11	1.560	39.62	1.880	47.75	2.000	50.80	2.313	58.75	2.562	65.07	2.662	67.61	0.325	8.26
M12DRK	12	1.716	43.59	2.036	51.71	2.156	54.76	2.469	62.71	2.718	69.04	2.818	71.58		
M15DRK	15	2.184	55.47	2.504	63.60	2.624	66.65	2.937	74.60	3.186	80.92	3.286	83.46		
M18DRK	18	2.652	67.36	2.972	75.49	3.092	78.54	3.405	86.49	3.654	92.81	3.754	95.35		
M22DRK	22	3.276	83.21	3.596	91.34	3.716	94.39	4.029	102.34	4.278	108.66	4.378	111.20		
M24DRK	24	3.588	91.14	3.908	99.26	4.028	102.31	4.341	110.26	4.590	116.59	4.690	119.13		
M25DRK	25	3.744	95.10	4.064	103.23	4.184	106.27	4.497	114.22	4.746	120.55	4.846	123.09		
M28DRK	28	4.212	106.98	4.532	115.11	4.652	118.16	4.965	126.11	5.214	132.44	5.314	134.98	0.438	11.13
M36DRK	36	5.460	138.68	5.780	146.81	5.900	149.86	6.213	157.81	6.462	164.13	6.562	166.67		
M43DRK	43	6.552	166.42	6.872	174.55	6.992	177.60	7.305	185.55	7.554	191.87	7.654	194.41	0.500	12.70
M44DRK	44	6.708	170.38	7.028	178.51	7.148	181.56	7.461	189.51	7.710	195.83	7.810	198.37		

Only applies for PPS/PEEK inRTIators with threaded inRTIs or floats

PART NUMBER CODING

M DRK

MATERIAL (INSULATOR/CONTACT)

E = PBT/PHOSPHOR BRONZE

OPERATING TEMP: -65°C TO +125°C @ 3 AMPS PER CONTACT  
OPERATING TEMP: -65°C TO +21°C @ 5 AMPS PER CONTACT  
PROCESSING TEMP: 260°C FOR 10 SECS MAX

R = PPS/PHOSPHOR BRONZE

OPERATING TEMP: -65°C TO +125°C  
PROCESSING TEMP: 260°C FOR 120 SECS MAX  
CURRENT RATING PER CONTACT: 5 AMPS

G = PA9T/PHOSPHOR BRONZE

OPERATING TEMP: -65°C TO +125°C  
PROCESSING TEMP: 260°C FOR 120 SECS MAX  
CURRENT RATING PER CONTACT: 5 AMPS

H = PBT/BERYLLIUM COPPER

OPERATING TEMP: -65°C TO +125°C @ 3 AMPS PER CONTACT  
OPERATING TEMP: -65°C TO +105°C @ 5 AMPS PER CONTACT  
PROCESSING TEMP: 260°C FOR 10 SECS MAX

A = PPS/BERYLLIUM COPPER

OPERATING TEMP: -65°C TO +150°C  
PROCESSING TEMP: 260°C FOR 120 SECS MAX  
CURRENT RATING PER CONTACT: 5 AMPS

J = PA9T/BERYLLIUM COPPER

OPERATING TEMP: -65°C TO +150°C  
PROCESSING TEMP: 260°C FOR 120 SECS MAX  
CURRENT RATING PER CONTACT: 5 AMPS

F = PPS/SPINODAL (CONSULT FACTORY)

AVAILABLE IN OVERALL GOLD ONLY (S OR M PLATING CODE)  
OPERATING TEMP: -65°C TO +200°C  
PROCESSING TEMP: 260°C FOR 120 SECS MAX  
CURRENT RATING PER CONTACT: 3 AMPS

C = PPS/BERYLLIUM COPPER (CONSULT FACTORY)

AVAILABLE IN OVERALL GOLD ONLY (S OR M PLATING CODE)  
OPERATING TEMP: -65°C TO +200°C @ 2 AMPS PER CONTACT  
OPERATING TEMP: -65°C TO +173°C @ 3 AMPS PER CONTACT  
PROCESSING TEMP: 260°C FOR 120 SECS MAX

W = PEEK/BERYLLIUM COPPER (CONSULT FACTORY)

AVAILABLE IN OVERALL GOLD ONLY (S OR M PLATING CODE)  
OPERATING TEMP: -65°C TO +250°C  
CURRENT RATING PER CONTACT: 3 AMPS  
(CONSULT FACTORY FOR OTHER MATERIALS)

MOUNTING STYLE

H = .125" DIA. CLEARANCE HOLES (PAGE 1)

N = NO MOUNTING EARS (PAGE 2)

S = .125" DIA. SIDE MOUNTING (PAGE 2)

I = #4-40 THREADED INSERT (PAGE 2)

F = FLOATING BOBBIN (PAGE 2)

P = .142" DIA. CLEARANCE HOLES (PAGE 1)

NUMBER OF POSITIONS (CONTACTS PER ROW)

PLATING

ALL PLATINGS ARE LEAD FREE AND HAVE .000050" NICKEL UNDERPLATE

CONTACT SURFACE

G = .000010" GOLD

Y = .000030" GOLD

B = .000010" GOLD

C = .000030" GOLD

\*\* E = .000100" PURE TIN, MATTE, OVERALL

S = .000010" GOLD OVERALL

M = .000030" GOLD

.000010" GOLD OVERALL

\*\* OVERALL TIN ONLY AVAILABLE ON MATERIAL CODES E, R AND G



RoHS COMPLIANT

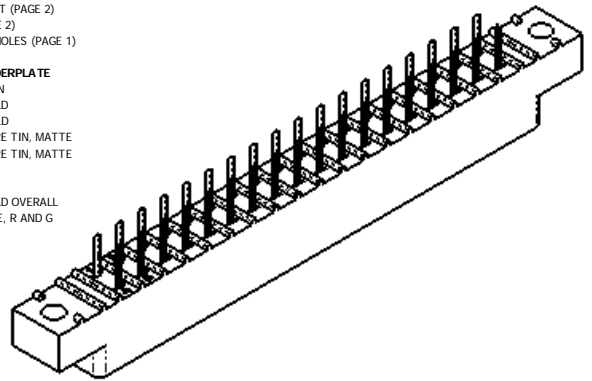

CUSTOMER COPY

UNLESS OTHERWISE SPECIFIED:  
DIMENSIONS ARE IN INCHES(MM)  
TOLERANCES:  
ANGULAR: ± .30°  
XX = ± .02 [ .508]  
XXX = ± .005 [ .127]  
XXXX = ± .0005 [ .0127]  
SURFACE FINISH: 63 Ra  
REMOVE ALL BURRS AND SHARP EDGES: 010 MAX

DATE	NAME
	MNH



DESCRIPTION: EDGE CARD, .156 CC, LP

PART NUMBER: M DRK

SIZE: C DWG. NO.: C11120

SCALE: 3:1

SHEET 3 OF 3