

.039" [1.00MM] CONTACT CENTERS

FEATURES

- * Accommodates .062 + - .008" PC board (Consult factory for other board thicknesses)
- * PPS or PCT insulator
- * Molded-in key available
- * 1 amp current rating
- * Highly reliable high cycle hairpin bellow contacts
- * 150 grams normal force minimum

READOUT

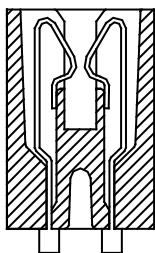

DUAL (D)

TERMINATION TYPE

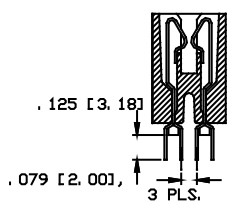

STAGGERED DIP SOLDER (HH)

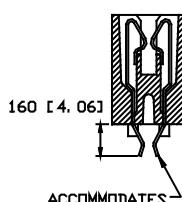

CARD EXTENDER (HR)

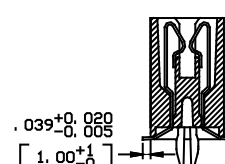

SURFACE MOUNT (HF)

P.C.B. LAYOUTS

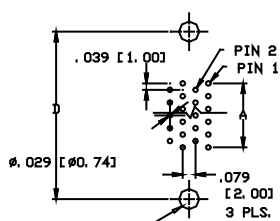

CONNECTOR SIDE

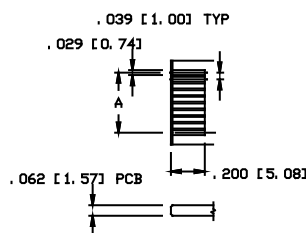

SOLDER END

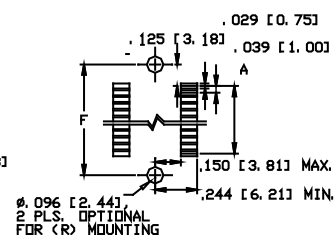

CONNECTOR SIDE

MOUNTING STYLE

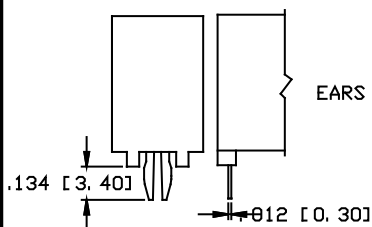

BOARD LOCK (R)

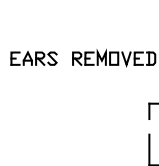

NO MOUNTING EARS (N)

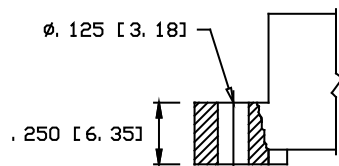

FLUSH MOUNTING (D)

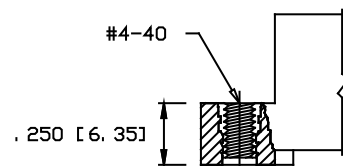

THREADED INSERT (T)

DIP SOLDER/CARD EXTENDER/SMT EDGE CARD CONNECTORS

PART NUMBER CODING

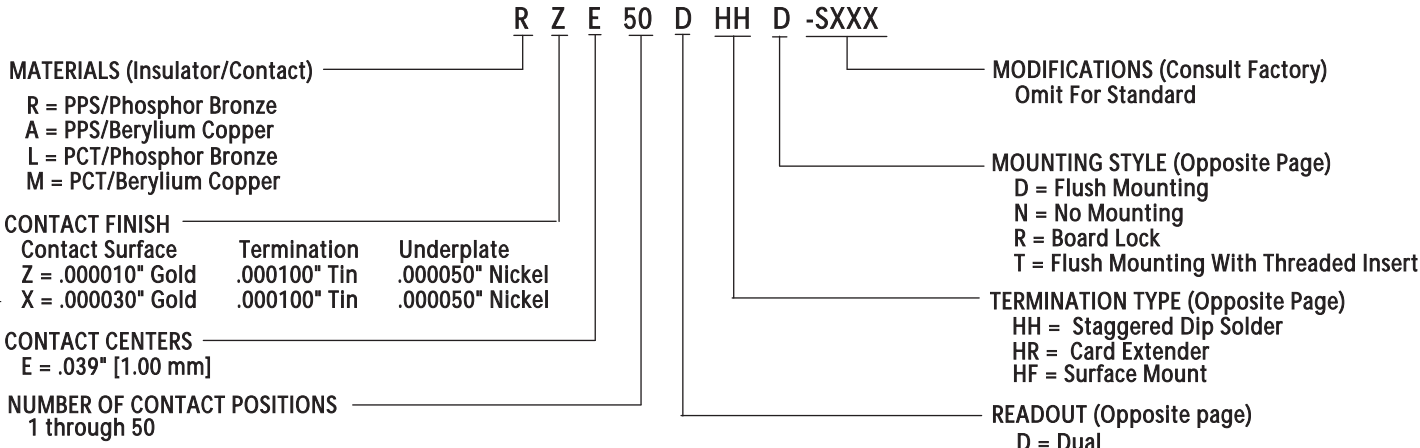

DIMENSIONS

Dimensions in [] are in millimeters, all others in inches.

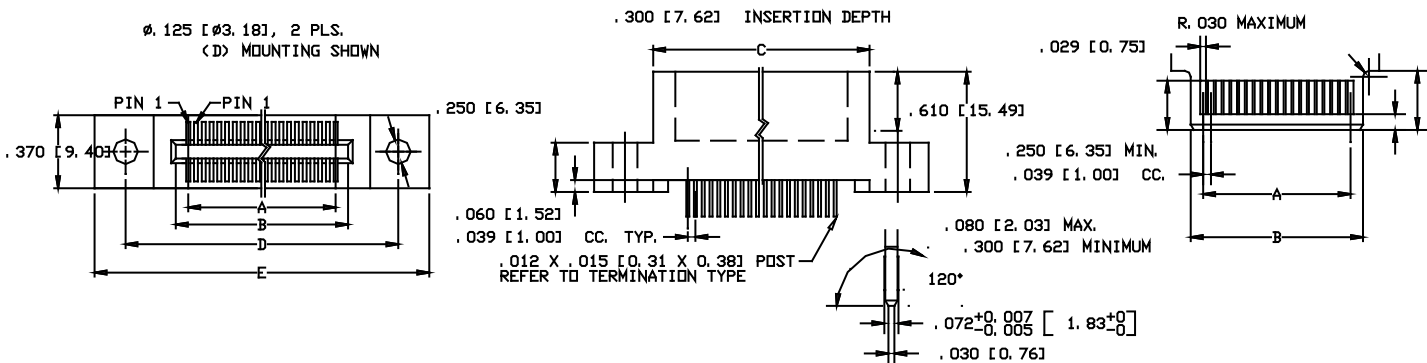

PART NUMBER	NUMBER OF CONTACTS	INCH										MM			
		A +- .005	B+.005-.000	C+-.015	D+-.010	E+-.020	F+-.010	A +- .13	B+.13-.00	C+-.38	D+-.25	E+-.51	F+-.25		
RZE01D	1/2	0.000	0.126	0.350	0.636	0.950	0.250	0.00	3.20	8.89	16.15	24.13	6.35		
RZE02D	2/4	0.039	0.165	0.389	0.675	0.989	0.289	1.00	4.20	9.89	17.15	25.13	7.35		
RZE03D	3/6	0.079	0.205	0.429	0.715	1.029	0.329	2.00	5.20	10.89	18.15	26.13	8.35		
RZE04D	4/8	0.118	0.244	0.468	0.754	1.068	0.368	3.00	6.20	11.89	19.15	27.13	9.35		
RZE05D	5/10	0.157	0.283	0.507	0.793	1.107	0.407	4.00	7.20	12.89	20.15	28.13	10.35		
RZE06D	6/12	0.197	0.323	0.547	0.833	1.147	0.447	5.00	8.20	13.89	21.15	29.13	11.35		
RZE07D	7/14	0.236	0.362	0.586	0.872	1.186	0.486	6.00	9.20	14.89	22.15	30.13	12.35		
RZE08D	8/16	0.276	0.402	0.626	0.912	1.226	0.526	7.00	10.20	15.89	23.15	31.13	13.35		
RZE09D	9/18	0.315	0.441	0.665	0.951	1.265	0.565	8.00	11.20	16.89	24.15	32.13	14.35		
RZE10D	10/20	0.354	0.480	0.704	0.990	1.304	0.604	9.00	12.20	17.89	25.15	33.13	15.35		
RZE11D	11/22	0.394	0.520	0.744	1.030	1.344	0.644	10.00	13.20	18.89	26.15	34.13	16.35		
RZE12D	12/24	0.433	0.559	0.783	1.069	1.383	0.683	11.00	14.20	19.89	27.15	35.13	17.35		
RZE13D	13/26	0.472	0.598	0.822	1.108	1.422	0.722	12.00	15.20	20.89	28.15	36.13	18.35		
RZE14D	14/18	0.512	0.638	0.862	1.148	1.462	0.762	13.00	16.20	21.89	29.15	37.13	19.35		
RZE15D	15/30	0.551	0.677	0.901	1.187	1.501	0.801	14.00	17.20	22.89	30.15	38.13	20.35		
RZE16D	16/32	0.591	0.717	0.941	1.227	1.541	0.841	15.00	18.20	23.89	31.15	39.13	21.35		
RZE17D	17/34	0.630	0.756	0.980	1.266	1.580	0.880	16.00	19.20	24.89	32.15	40.13	22.35		
RZE18D	18/36	0.669	0.795	1.019	1.305	1.619	0.919	17.00	20.20	25.89	33.15	41.13	23.35		
RZE19D	19/38	0.709	0.835	1.059	1.345	1.659	0.959	18.00	21.20	26.89	34.15	42.13	24.35		
RZE20D	20/40	0.748	0.874	1.098	1.384	1.698	0.998	19.00	22.20	27.89	35.15	43.13	25.35		
RZE21D	21/42	0.787	0.913	1.137	1.423	1.737	1.037	20.00	23.20	28.89	36.15	44.13	26.35		
RZE22D	22/44	0.827	0.953	1.177	1.463	1.777	1.077	21.00	24.20	29.89	37.15	45.13	27.35		
RZE23D	23/46	0.866	0.992	1.216	1.502	1.816	1.116	22.00	25.20	30.89	38.15	46.13	28.35		
RZE24D	24/48	0.906	1.032	1.256	1.542	1.856	1.156	23.00	26.20	31.89	39.15	47.13	29.35		
RZE25D	25/50	0.945	1.071	1.295	1.581	1.895	1.195	24.00	27.20	32.89	40.15	48.13	30.35		
RZE26D	26/52	0.984	1.110	1.334	1.620	1.934	1.234	25.00	28.20	33.89	41.15	49.13	31.35		
RZE27D	27/54	1.024	1.150	1.374	1.660	1.974	1.274	26.00	29.20	34.89	42.15	50.13	32.35		
RZE28D	28/56	1.063	1.189	1.413	1.699	2.013	1.313	27.00	30.20	35.89	43.15	51.13	33.35		
RZE29D	29/58	1.102	1.228	1.452	1.738	2.052	1.352	28.00	31.20	36.89	44.15	52.13	34.35		
RZE30D	30/60	1.142	1.268	1.492	1.778	2.092	1.392	29.00	32.20	37.89	45.15	53.13	35.35		
RZE31D	31/62	1.181	1.307	1.531	1.817	2.131	1.431	30.00	33.20	38.89	46.15	54.13	36.35		
RZE32D	32/64	1.220	1.346	1.570	1.856	2.170	1.470	31.00	34.20	39.89	47.15	55.13	37.35		
RZE33D	33/66	1.260	1.386	1.610	1.896	2.210	1.510	32.00	35.20	40.89	48.15	56.13	38.35		
RZE34D	34/68	1.299	1.425	1.649	1.935	2.249	1.549	33.00	36.20	41.89	49.15	57.13	39.35		
RZE35D	35/70	1.339	1.465	1.689	1.975	2.289	1.589	34.00	37.20	42.89	50.15	58.13	40.35		
RZE36D	36/72	1.378	1.504	1.728	2.014	2.328	1.628	35.00	38.20	43.89	51.15	59.13	41.35		
RZE37D	37/74	1.417	1.543	1.767	2.053	2.367	1.667	36.00	39.20	44.89	52.15	60.13	42.35		
RZE38D	38/76	1.457	1.583	1.807	2.093	2.407	1.707	37.00	40.20	45.89	53.15	61.13	43.35		
RZE39D	39/78	1.496	1.622	1.846	2.132	2.446	1.746	38.00	41.20	46.89	54.15	62.13	44.35		
RZE40D	40/80	1.535	1.661	1.885	2.171	2.485	1.785	39.00	42.20	47.89	55.15	63.13	45.35		
RZE41D	41/82	1.575	1.701	1.925	2.211	2.525	1.825	40.00	43.20	48.89	56.15	64.13	46.35		
RZE42D	42/84	1.614	1.740	1.964	2.250	2.564	1.864	41.00	44.20	49.89	57.15	65.13	47.35		
RZE43D	43/86	1.654	1.780	2.004	2.290	2.604	1.904	42.00	45.20	50.89	58.15	66.13	48.35		
RZE44D	44/88	1.693	1.819	2.043	2.329	2.643	1.943	43.00	46.20	51.89	59.15	67.13	49.35		
RZE45D	45/90	1.732	1.858	2.082	2.368	2.682	1.982	44.00	47.20	52.89	60.15	68.13	50.35		
RZE46D	46/92	1.772	1.898	2.122	2.408	2.722	2.022	45.00	48.20	53.89	61.15	69.13	51.35		
RZE47D	47/94	1.811	1.937	2.161	2.447	2.761	2.061	46.00	49.20	54.89	62.15	70.13	52.35		
RZE48D	48/96	1.850	1.976	2.200	2.486	2.800	2.100	47.00	50.20	55.89	63.15	71.13	53.35		
RZE49D	49/98	1.890	2.016	2.240	2.526	2.840	2.140	48.00	51.20	56.89	64.15	72.13	54.35		
RZE50D	50/100	1.929	2.055	2.279	2.565	2.879	2.179	49.00	52.20	57.89	65.15	73.13	55.35		

* Contact Factory for Other Positions