

--- C --- DRSH

| REVISIONS |         |                                 |           |    |
|-----------|---------|---------------------------------|-----------|----|
| REV.      | ECO. NO | DESCRIPTION                     | DATE      | BY |
| A         | 1323    | INITIAL RELEASE                 | 3/28/2007 | SB |
| B         | 1695    | CHANGING OF NOTES AND TOLERANCE | 5/16/2008 | IA |

- NOTES:
1. INSULATOR MATERIAL: SEE PART NUMBER CODING.
  2. CONTACT MATERIAL: SEE PART NUMBER CODING.
  3. PLATING: SEE PART NUMBER CODING.
  4. OPERATING TEMPERATURE RATING: SEE PART NUMBER CODING.
  5. PROCESSING TEMPERATURE: SEE PART NUMBER CODING.
  6. UL FLAMABILITY RATING: 94V-0.
  7. VOLTAGE RATING: 600 VDC MIN. AT SEA LEVEL.
  8. CURRENT RATING: 3 AMP, PER CONTACT.
  9. VOLTAGE DROP: 30 MILLIVOLT AT RATED CURRENT.
  10. INSULATION RESISTANCE: 5000 MEGOHMS.
  11. CONNECTOR IDENTIFICATION: PART SHALL BE MARKED WITH PART NUMBER AND BARCODE.
  12. ACCOMMODATES BOARD THICKNESS: .062 ± .008" [1.57 ± 0.20].
  13. INSERTION FORCE: 16 OZ MAX PER CONTACT PAIR WHEN USING A .062" [1.57mm] TEST BLADE. INTERNAL INSPECTION TO BE PER SULLIN'S WORK INSTRUCTION W17.3-01.
  14. BOARD WITHDRAWAL FORCE: 1 Oz MIN. PER CONTACT PAIR USING .062" [1.57mm] PCB TEST BLADE.



RoHS COMPLIANT

CUSTOMER COPY

|  |  |  |              |
|--|--|--|--------------|
| UNLESS OTHERWISE SPECIFIED:<br>DIMENSIONS ARE IN INCHES(MM)<br>TOLERANCES:<br>ANGULAR: ± .01<br>XX-# .02 [ .508]<br>XXX-# .005 [ .127]<br>XXXX-# .0005 [ .0127]<br>SURFACE FINISH: 63 Rfz<br>REMOVE ALL BURRS AND SHARP EDGES .010 MAX |  | DATE: 3-27-07<br>NAME: MNH   |              |
| INTERPRET DIMENSIONS AND GEOMETRIC TOLERANCING PER: ANSI Y14.5M-1994   |  | DESCRIPTION: EDGE CARD, .100 CC, HP<br>PART NUMBER: --- C --- DRS ---<br>SIZE: C<br>DWG. NO.: C10922<br>REV: B |              |
| SCALE: 2:1   |  |  | SHEET 1 OF 3 |

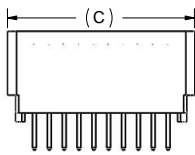
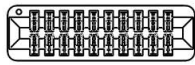

--- C --- DRSN

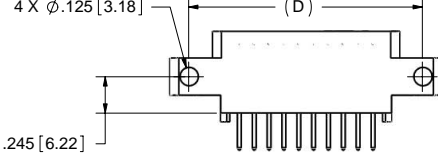
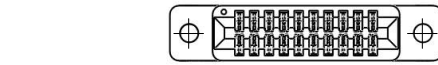

--- C --- DRSS

2X #4-40 THREADED INSERTS

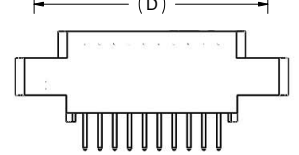
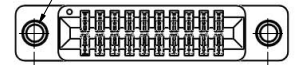

--- C --- DRSI

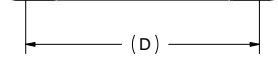
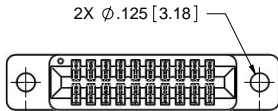

--- C --- DRSD

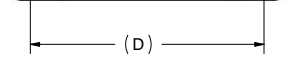
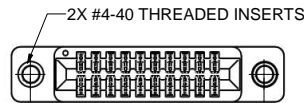

--- C --- DRST

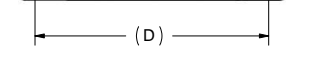
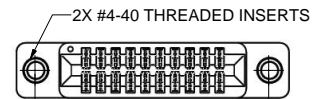

--- C --- DRX

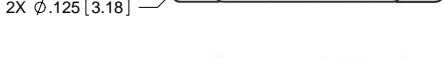
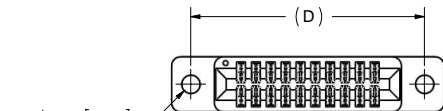

--- C --- DRSW



RoHS COMPLIANT

### CUSTOMER COPY

UNLESS OTHERWISE SPECIFIED:  
 DIMENSIONS ARE IN INCHES(MM)  
 TOLERANCES:  
 ANGULAR: ± .30°  
 XX = ± .02 [ .508]  
 XXX = ± .005 [ .127]  
 XXXX = ± .0005 [ .0127]  
 SURFACE FINISH: 63 Ra  
 REMOVE ALL BURRS AND SHARP EDGES .010 MAX  
 INTERPRET DIMENSIONS AND GEOMETRIC TOLERANCING PER: ANSI Y14.5M-1994

| DATE    | NAME |
|---------|------|
| 3-27-07 | MNH  |



DESCRIPTION: EDGE CARD, .100 CC, HP

PART NUMBER: --- C --- DRS ---

SIZE: C DWG. NO. C10922

SCALE: 2:1 SHEET 2 OF 3

| NO. OF POSITIONS | POSITIONS | A±.008[±0.20] |        | B±.008[±0.20] |        | C±.015[±0.38] |        | D±.010[±0.25] |        | E±.020[±0.51] |        | F±.015[±0.38] |        |
|------------------|-----------|---------------|--------|---------------|--------|---------------|--------|---------------|--------|---------------|--------|---------------|--------|
|                  |           | INCH          | MM     | INCH          | MM     | INCH          | MM     | INCH          | MM     | INCH          | MM     | INCH          | MM     |
| C06DRS           | 6         | 0.500         | 12.70  | 0.700         | 17.78  | 0.860         | 21.84  | 1.175         | 29.85  | 1.435         | 36.45  | 0.750         | 19.05  |
| C07DRS           | 7         | 0.600         | 15.24  | 0.800         | 20.32  | 0.960         | 24.38  | 1.275         | 32.39  | 1.535         | 38.99  | 0.850         | 21.59  |
| C08DRS           | 8         | 0.700         | 17.78  | 0.900         | 22.86  | 1.060         | 26.92  | 1.375         | 34.93  | 1.635         | 41.53  | 0.950         | 24.13  |
| C10DRS           | 10        | 0.900         | 22.86  | 1.100         | 27.94  | 1.260         | 32.00  | 1.575         | 40.01  | 1.835         | 46.61  | 1.150         | 29.21  |
| C12DRS           | 12        | 1.100         | 27.94  | 1.300         | 33.02  | 1.460         | 37.08  | 1.775         | 45.09  | 2.035         | 51.69  | 1.350         | 34.29  |
| C13DRS           | 13        | 1.200         | 30.48  | 1.400         | 35.56  | 1.560         | 39.62  | 1.875         | 47.63  | 2.135         | 54.23  | 1.450         | 36.83  |
| C15DRS           | 15        | 1.400         | 35.56  | 1.600         | 40.64  | 1.760         | 44.70  | 2.075         | 52.71  | 2.335         | 59.31  | 1.650         | 41.91  |
| C17DRS           | 17        | 1.600         | 40.64  | 1.800         | 45.72  | 1.960         | 49.78  | 2.275         | 57.79  | 2.535         | 64.39  | 1.850         | 46.99  |
| C18DRS           | 18        | 1.700         | 43.18  | 1.900         | 48.26  | 2.060         | 52.32  | 2.375         | 60.33  | 2.635         | 66.93  | 1.950         | 49.53  |
| C20DRS           | 20        | 1.900         | 48.26  | 2.100         | 53.34  | 2.260         | 57.40  | 2.575         | 65.41  | 2.835         | 72.01  | 2.150         | 54.61  |
| C22DRS           | 22        | 2.100         | 53.34  | 2.300         | 58.42  | 2.460         | 62.48  | 2.775         | 70.49  | 3.035         | 77.09  | 2.350         | 59.69  |
| C24DRS           | 24        | 2.300         | 58.42  | 2.500         | 63.50  | 2.660         | 67.56  | 2.975         | 75.57  | 3.235         | 82.17  | 2.550         | 64.77  |
| C25DRS           | 25        | 2.400         | 60.96  | 2.600         | 66.04  | 2.760         | 70.10  | 3.075         | 78.11  | 3.335         | 84.71  | 2.650         | 67.31  |
| C28DRS           | 28        | 2.700         | 68.58  | 2.900         | 73.66  | 3.060         | 77.72  | 3.375         | 85.73  | 3.635         | 92.33  | 2.950         | 74.93  |
| C29DRS           | 29        | 2.800         | 71.12  | 3.000         | 76.20  | 3.160         | 80.26  | 3.475         | 88.27  | 3.735         | 94.87  | 3.050         | 77.47  |
| C30DRS           | 30        | 2.900         | 73.66  | 3.100         | 78.74  | 3.260         | 82.80  | 3.575         | 90.81  | 3.835         | 97.41  | 3.150         | 80.01  |
| C31DRS           | 31        | 3.000         | 76.20  | 3.200         | 81.28  | 3.360         | 85.34  | 3.675         | 93.35  | 3.935         | 99.95  | 3.250         | 82.55  |
| C35DRS           | 35        | 3.400         | 86.36  | 3.600         | 91.44  | 3.760         | 95.50  | 4.075         | 103.51 | 4.335         | 110.11 | 3.650         | 92.71  |
| C36DRS           | 36        | 3.500         | 88.90  | 3.700         | 93.98  | 3.860         | 98.04  | 4.175         | 106.05 | 4.435         | 112.65 | 3.750         | 95.25  |
| C40DRS           | 40        | 3.900         | 99.06  | 4.100         | 104.14 | 4.260         | 108.20 | 4.575         | 116.21 | 4.835         | 122.81 | 4.150         | 105.41 |
| C43DRS           | 43        | 4.200         | 106.68 | 4.400         | 111.76 | 4.560         | 115.82 | 4.875         | 123.83 | 5.135         | 130.43 | 4.450         | 113.03 |
| C44DRS           | 44        | 4.300         | 109.22 | 4.500         | 114.30 | 4.660         | 118.36 | 4.975         | 126.37 | 5.235         | 132.97 | 4.550         | 115.57 |
| C49DRS           | 49        | 4.800         | 121.92 | 5.000         | 127.00 | 5.160         | 131.06 | 5.475         | 139.07 | 5.735         | 145.67 | 5.050         | 128.27 |
| C50DRS           | 50        | 4.900         | 124.46 | 5.100         | 129.54 | 5.260         | 133.60 | 5.575         | 141.61 | 5.835         | 148.21 | 5.150         | 130.81 |
| C55DRS           | 55        | 5.400         | 137.16 | 5.600         | 142.24 | 5.760         | 146.30 | 6.075         | 154.31 | 6.335         | 160.91 | 5.650         | 143.51 |
| C60DRS           | 60        | 5.900         | 149.86 | 6.100         | 154.94 | 6.260         | 159.00 | 6.575         | 167.01 | 6.835         | 173.61 | 6.150         | 156.21 |
| C61DRS           | 61        | 6.000         | 152.40 | 6.200         | 157.48 | 6.360         | 161.54 | 6.675         | 169.55 | 6.935         | 176.15 | 6.250         | 158.75 |
| C65DRS           | 65        | 6.400         | 162.56 | 6.600         | 167.64 | 6.760         | 171.70 | 7.075         | 179.71 | 7.335         | 186.31 | 6.650         | 168.91 |
| C70DRS           | 70        | 6.900         | 175.26 | 7.100         | 180.34 | 7.260         | 184.40 | 7.575         | 192.41 | 7.835         | 199.01 | 7.150         | 181.61 |
| C80DRS           | 80        | 7.900         | 200.66 | 8.100         | 205.74 | 8.260         | 209.80 | 8.575         | 217.81 | 8.835         | 224.41 | 8.150         | 207.01 |
| C90DRS           | 90        | 8.900         | 226.06 | 9.100         | 231.14 | 9.260         | 235.20 | 9.575         | 243.21 | 9.835         | 249.81 | 9.150         | 232.41 |
| C100DRS          | 100       | 9.900         | 251.46 | 10.100        | 256.54 | 10.260        | 260.60 | 10.575        | 268.61 | 10.835        | 275.21 | 10.150        | 257.81 |

\* CONTACT FACTORY FOR AVAILABILITY

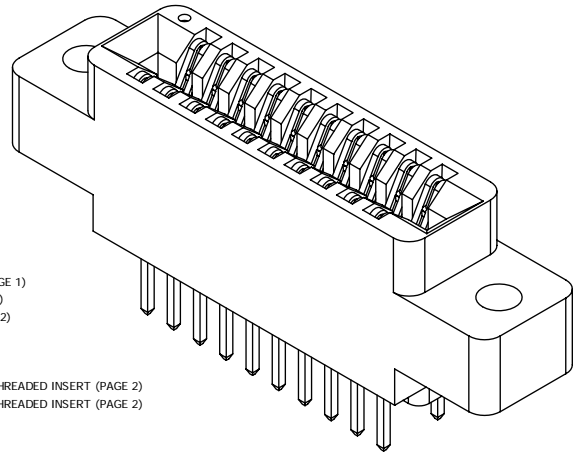

**PART NUMBER CODING**

C DRS

**MATERIALS (INSULATOR / CONTACT)**

- E = PBT/PHOSPHOR BRONZE**  
OPERATING TEMP: -65°C TO +125°C  
PROCESSING TEMP: 260°C FOR 10 SECS MAX
- R = PPS/PHOSPHOR BRONZE**  
OPERATING TEMP: -65°C TO +125°C  
PROCESSING TEMP: 260°C FOR 120 SECS MAX
- G = PA9T/PHOSPHOR BRONZE**  
OPERATING TEMP: -65°C TO +125°C  
PROCESSING TEMP: 260°C FOR 120 SECS MAX
- H = PBT/BERYLLIUM COPPER**  
OPERATING TEMP: -65°C TO +125°C  
PROCESSING TEMP: 260°C FOR 10 SECS MAX
- A = PPS/BERYLLIUM COPPER**  
OPERATING TEMP: -65°C TO +150°C  
PROCESSING TEMP: 260°C FOR 120 SECS MAX
- J = PA9T/BERYLLIUM COPPER**  
OPERATING TEMP: -65°C TO +150°C  
PROCESSING TEMP: 260°C FOR 120 SECS MAX

**ALL PLATINGS ARE LEAD FREE**

**NUMBER OF POSITIONS (CONTACTS PER ROW)**

**PLATING**

- ALL PLATINGS HAVE .000050" NICKEL UNDERPLATE
- CONTACT SURFACE
- G = .000010" GOLD
- Y = .000030" GOLD
- B = .000010" GOLD
- C = .000030" GOLD
- \*\*E = .000100" PURE TIN, MATTE, OVERALL
- S = .000010" GOLD OVERALL
- M = .000030" GOLD

\*\* OVERALL PURE TIN ONLY AVAILABLE ON MATERIAL CODES E, R AND G

**MOUNTING STYLE**

- H = .125" DIA. CLEARANCE HOLES (PAGE 1)
- I = #4-40 THREADED INSERT (PAGE 2)
- S = .125" DIA. SIDE MOUNTING (PAGE 2)
- N = NO MOUNTING EARS (PAGE 2)
- D = FLUSH MOUNTING (PAGE 2)
- W = FLUSH MOUNTING (PAGE 2)
- X = FLUSH MOUNTING WITH # 4-40 THREADED INSERT (PAGE 2)
- T = FLUSH MOUNTING WITH # 4-40 THREADED INSERT (PAGE 2)

- TERMINATION
- .000005" GOLD
- .000005" GOLD
- .000100" PURE TIN, MATTE
- .000100" PURE TIN, MATTE
- .000010" GOLD OVERALL



RoHS COMPLIANT

**CUSTOMER COPY**

|   |  |                                     |                 |
|---|--|-------------------------------------|-----------------|
| UNLESS OTHERWISE SPECIFIED:<br>DIMENSIONS ARE IN INCHES(MM)<br>TOLERANCES:<br>ANGULAR: ± .30°<br>XX = ± .02   .508<br>XXX = ± .005   .1270<br>XXXX = ± .0005   .0127<br>SURFACE FINISH: 63 Ra<br>REMOVE ALL BURRS AND SHARP EDGES: .010 MAX |  | DATE: 3-27-07<br>NAME: MNH          |                 |
| THE INFORMATION HEREIN CONTAINS PROPRIETARY INFORMATION OF SULLINS ELECTRONICS AND IS NOT TO BE REPRODUCED, USED OR DISCLOSED TO OTHERS FOR ANY PURPOSE EXCEPT AS SPECIFICALLY AUTHORIZED IN WRITING BY AN OFFICER OF SULLINS ELECTRONICS.  |  | DESCRIPTION: EDGE CARD, .100 CC, HP |                 |
| INTERPRET DIMENSIONS AND GEOMETRIC TOLERANCING PER: ANSI Y14.5M-1994  |  | PART NUMBER: C10922                 | REV: B          |
| SCALE: 2:1  |  | SIZE: C                             | DWG. NO. C10922 |
|   |  |                                     | SHEET 3 OF 3    |