

RECOMMENDED PCB LAYOUT (TOP VIEW)

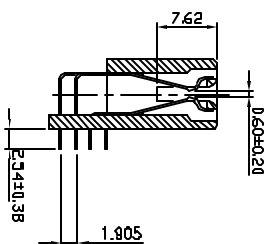

**MATERIAL**  
 INSULATOR: GLASS-REINFORCED THERMOPLASTIC.  
 CONTACT: COPPER ALLOY.  
 PLATING: MATING AREA - SELECTED GOLD OVER NICKEL.  
 SOLDER AREA - TIN/LEAD OVER NICKEL.

**ELECTRICAL**  
 VOLTAGE RATING: 250 VAC RMS.  
 CURRENT RATING: 1 AMP.  
 DIELECTRIC WITHSTANDING VOLTAGE: 500 VAC RMS 60Hz FOR 1 MINUTE  
 INSULATION RESISTANCE: 1000 MEGOHMS MIN AT 500 VDC.  
 CONTACT RESISTANCE: 30 MILLIOHMS MAX.

**MECHANICAL**  
 RETENTION FORCE: 480 GRAMS MIN PER CONTACT.  
 INSERTION FORCE: 230 GRAMS MAX PER CONTACT.  
 WITHDRAWAL FORCE: 15 GRAMS MIN PER CONTACT PAIR.

**ENVIRONMENTAL**  
 TEMPERATURE RANGE: -55°C TO +85°C.

TOLERANCE		ANGLES	
LINEAR	X ± 0.20	ANGLES	X ± .1
	X ± 0.15		X ± .1
	.XX ± 0.10		.XX ± .1
	.XXX ± 0.05		.XXX ± .1

TITLE:		64 BIT PCI CONN , 50V TYPE RIGHT ANGLE	
PART NO.		TRWB092DKAN-1750	
DWG NO.		1750	
UNITS		SCALE	
MM		2 : 1	
SHEET		1 OF 1	
REV		A	

APPD:	Sullins Electronics
CHKD:	San Marcos, CA
DRWN:	www.SullinsElectronics.com
FINISH:	
MAT'L:	
QTY:	

REV	A	ECN NO.	0601	NAME	Jason	DATE	90.06.01

1

2

3

4

5

6

7

8