

RECOMMENDED PCB LAYOUT (TOP VIEW)

MATERIAL
 INSULATOR: GLASS-REINFORCED THERMOPLASTIC.
 CONTACT: COPPER ALLOY.
 PLATING: WATING AREA - SELECTED GOLD OVER NICKEL.
 SOLDER AREA - TIV/LEAD OVER NICKEL.

ELECTRICAL
 VOLTAGE RATING: 250 VAC RMS.
 CURRENT RATING: 1 AMP.
 DELTA I: WITHSTANDING VOLTAGE: 500 VAC RMS @ 500 Hz FOR 1 MINUTE.
 INSULATION RESISTANCE: 1000 MEGOHMS MIN AT 500 VDC.
 CONTACT RESISTANCE: 30 MILLIOHMS MAX.

MECHANICAL
 RETENTION FORCE: 480 GRAMS MIN PER CONTACT PAIR.
 INSERTION FORCE: 230 GRAMS MAX PER CONTACT PAIR.
 WITHDRAWAL FORCE: 15 GRAMS MIN PER CONTACT PAIR.
 ENVIRONMENTAL
 TEMPERATURE RANGE: -55°C TO +85°C.

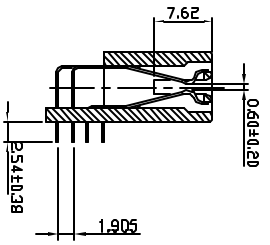

TOLERANCE		Sullins Electronics San Marcos, CA www.SullinsElectronics.com	TITLE: 64 BIT PCI CONN , 3.3V TYPE RIGHT ANGLE
LINEAR	ANGLES		
X±0.20	X±	APPR:	PART NO. TRWB0920KAN-1329
X±0.15	X±	CHKD:	DWG NO. 1329
XX±0.10	XX±	MATL:	UNITS MM
XXX±	XXX±	FINISH:	SCALE 2 : 1
		DRWN: Jason Deng	SHEET 1 OF 1
		QTY:	REV A

REV	ECN NO.	NAME	DATE	1	2	3	4	5	6	7	8
A	0601	Jason	90.06.01								