



.050" [1.27 mm] Contact Centers, .610" [15.49 mm] Insulator Height
[PCI] Dip Solder/Card Extender/SMT

Industry Standard Part

SPECIFICATIONS

- Accommodates .062" ± .008" [1.57 ± .20] PC board
- PPS or PA9T insulator
- Molded-in key available
- High reliability/high cycle hairpin bellows contact
- 1 amp current rating per contact
- 150 grams normal force minimum
- UL Flammability Rating: 94V-0

READOUT



DUAL (D)

DIMENSIONS

Dimensions in [] are in millimeters, all others are in inches.

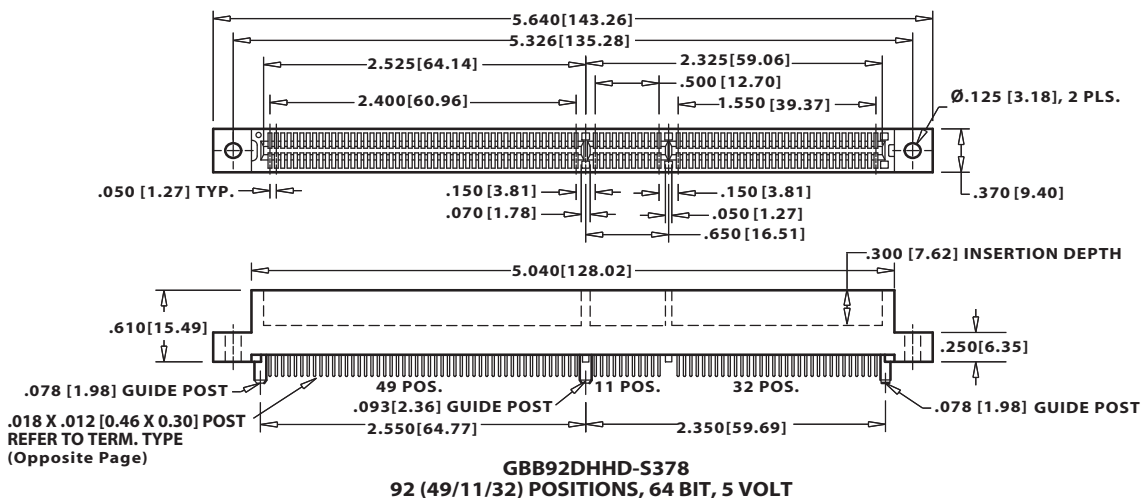
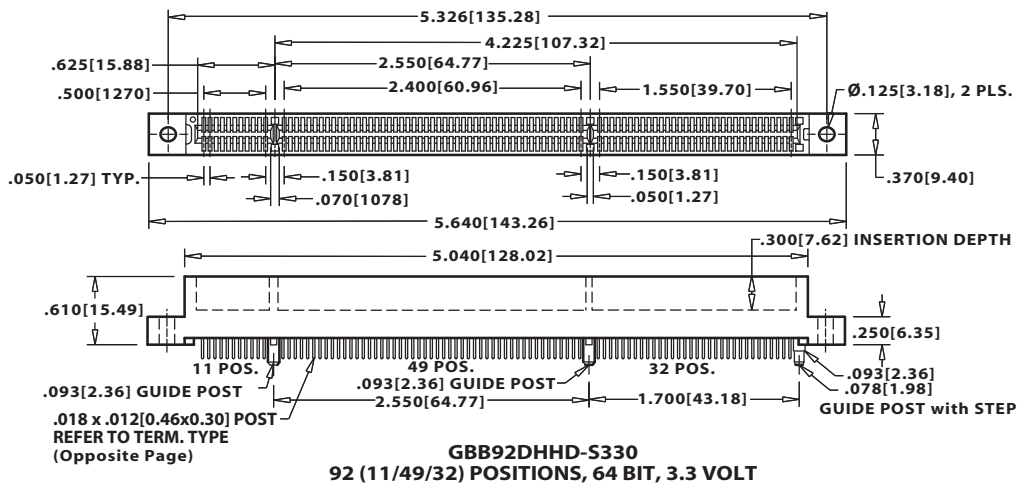
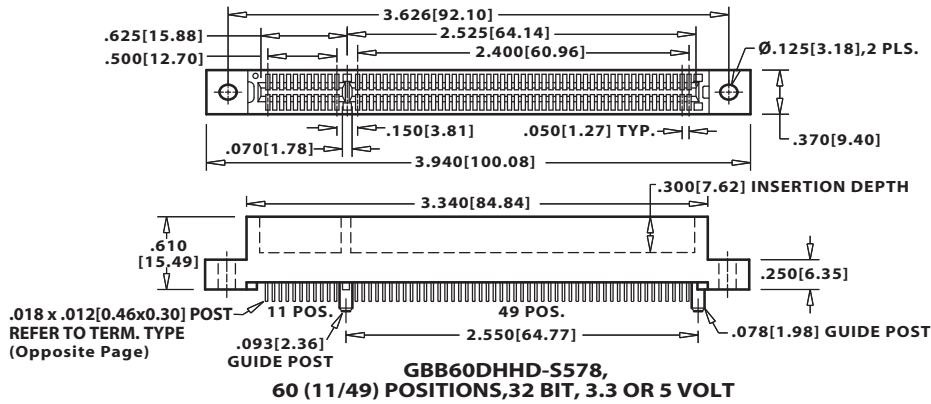



**.050" [1.27mm] Contact Centers, .610" [15.49 mm] Insulator Height
[PCI] Dip Solder/Card Extender/SMT**

Industry Standard Part

Sullins Card Edge

PART NUMBER OPTIONS

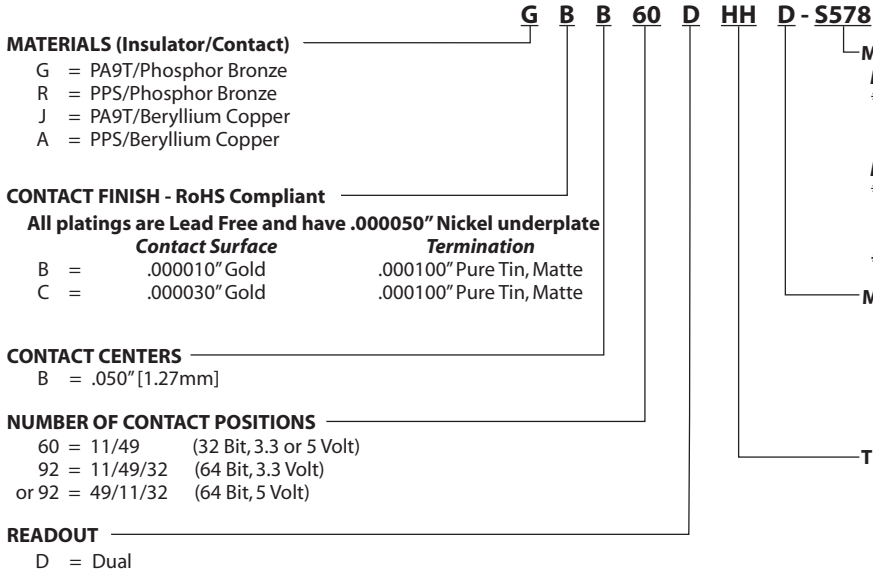

MODIFICATION (CONSULT FACTORY)

PCI WITH GUIDE POSTS

*-S578 = 60 (11/49) Positions(32 Bit, 3.3 or 5 Volt)

-S330 = 92 (11/49/32) Positions(64 Bit, 3.3 Volt)

-S378 = 92 (49/11/32) Positions(64 Bit, 5 Volt)

PCI WITHOUT GUIDE POSTS

*-S621 = 60 (11/49) Positions(32 Bit, 3.3 or 5 Volt)

-S329 = 92 (11/49/32) Positions(64 Bit, 3.3 Volt)

-S250 = 92 (49/11/32) Positions(64 Bit, 5 Volt)

*** Turn connector or board 180° to switch from 3.3 to 5 volt**

MOUNTING STYLE

D = Flush Mounting

N = No Mounting

T = Flush Mounting With Threaded Insert

Q = Straddle Mount (Card Extender Only)

R = Metal Boardlocks

TERMINATION TYPE

HH = Staggered Dip Solder

HR = Card Extender

HF = Surface Mount

HL = .250" [6.35mm] x .160" [4.06mm] Dip Solder

HN = .100" [2.54mm] x .125" [3.18mm] Dip Solder

(REPLACES TERMINATIONS: CH, CR, CF, CL, CN)

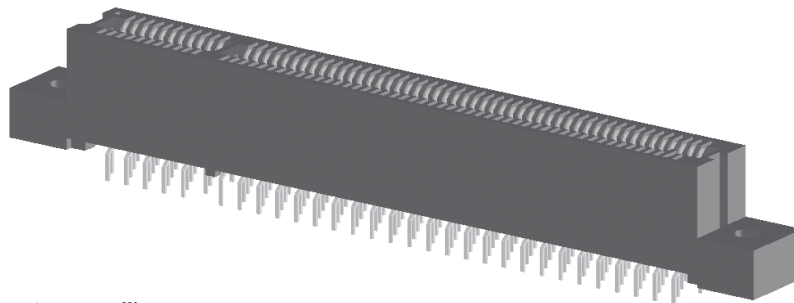

FOR PC BOARD LAYOUTS REFER TO www.sullinscorp.com

TERMINATION TYPE

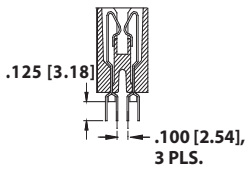

STAGGERED DIP SOLDER (HH)

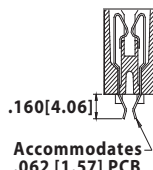

CARD EXTENDER (HR)

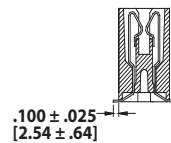

SURFACE MOUNT (HF)

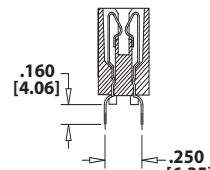

DIP SOLDER (HL)

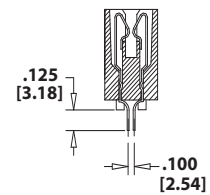

DIP SOLDER (HN)

MOUNTING STYLE



NO MOUNTING EARS (N)

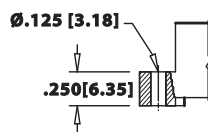

FLUSH MOUNTING (D)

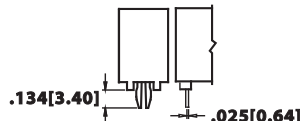

METAL BOARD LOCK (with no mounting ears) (R)

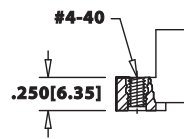

FLUSH MOUNTING WITH THREADED INSERT (T)

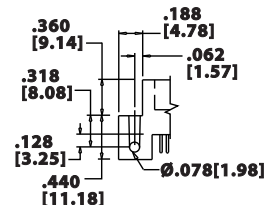

STRADDLE MOUNT (Q) Formerly (Z)