

ZONE	REV.	DESCRIPTION	DATE	APPROVED
	N/R	NEW RELEASE	6-03-03	KMG
	A	REVISED PER DCN# 0896	8/26/03	A.S.
	B	REVISED PER DCN# 0913	11/26/03	A.S.
	C	REVISED PER DCN# 0923	2/2/04	A.N.

THE INFORMATION CONTAINED HEREIN IS PROPRIETARY TO HIROSE ELECTRIC (USA), INC. ALL RIGHTS THEREIN ARE RESERVED AND SHALL NOT BE USED, DUPLICATED, OR FURTHER DISSEMINATED FOR ANY PURPOSE WITHOUT THE CONSENT OF HIROSE ELECTRIC (USA), INC.

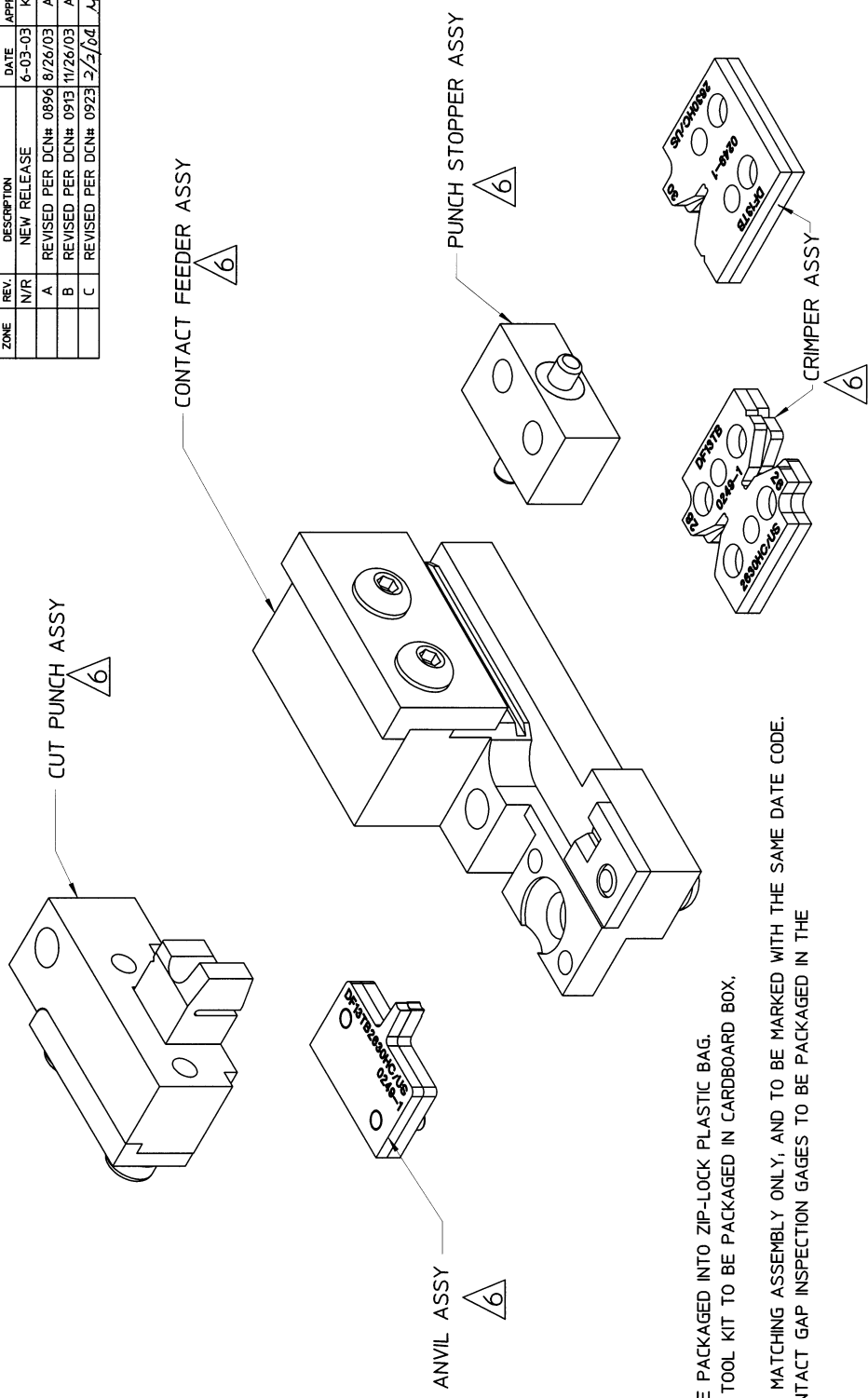

12. PACKAGING: SIX (6) DIE SET ASSEMBLIES TO BE PACKAGED INTO ZIP-LOCK PLASTIC BAG. PLASTIC BAG WITH DIE SET ASSEMBLIES AND TOOL KIT TO BE PACKAGED IN CARDBOARD BOX. SIZE 203mm X 76mm X 51mm (8" X 3" X 2").
11. ANVIL ASSY AND CRIMPER ASSY ARE SOLD AS MATCHING ASSEMBLY ONLY, AND TO BE MARKED WITH THE SAME DATE CODE.
10. TOOL KIT. ALL APPLICABLE SCREWS, AND CONTACT GAP INSPECTION GAGES TO BE PACKAGED IN THE ZIP-LOCK PLASTIC BAG, AS SHOWN IN FIG 1. LABEL TO BE APPLIED AS SHOWN.

9. DATE CODE AND SET No., SEE EXAMPLE FOR EXPLANATION.
8. PART/NO. DF13-TB2630HC/US-DS TO BE PURCHASED AS A SET ONLY.
7. RECOMMENDED NUMBER OF CRIMPING CYCLES - 15,000.
6. FOR ASSEMBLY, INSTALLATION AND OPERATION OF THIS DIE SET, AND CONTACT GAP INSPECTION, REFER TO INSTRUCTION MANUAL P/NO. PS078.

5. THIS DIE SET IS RECOMMENDED TO BE USED ONLY WITH APPLICABLE HAND CRIMP TOOL, P/NO. HRUS-HT-1, AND TO CRIMP CONTACT, P/NO. DF13-2630SCF/SCFA.
 4. APPLICABLE WIRE STYLE: UL 1061, AWG 26, 28 AND 30.
 3. MATERIALS: TOOL STEEL.
 2. DIMENSIONS IN () ARE FOR REFERENCE ONLY
 1. DIMENSIONING AND TOLERANCING PER ANSI/ASME Y14.5M-1994
- NOTES (UNLESS OTHERWISE SPECIFIED)

CUSTOMER USE DRAWING

FORM NO. 0AG18	TOLERANCE PRACTICE 	UNLESS OTHERWISE SPECIFIED DIMENSION ARE IN MILLIMETERS TOLERANCES ARE	
		XX = +0.1	YY = +0.05
PROJECT NO.	DATE	APPROVALS	CL NUMBER
XXXXXXXXXX	05/05/03	Luis Lostaunau	5920-8502-5
XXXXXX	05/20/03	Alia Stchur	DWG NUMBER
APP. ASSY.	05/30/03	Mac Nagashima	REV. C
APPLICATION	06/03/03	Kris McGuire	SCALE N/A SHEET 1 OF 2

HRS HIROSE ELECTRIC (USA), INC.
SHIM VALLEY, CALIFORNIA 93065
PART NUMBER
DF13-TB2630HC/US-DS

REVISIONS			
ZONE	REV.	DESCRIPTION	DATE
	A	REVISED PER DCNR 0896	
	B	REVISED PER DCNR 0913	11/26/03
	C	REVISED PER DCNR 0923	3/2/04

THE INFORMATION CONTAIN HEREIN IS PROPRIETARY TO HIROSE ELECTRIC (USA), INC. ALL RIGHTS THEREIN ARE RESERVED AND SHALL NOT BE USED, DUPLICATED, OR FURTHER DISSEMINATED FOR ANY PURPOSE WITHOUT THE CONSENT OF HIROSE ELECTRIC (USA), INC.

M2.5 SOCKET HEAD CAP SCREW, 10 mm LONG SHOWN FOR REFERENCE ONLY. NOT INSTALLED

M3 FLAT HEAD PHILLIPS MACHINE SCREW, 6 mm LONG, SHOWN FOR REFERENCE ONLY. NOT INSTALLED

M3 SOCKET HEAD CAP SCREW, 12 mm LONG, SHOWN FOR REFERENCE ONLY. NOT INSTALLED

M2.5 SOCKET HEAD CAP SCREW, 10 mm LONG SHOWN FOR REFERENCE ONLY. NOT INSTALLED

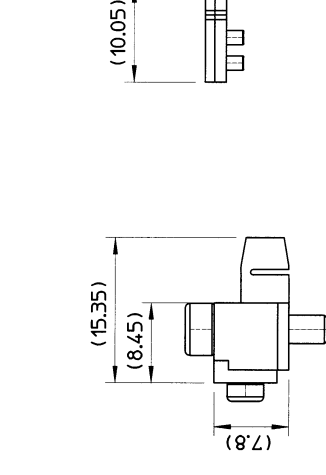
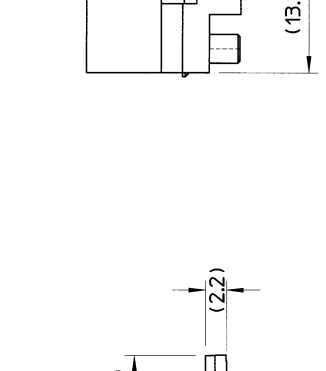
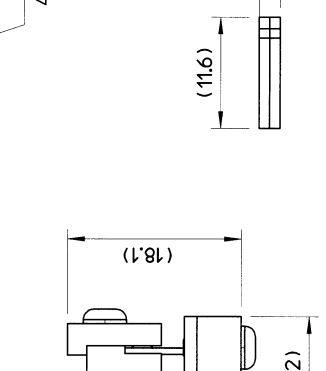
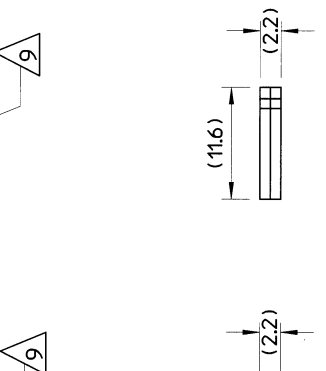
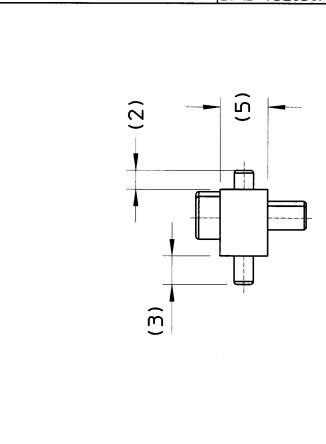
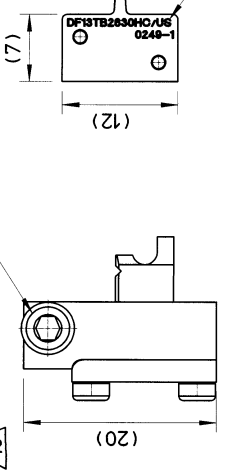
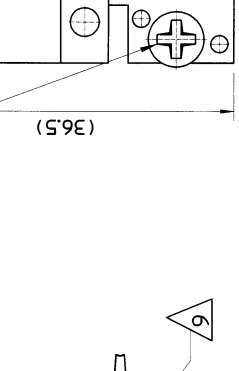
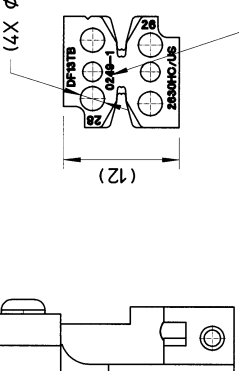
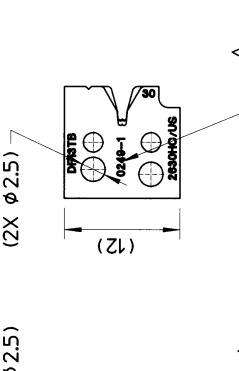
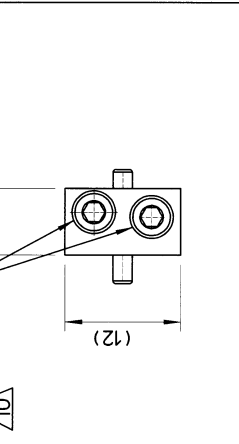

PUNCH STOPPER ASSY

CRIMPER ASSY

CONTACT FEEDER ASSY

ANVIL ASSY

CUT PUNCH ASSY

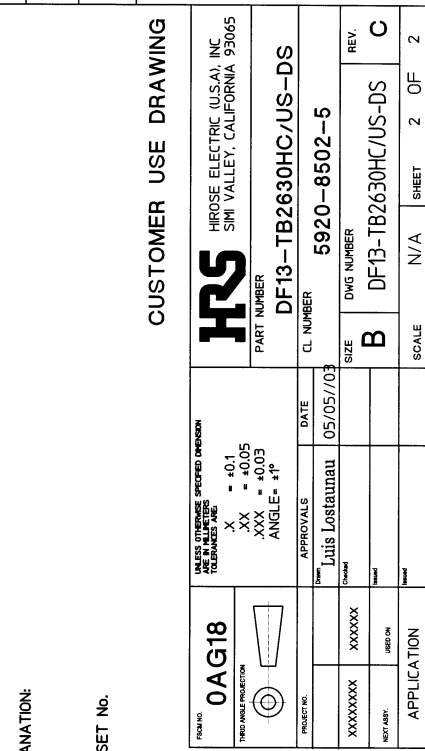
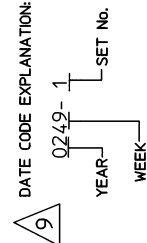

FROM HRS		DATE	
0AG18	05/05/03	APPROVALS	DATE
ALL DIMENSIONS UNLESS SPECIFIED OTHERWISE ARE IN MILLIMETERS TOLERANCES ARE: X = ±0.1 XX = ±0.05 XXX = ±0.03 ANGLE = ±1°		Luis Lostaunau	05/05/03
PART NUMBER DF13-TB2630HC/US-DS		CL NUMBER	5920-8502-5
SIZE B		DWG NUMBER	DF13-TB2630HC/US-DS
APPLICATION		SCALE	N/A
SHEET 2 OF 2		REV. C	

HRS HIROSE ELECTRIC (USA), INC. SIMI VALLEY, CALIFORNIA 93065

DATE CODE EXPLANATION:
 0249-1
 YEAR WEEK SET No.

FIG.1