

4

3

2

1

THIS DRAWING IS UNPUBLISHED. RELEASED FOR PUBLICATION.  
 © COPYRIGHT BY TYCO ELECTRONICS CORPORATION. ALL INTERNATIONAL RIGHTS RESERVED.

LOC	DIST	REVISIONS		
F	LR	DESCRIPTION	DATE	BY
AF1		REVISED PER ECR-08-007324	17JUL08	HMR JR

- 1 OPERATION TEMPERATURE - 105°C MAX
- 2 RETENTION FORCE - 16 OUNCES MIN INITIALLY, 6 OUNCES MIN, AFTER 500 CYCLES.
- 3 REFER TO MOUNTING HOLE PATTERN
- 4 HOUSING NYLON TYPE 6/6  
RECEPT & LEGS, BRASS  
ASTM B36 ALLOY6

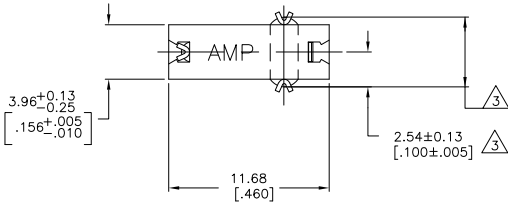
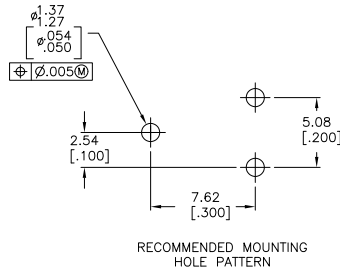
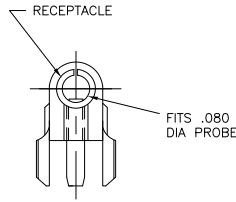
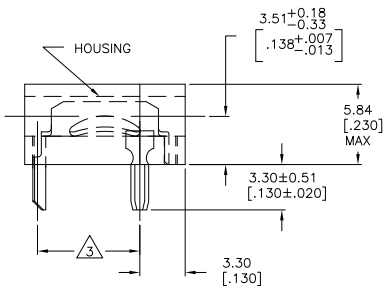

OBSOLETE	GOLD	NATURAL	6-582119-9
OBSOLETE	SILVER	NATURAL	5-582119-9
	GOLD	WHITE	3-582119-9
OBSOLETE	GOLD	GRAY	3-582119-8
OBSOLETE	GOLD	VIOLET	3-582119-7
OBSOLETE	GOLD	BLUE	3-582119-6
	GOLD	GREEN	3-582119-5
	GOLD	YELLOW	3-582119-4
OBSOLETE	GOLD	ORANGE	3-582119-3
	GOLD	RED	3-582119-2
OBSOLETE	GOLD	BROWN	3-582119-1
	GOLD	BLACK	3-582119-0
OBSOLETE	SILVER	WHITE	2-582119-9
OBSOLETE	SILVER	GRAY	2-582119-8
OBSOLETE	SILVER	VIOLET	2-582119-7
OBSOLETE	SILVER	BLUE	2-582119-6
OBSOLETE	SILVER	GREEN	2-582119-5
OBSOLETE	SILVER	YELLOW	2-582119-4
OBSOLETE	SILVER	ORANGE	2-582119-3
OBSOLETE	SILVER	RED	2-582119-2
OBSOLETE	SILVER	BROWN	2-582119-1
OBSOLETE	SILVER	BLACK	2-582119-0
	LEGS & RECEPT FINISH	COLOR	PART NO

THIS DRAWING IS A CONTROLLED DOCUMENT.		DRN	17JUL08	Tyco Electronics Corporation Harrisburg, PA 17105-3608
		CHK	17JUL08	
DIMENSIONS: mm [INCHES]		APPD	17JUL08	TEST PROBE ASSEMBLY
TOLERANCES UNLESS OTHERWISE SPECIFIED:		NAME		
0 PLC	± .005	ED HOWARD		RESTRICTED TO
1 PLC	± .002			
2 PLC	± .001			
3 PLC	± .0005			
4 PLC	± .0002			
ANGLES	± .0001			
MATERIAL	SEE TABLE	APPLICATION SPEC	SIZE	CAGE CODE
FINISH		WEIGHT	A2	00779
			C=582119	
		CUSTOMER DRAWING	SCALE	5:1
			SHEET	1 of 1
			REV	AF1

582119

A