

FVT / FST WIREWOUND RESISTORS

25 WATTS THRU 225 WATTS

H.E.I. Fixed Wirewound Resistors are constructed with steatite ceramic cores and terminated with welded terminals and wound with the finest alloy resistance wires welded to the terminals. Our special formula of vitreous enamel (FVT) or silicone (FST) coatings are then used to insulate the resistors. This construction insures long life, durability, and reliability.

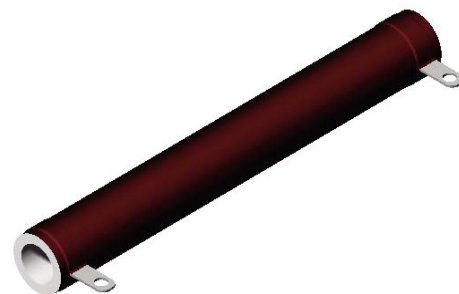
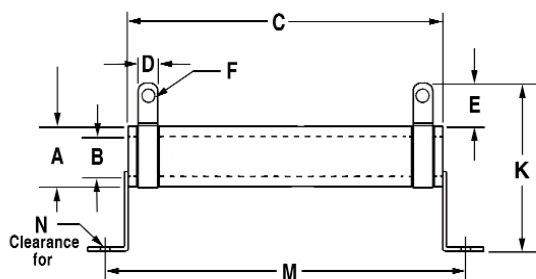

FVT - VITREOUS FST - SILICONE

TYPE	WATT	CORE			TERMINAL				MOUNTING	
		A TYP	B +/- .032(0.8)	C +/- .032(0.8)	D TYP	E TYP	F TYP	K TYP	M NOM	N
FVT-10	12	.31 (7.9)	.19 (4.8)	1.75 (44.5)	.19 (4.8)	.44 (11.2)	.104 (2.6)	.94 (23.8)	2.19 (55.6)	6-32
FVT-25	25	.56 (14.3)	.31 (7.9)	2.00 (50.8)	.25 (6.4)	.56 (14.3)	.166 (4.2)	1.70 (42.9)	2.75 (69.9)	8-32
FVT-25A	30	.75 (19)	.50 (12.7)	2.00 (50.8)	.25 (6.4)	.56 (14.3)	.166 (4.2)	2.31 (58.7)	2.88 (73.2)	10-32
FVT-25B	30	.63 (15.9)	.45 (11.5)	2.00 (50.8)	.25 (6.4)	.56 (14.3)	.166 (4.2)	1.70 (42.9)	2.63 (66.8)	8-32
FVT-50	50	.56 (14.3)	.31 (7.9)	4.00 (101.6)	.25 (6.4)	.56 (14.3)	.166 (4.2)	1.70 (42.9)	4.75 (120.6)	8-32
FVT-50A	60	.75 (19)	.50 (12.7)	4.00 (101.6)	.25 (6.4)	.56 (14.3)	.166 (4.2)	2.31 (58.7)	4.88 (124.0)	10-32
FVT-50B	70	.75 (19)	.55 (13.9)	4.50 (114.3)	.25 (6.4)	.56 (14.3)	.166 (4.2)	2.31 (58.7)	5.38 (136.7)	10-32
FVT-75	75	.56 (14.3)	.31 (7.9)	6.00 (152.4)	.25 (6.4)	.56 (14.3)	.166 (4.2)	1.70 (42.9)	6.75 (171.5)	8-32
FVT-75A	90	.75 (19)	.50 (12.7)	6.00 (152.4)	.25 (6.4)	.56 (14.3)	.166 (4.2)	2.31 (58.7)	6.88 (174.8)	10-32
FVT-100	100	.75 (19)	.50 (12.7)	6.50 (165.1)	.25 (6.4)	.56 (14.3)	.166 (4.2)	2.31 (58.7)	7.38 (187.5)	10-32
FVT-130	130	1.13 (28.6)	.75 (19)	6.50 (165.1)	.31 (7.9)	.63 (15.9)	.166 (4.2)	2.81 (71.4)	7.38 (187.5)	10-32
FVT-160	175	1.13 (28.6)	.75 (19)	8.50 (215.9)	.31 (7.9)	.63 (15.9)	.196 (5.0)	2.81 (71.4)	9.38 (238.3)	10-32
FVT-200	225	1.13 (28.6)	.75 (19)	10.50 (266.7)	.31 (7.9)	.63 (15.9)	.196 (5.0)	2.81 (71.4)	11.38 (289.1)	10-32

inches (mm)

ORDER INFORMATION

FVTJ - 25 - 100 - NI - QC - BKTS

TYPE	INCLUDE FOR	POWER	RESISTANCE	ADD FOR	ADD FOR	ADD FOR
V=VITREOUS	TOLERANCE (J = ± 5%)		VALUE	NON-INDUCTIVE	QUICK CONNECT	STANDARD BRACKETS
S=SILICON						

OPTIONAL FEATURES AVAILABLE

RESISTANCE TOLERANCE: Standard tolerance is ±5% for 1 ohm and greater and ±10% for less than 1 ohm. Available Tolerances: F = ±1%, J = ±5%, K = ±10%

MOUNTING BRACKETS: Push-in friction grip mounting brackets are available as shown above. When required, add "BKTS" to the part number.

QUICK CONNECT TERMINALS: Resistors with a core O.D. of 9/16 or 3/4 inch can be supplied with Quick Connect Terminals 1/4" wide. Add "QC" to the part number as shown.

