

Power Relay RM C/D

- 1 pole 30 A, 1 NO or 1 NO + 1 NC contact
- Switching capacity up to 7500 VA
- DC- or AC-coil
- Push-to-test-button
- Chassis mount
- RoHS compliant (Directive 2002/95/EC) as per product date code 0415

Applications

Battery chargers, heating control



F0166-A

Approvals

UL E214025

Technical data of approved types on request

Contact data	RMC	RMD
Contact configuration	1 NO and 1 NC	1 NO
Contact set	single bridging contact	
Type of interruption	micro disconnection	
Rated current	30 A	
Rated voltage / max.switching voltage AC	400/440 VAC	
Maximum breaking capacity AC	7500 VA	
Limiting making capacity, max 20 ms	60 A	
Contact material	AgCdO	
Mechanical endurance	10x10 ⁶ cycles	
Rated frequency of operation with / without load	16/100 min ⁻¹	

Contact ratings

Type	Load	Cycles
RMC/D	30 A, 415 VAC, UL	10x10 ³
RMC/D	30 A, 250 VAC, general purpose, UL	6x10 ³

Coil data

Rated coil voltage range	DC coil	6...220 VDC
	AC coil	6...400 VAC
Coil power	DC coil	1.2 W
	AC coil	2.8 VA
Operative range		2

Coil versions, DC-coil

Coil code	STD	LED	PD*	LED+	Rated voltage	Operate voltage	Release voltage	Coil resistance	Rated coil power
	bipolar			PD*	VDC	VDC	VDC	Ohm	W
006	L06	0A6	LA6		6	4.5	0.6	32±10%	1.1
012	L12	0B2	LB2		12	9.0	1.2	110±10%	1.3
024	L24	0C4	LC4		24	18.0	2.4	475±10%	1.2
048	L48	0E8	LE8		48	36.0	4.8	2000±10%	1.2
060	L60	0G0	LG0		60	45.0	6.0	2850±10%	1.3
110	M10	1B0	MB0		110	82.5	11.0	10000±12%	1.2
221	N21	2C1	NC1		220	165.0	22.0	40000±15%	1.2

All figures are given for coil without preenergization, at ambient temperature +23°C

*) Protection diode PD; standard polarity: +A1 / -A2

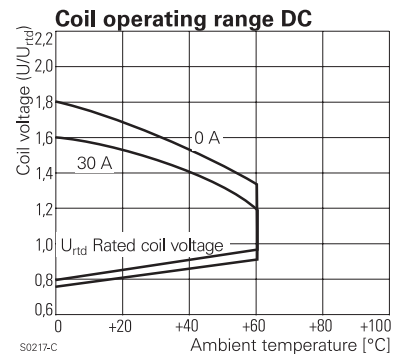
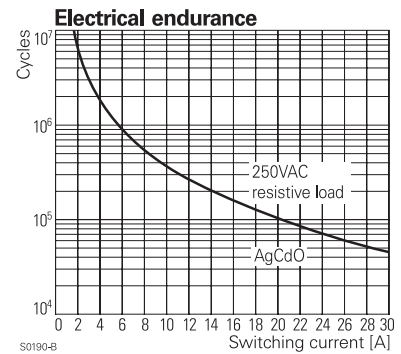
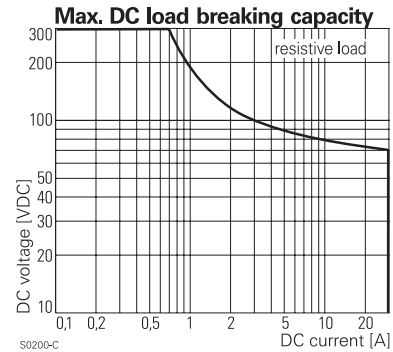

Power Relay RM C/D (Continued)

Coil versions, AC-coil 50/60 Hz

Coil code STD	LED	Rated voltage VAC	Operate voltage 50/60Hz VAC	Release voltage 50/60Hz VAC	Coil resistance Ohm	Rated coil power 50/60Hz VA
524	R24	24	19.2/20.4	9.6	80±10%	2.62/2.00
548	R48	48	38.4/40.8	19.2	320±10%	2.60/2.17
560	R60	60	48.0/51.0	24.0	500±10%	2.62/2.20
615	S15	115	92.0/97.8	46.0	1850±10%	2.65/2.22
730	T30	230	184.0/195.5	92.0	7500±10%	2.69/2.26
900	V00	400	320.0/340.0	160.0	23500±15%	2.61/2.20

All figures are given for coil without preenergization, at ambient temperature +23°C

Insulation

Dielectric strength coil-contact circuit	2500 V _{rms}
open contact circuit	1500 V _{rms}
Clearance / creepage coil-contact circuit	≥ 4/14.9 mm
Material group of insulation parts	≥ IIIa
Insulation to IEC 60664-1	
Type of insulation coil-contact circuit	basic
open contact circuit	functional
Rated insulation voltage	250 V
Pollution degree	3
Rated voltage system	240/400 V
Overvoltage category	III

Other data

RoHS - Directive 2002/95/EC	compliant as per product date code 0415
Ambient temperature range DC coil	-45...+60°C
AC coil	-45...+40°C
Operate- / release time	17/18 ms
Bounce time NO / NC contact	4
Vibration resistance (function) NO / NC contact	10/5 g, 30...150 Hz
Category of protection	RTI - dust protected
Relay weight	81 g
Packaging unit	10 pcs

Terminal assignment

Bottom view on pins

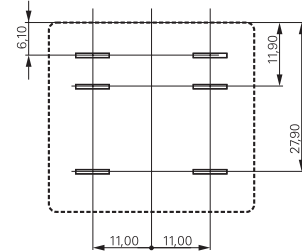

S0269-AK

1 NO and 1 NC contact, RMC

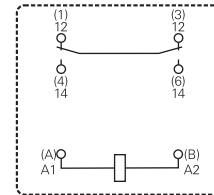

S0269-AH

1 NO contact, RMD

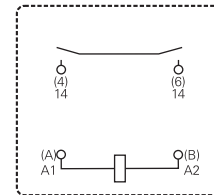

S0269-AI

Power Relay RM C/D (Continued)

Dimensions

Cover with mounting brackets, 6.3 mm quick connect terminals

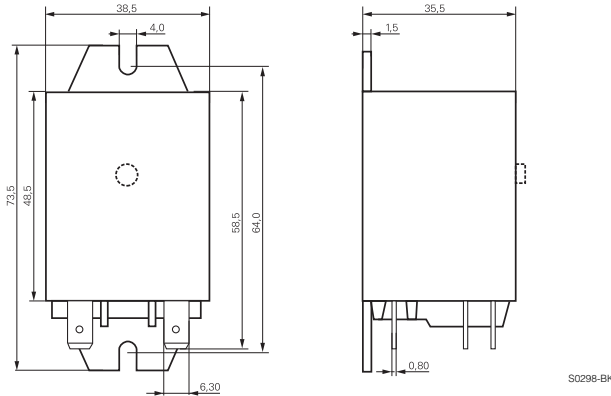

Product key

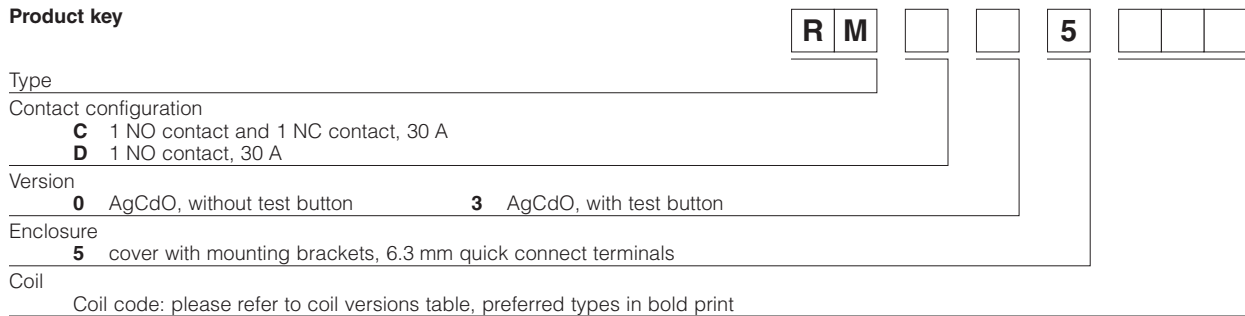

Product key	Contacts	Version	Enclosure	Coil	Coil	Part number
RMC05024	1 NO + 1 NC contact 30 A	without	mounting brackets quick c. 6.3 mm	DC-coil	24 VDC	4-1393844-5
RMC05524		test button		AC-coil	24 VAC	0-1393146-5
RMC05615					115 VAC	8-1393147-7
RMC05730					230 VAC	0-1393146-6
RMC35024		with test button		DC-coil	24 VDC	0-1393146-7
RMD05024	1 NO contact 30 A	without			24 VDC	0-1393146-9
RMD05524		test button		AC-coil	24 VAC	1-1393146-1
RMD05615					115 VAC	0-1415009-1
RMD05730					230 VAC	4-1393844-7
RMD35024		with		DC-coil	24 VDC	2-1419136-2
RMD35730		test button		AC-coil	230 VAC	0-1393097-5

Sockets and Accessories

Relay-Socket combinations specified according to IEC 61810-1 and IEC 61984 and accessories for DIN-rail socket plastic retaining clip metal retaining clip module marking tag

relay	socket	plastic retaining clip			metal retaining clip		module	marking tag
SNR	STxFxxx	rel.height	12.3 mm	15.7 mm	25.5 mm			ST37040
RT pinning 3.5	RT78724			RT17017			PTMxxxxx	RT17040
	RT7872P			RT17017			PTMxxxxx	RT17040
RT pinning 5.0	RT78726			RT17017			PTMxxxxx	RT17040
	RT78725			RT17017			PTMxxxxx	RT17040
XT pinning 5.0	RT7872P				XT17017		PTMxxxxx	RT17040
	RT78726				XT17017		PTMxxxxx	RT17040
	RT78725				XT17017		PTMxxxxx	RT17040
	rel.height	29mm				29mm 36mm		
PT2	PT7872P	PT17016				PT28800 ZG28801	PTMxxxxx	PT17040
	PT78722	PT17021				PT28800 ZG28801	PTMxxxxx	PT17040
	PT78720	PT17016				PT28800 ZG28801	PTMxxxxx	PT17040
		PT17024						
	PT78741	PT17016				PT28800 ZG28801	PTMT00A0	PT17040
		PT17024						
PT3	PT78730	PT17016				PT28800 ZG28801	PTMxxxxx	PT17040
		PT17024						
PT5	PT7874P	PT17016				PT28800 ZG28801	PTMxxxxx	PT17040
		PT17021				PT28800 ZG28801	PTMxxxxx	PT17040
	PT78740	PT17016				PT28800 ZG28801	PTMxxxxx	PT17040
		PT17024						
	PT78741	PT17016				PT28800 ZG28801	PTMT00A0	PT17040
		PT17024						
MT2	MT78755					MT28800		
	MT78745					MT28800	MTMxxxxx	
MT3	MT78750					MT28800		
	MT78760					MT28800		
	MT78740					MT28800	MTMxxxxx	
RMxx2	RM78705							

Relay-Socket combinations specified according to IEC 61810-1 and IEC 61984 and accessories for printed circuit board socket plastic retaining clip metal retaining clip in mounting plate socket metal retaining clip

relay	socket	plastic retaining clip			metal retaining clip		in mounting plate	
	rel.height	12.3mm	15.7mm	25.5mm	15.7mm	25.5mm	socket	metal retaining clip
RY pinning 3.2	RY78600	RY16037						
E pinning 2.5	RP78600			RP16100		RP28500		
RT pinning 3.5	RP78601		RT16041		RT28516			
RT pinning 5.0	RP78602		RT16041		RT28516			
	rel.height				29mm	36mm		29mm 36mm
PT2	PT78604				PT28802	ZG28800	PT78600	PT28802 ZG28800
	PT78602				PT28802	ZG28800	PT78601	PT28802 ZG28800
PT3	PT78603				PT28802	ZG28800		
PT5	PT78604				PT28802	ZG28800	PT78600	PT28802 ZG28800
							PT78601	PT28802 ZG28800
MT2	MT78602						MT78612	
MT3	MT78603						MT78613	
RMxx2	RM78702				RM28802		RM78700	RM28802
							RM78701	RM28802

All sockets in this catalog have been tested and approved with the Tyco Electronics Schrack product range. For combination of sockets with other relays with similar design and pinning Tyco Electronics cannot take responsibility for any malfunction.