

| | | | |
|---|------------------------|--|---------------------------|
|  Harrisburg, PA 17105-3608 | | PART NO. 1432873-1 SHT. 1 OF 2 | |
| DRAWN NESTOROVSKI | APPROVAL B. TOEPFER | DATE FIRST DRAWN 08-10-06 | SCALE 1:1 |
| TOLERANCE UNLESS SPECIFIED OTHERWISE | | O.X = +/- O.XX = +/- O.XXX = +/- ANGLES = +/- | CUSTOMER TYCO-STANDARD |
| DO NOT SCALE THIS DRAWING | | CHANGES | |
| | | REV.  | DATE 08-10-06 |
| | | CO | APP. |
| | | RELEASE | B.T. |

ELECTRICAL CHARACTERISTICS: (ALL DATA APPLIES @ 23°C UNLESS OTHERWISE SPECIFIED)

COIL DATA:

NOMINAL VOLTAGE: 6 VDC
 OPERATE VOLTAGE: 3.9 VDC MAXIMUM
 RELEASE VOLTAGE: 0.6 VDC MINIMUM
 COIL RESISTANCE: 22.5 OHMS +/- 10%
 OPERATE TIME: 8 mSEC. MAXIMUM EXCLUDING BOUNCE
 RELEASE TIME: 5 mSEC. MAXIMUM EXCLUDING BOUNCE
 TEMPERATURE RANGE: OPERATING -40°C TO +85°C

CONTACT DATA: (CONTACT DATA IS FORMATTED N.O./N.C.)

CONTACT ARRANGEMENT: 1 FORM C (SPDT)
 CONTACT MATERIAL: AgSnO (SILVER TIN-OXIDE)
 CONTACT MILLIVOLT DROP: 200mv @ 35A ON N.O. CONTACTS (AFTER SWITCHING)
 250mv @ 20A ON N.C. CONTACTS (AFTER SWITCHING)
 MAXIMUM MAKE CURRENT: 90A/30A (LAMP) @ 16 VDC
 MAXIMUM BREAK CURRENT: 40A/30A @ 16 VDC RESISTIVE
 MAXIMUM CONTINUOUS CURRENT: 40A/30A @ 23°C, 35A/20A @ 85°C
 INITIAL BREAKDOWN CURRENT: 500V RMS CONTACTS TO COIL

EXPECTED LIFE:

100,000 OPERATIONS, 40 A, 14 VDC RESISTIVE ON NORMALLY OPEN CONTACT

MECHANICAL CHARACTERISTICS:

EXPECTED LIFE: 10 MILLION OPERATIONS, NO CONTACT LOAD
 TERMINALS: BRASS, UNPLATED

TOLERANCE 0.X = +/-
 UNLESS 0.XX = +/-
 SPECIFIED 0.XXX = +/-
 OTHERWISE ANGLES = +/-

CUSTOMER DATA

CUSTOMER TYCO-STADARD



REV A

DO NOT SCALE THIS DRAWING

MILLIMETERS

PART NO. 1432873-1

SHT. 2 OF 2

MARKING TO INCLUDE:

TYCO NAME, TYCO PART NUMBER, SCHEMATIC,
 COIL VOLTAGE, COUNTRY OF ORIGIN, AND DATE CODE

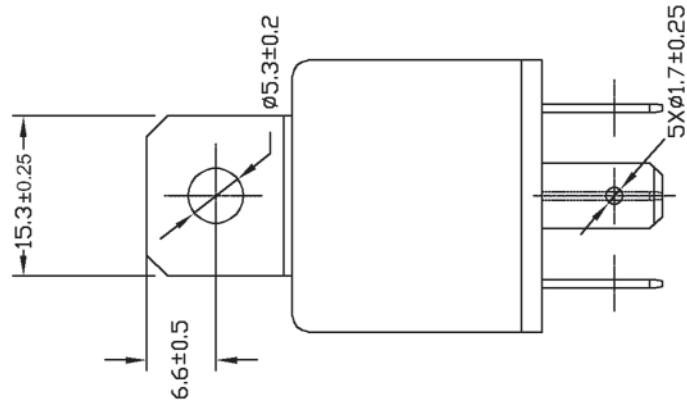

* TERMINAL LOCATIONS
 APPLY AT THE BASE
 OF THE TERMINALS

