

THIS DRAWING IS UNPUBLISHED. RELEASED FOR PUBLICATION
 © COPYRIGHT BY TYCO ELECTRONICS CORPORATION. ALL RIGHTS RESERVED.

LOC HB		DIST		REVISIONS						
P	LTR	DESCRIPTION	ECN	DATE	DWN	APVD				
	A	ADD PACKING SPEC	ECO-06-013487	31-MAY-06	WQH	H.F				
	B	CHANGE DATE CODE AND TE LOGO	ECO-08-007869	18-APR-09	SZJ	BLY				

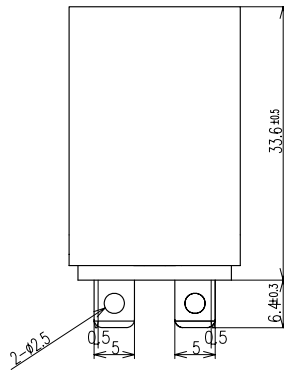

CONNECTION DIAGRAM

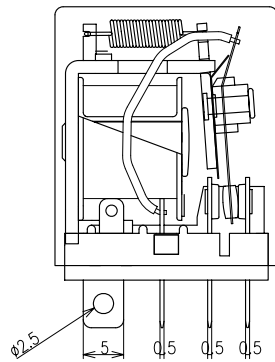
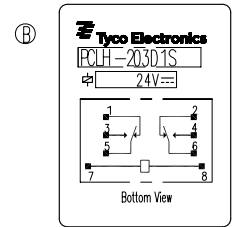
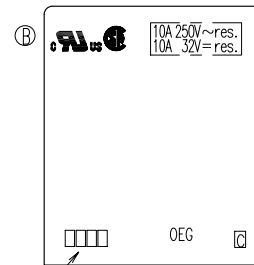
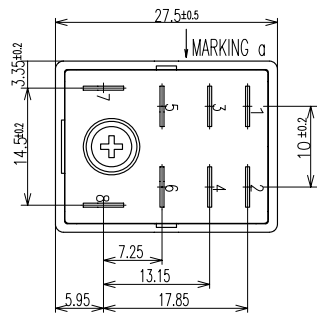
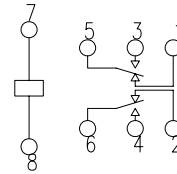

LOT NO. MARKING VIEW

NOTES

LOT NO SYSTEM AS FOLLOWING:

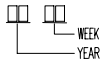

Diagram dimension	Tolerance
max. 1mm	±0.1mm
1 - 3mm	±0.2mm
min. 3mm	±0.3mm

<small>THIS DRAWING IS A CONTROLLED DOCUMENT FOR TYCO ELECTRONICS CORPORATION. IT IS SUBJECT TO CHANGE AND THE CONTROLLING ENGINEERING ORGANIZATION SHOULD BE CONTACTED FOR THE LATEST REVISION.</small>		DWN	H.SASAKI	Tyco Electronics Corporation ShenZhen, China	
DIMENSIONS: mm		CHK	N.FUNAYAMA	NAME	
		APVD	A.NAGAI	PCLH 2P-DC CUSTOMER DRAWING	
TOLERANCES UNLESS OTHERWISE SPECIFIED: 0 PLC ± 1 PLC ± 2 PLC ± 3 PLC ± 4 PLC ±		PRODUCT SPEC	-	SIZE	A3
MATERIAL		APPLICATION SPEC	-	CAGE CODE	00779
FINISH		WEIGHT	-	DRAWING NO	5-1461068-3
		CUSTOMER DRAWING		RESTRICTED TO	
				SCALE	2:1
				SHEET	1 OF 2
				REV	B

THIS DRAWING IS UNPUBLISHED. RELEASED FOR PUBLICATION
 © COPYRIGHT BY TYCO ELECTRONICS CORPORATION. ALL RIGHTS RESERVED.

LOC	DIST	REVISIONS						
		P	LTR	DESCRIPTION	ECN	DATE	DWN	APVD
HB								

TE PART NO.	PACKING SPEC	DESCRIPTION	PART B	PART A	ITEM
6-1461068-5	107-79058	PCLH-205D1S,000	100~110V---	PCLH-205D1S	e
5-1461068-5	107-79058	PCLH-204D1S,000	48V---	PCLH-204D1S	d
7-1440007-1	107-79058	PCLH-203D1S,000	24V---	PCLH-203D1S	c
5-1461068-4	107-79058	PCLH-202D1S,000	12V---	PCLH-202D1S	b
5-1461068-3	107-79058	PCLH-201D1S,000	6V---	PCLH-201D1S	a

(A)

RELAY TYPE

INCOMBUSTIBILITY	TREATMENT	MATERIAL	DESCRIPTION	ITEM
UL94 V-0		PC	CASE	19
		SUS304WPB	SPRING FOR HINGE	18
		PE	INSULATION PLATE	17
		REH-EX	LEAD WIRE	16
UL94 V-0		PBT	MOLD FOR MOVABLE SPRING	15
		AL	REVT	14
		Cu ALLOY	MOVABLE SPRING	13
		Ag ALLOY	MOVABLE CONTACT	12
		Ag ALLOY	STATIONARY CONTACT	11
		Cu ALLOY	COIL,MOVABLE TERMINAL	10
		Cu ALLOY	NO,NC TERMINAL	9
		UP	BASE	8
		STEEL	SCREW	7
		PE	TAPE	6
UL94 HB		NYRON	BOBBIN	5
		UEW	COIL WIRE	4
		STEEL	CORE	3
		STEEL	ARMATURE	2
		STEEL	YOKE	1

THIS DRAWING IS A CONTROLLED DOCUMENT FOR TYCO ELECTRONICS CORPORATION
 IT IS SUBJECT TO CHANGE AND THE CONTROLLING ENGINEERING ORGANIZATION
 SHOULD BE CONTACTED FOR THE LATEST REVISION.

Tyco Electronics Tyco Electronics Corporation
 ShenZhen, China

NAME: PCLH 2P-DC CUSTOMER DRAWING

SIZE: A3 CAGE CODE: 00779 DRAWING NO: 5-1461068-3 RESTRICTED TO

SCALE: 2:1 SHEET 2 OF 2 REV B

CUSTOMER DRAWING

DIMENSIONS: mm	TOLERANCES UNLESS OTHERWISE SPECIFIED:	DWN
	0 PLC ± 1 PLC ± 2 PLC ± 3 PLC ± 4 PLC ±	CHK
MATERIAL	FINISH	APVD
-	-	PRODUCT SPEC
		APPLICATION SPEC
		WEIGHT
		CUSTOMER DRAWING