

# SMT10E Series

12 Vin single output

**NEW Product**



- **10 A Current rating**
- **Input voltage range: 10 Vdc to 14 Vdc**
- **Output voltage range: 0.8 Vdc to 3.63 Vdc**
- **Ultra high efficiency: 94% @ 12 Vin and 3.3 Vout**
- **Extremely low internal power dissipation**
- **Minimal thermal design concerns**
- **Designed in reliability: MTBF of 6,920,000 hours per Telcordia SR-332**
- **Ideal solution where board space is at a premium or tighter card pitch is required**
- **Industry standard surface-mount footprint**
- **Available RoHS compliant**



The SMT10E series are non-isolated dc-dc converters packaged in a surface-mount footprint giving designers a cost effective solution for conversion from a 12 V source. The SMT10E has a wide input range (10 Vdc to 14 Vdc) and offers a wide 0.8 Vdc to 3.63 Vdc output voltage range with a 10 A load, which allows for maximum design flexibility and a pathway for future upgrades. The SMT10E is designed for applications that include distributed power, workstations, optical network and wireless applications. Implemented using state of the art surface-mount technology and automated manufacturing techniques, the SMT10E offers compact size and efficiencies of up to 94%.



*All specifications are typical at nominal input, full load at 25 °C unless otherwise stated*

## SPECIFICATIONS

### OUTPUT SPECIFICATIONS

|                          |  |
|--------------------------|--|
| Voltage adjustability    | 0.8-3.63 Vdc   |
| Setpoint accuracy        | ±0.4% typ.   |
| Line regulation          | ±0.2% typ.   |
| Load regulation          | ±1.0%typ.  |
| Total error band         | ±3.0% typ.   |
| Minimum load             | 0 A  |
| Overshoot/undershoot     | None   |
| Ripple and noise         | 5 Hz to 20 MHz 60 mV pk-pk<br>25 mV rms                  |
| Temperature co-efficient | ±0.01%/°C  |
| Transient response       | 100 mV max. deviation<br>100 µs recovery to within ±1.0% |
| Remote sense             | 10% Vo compensation                                      |

### INPUT SPECIFICATIONS

|                        |  |
|------------------------|--|
| Input voltage range    | 10-14 Vdc                              |
| Input current          | No load (max.) 100 mA                  |
| Input current (max.)   | 3 A max. @ Io max.<br>and Vout = 3.3 V |
| Input reflected ripple | 100 mA rms                             |
| Remote ON/OFF          | (See Note 1)                           |
| Start-up time          | 20 ms                                  |

### EMC CHARACTERISTICS

|                         |                       |
|-------------------------|-----------------------|
| Electrostatic discharge | EN61000-4-2, IEC801-2 |
| Conducted immunity      | EN61000-4-6           |
| Radiated immunity       | EN61000-4-3           |

### GENERAL SPECIFICATIONS

|                         |  |
|-------------------------|--|
| Efficiency              | 94%  |
| Insulation voltage      | Non-isolated   |
| Switching frequency     | Fixed 200 kHz typ.   |
| Approvals and standards | EN60950<br>UL/cUL60950                                       |
| Material flammability   | UL94V-0  |
| Dimensions              | (LxWxH) 33.02 x 13.46 x 8.21 mm<br>1.3 x 0.53 x 0.323 inches |
| Weight                  | 6.3 g (0.22 oz)  |
| Coplanarity             | 100 µm   |
| MTBF                    | Telcordia SR-332 6,920,000 hours                             |

### ENVIRONMENTAL SPECIFICATIONS

|                     |                                |                   |
|---------------------|--------------------------------|-------------------|
| Thermal performance | Operating ambient, temperature | -40 °C to +85 °C  |
| (See Note 2)        | Non-operating                  | -40 °C to +125 °C |

### PROTECTION

|               |                    |
|---------------|--------------------|
| Short-circuit | Continuous         |
| Thermal       | Automatic recovery |

### International Safety Standard Approvals



UL/cUL CAN/CSA-C22.2 No. 60950-1-03/UL 60950-1,  
File No. E174104



TÜV Product Service (EN60950) Certificate No. B03 10 38572 037  
CB Report and Certificate to IEC60950, Certificate No.  
DE3-51686M1

# SMT10E Series

12 Vin single output

DC-DC CONVERTERS | E Class Non-isolated

2

For the most current data and application support visit [www.artesyn.com/powergroup/products.htm](http://www.artesyn.com/powergroup/products.htm)

**NEW Product**

| OUTPUT POWER (MAX.) | INPUT VOLTAGE | OUTPUT VOLTAGE | OUTPUT CURRENT (MIN.) | OUTPUT CURRENT (MAX.) | EFFICIENCY (TYP.) | REGULATION |       | MODEL NUMBER <sup>(3,4)</sup> |
|---------------------|---------------|----------------|-----------------------|-----------------------|-------------------|------------|-------|-------------------------------|
|                     |               |                |                       |                       |                   | LINE       | LOAD  |                               |
| 33 W                | 10-14 Vdc     | 0.8-3.63 Vdc   | 0 A                   | 10 A                  | 94%               | ±0.2%      | ±1.0% | SMT10E-12W3V3J                |

## Part Number System with Options

**SMT10E-12W3V3-TJ**

**Product Family**  
SMT = Surface Mount

**Rated Output Current**  
10 = 10 Amps

**Performance**  
E = Enhanced Performance

**Packaging Options <sup>(3)</sup>**  
No '-T' Suffix = Pb-free RoHS 6/6 compliant parts in trays e.g SMT10E-12W3V3J  
-TJ = Pb-free RoHS 6/6 compliant part in Tape and Reel e.g SMT10E-12W3V3-TJ

**Output Voltage**  
0.8 Vdc to 3.63 Vdc

**Type of Output**  
W = Wide

**Input Voltage**  
12 = 10 Vdc to 14 Vdc

### Output Voltage Adjustment of the SMT10E-12W3V3J Series

The ultra-wide output voltage trim range offers major advantages to users who select the SMT10E-12W3V3J. It is no longer necessary to purchase a variety of modules in order to cover different output voltages. The output voltage can be trimmed in a range of 0.8 Vdc to 3.63 Vdc. When the SMT10E-12W3V3J converter leaves the factory the output has been adjusted to the default voltage of 0.8 V.

## Notes

- 1 The SMT10E features an 'Positive Logic' Remote ON/OFF operation. If not using the Remote ON/OFF pin, leave the pin open (the converter will be on). The Remote ON/OFF pin is referenced to ground.

The following conditions apply for the SMT10E:

| Configuration                            | Converter Operation |
|--|---------------------|
| Remote pin open circuit                  | Unit is ON          |
| Remote pin pulled low [Von/off < 0.8 V]  | Unit is OFF         |
| Remote pin pulled high [Von/off > 1.6 V] | Unit is ON          |

An 'Negative Logic' Remote ON/OFF version is also possible with this converter. To order please place the suffix '-R' at the end of the model number, e.g. SMT10E-12W3V3-RJ.

- 2 Full derating curves available in both the Longform Datasheet and Application Note.
- 3 TSE RoHS 5/6 (non Pb-free) compliant versions may be available on special request, please contact your local sales representative for details.
- 4 NOTICE: Some models do not support all options. Please contact your local Artesyn representative or use the on-line model number search tool at <http://www.artesyn.com/powergroup/products.htm> to find a suitable alternative.

# SMT10E Series

12 Vin single output

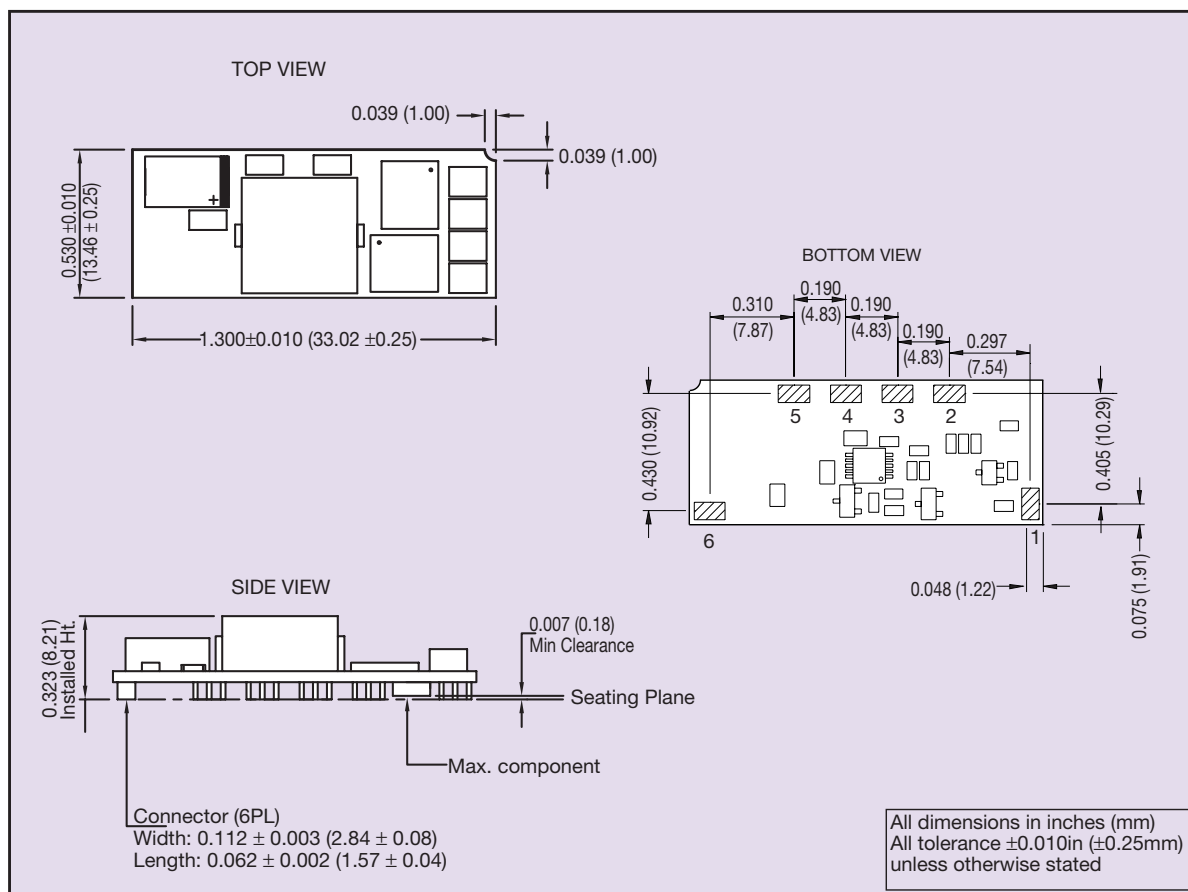

| PIN CONNECTIONS |                 |
|-----------------|-----------------|
| PIN NUMBER      | FUNCTION        |
| 1               | Remote ON/OFF   |
| 2               | Remote Sense +* |
| 3               | Trim*           |
| 4               | +Vout           |
| 5               | Ground          |
| 6               | +Vin            |

\*The sense function and the trim function are customer specified options. Please consult factory for details.

Datasheet © Artesyn Technologies® 2005

The information and specifications contained in this datasheet are believed to be correct at time of publication. However, Artesyn Technologies accepts no responsibility for consequences arising from printing errors or inaccuracies. Specifications are subject to change without notice. No rights under any patent accompany the sale of any such product(s) or information contained herein.

Please consult our website for the following items: ✓ Application Note ✓ Longform Datasheet

[www.artesyn.com](http://www.artesyn.com)