

REV.	ECN NO.	REVISIONS	DRN.	CHK.	APP.	DATE
A		NEW RELEASE	ADM			

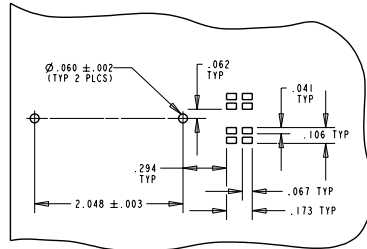

SOLDER PAD/HOLES LAYOUT
SCALE: 2:0

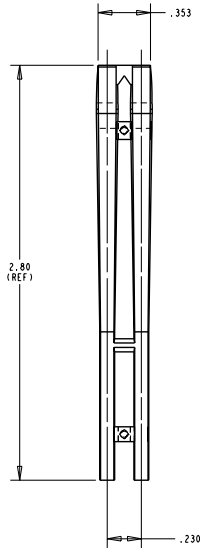
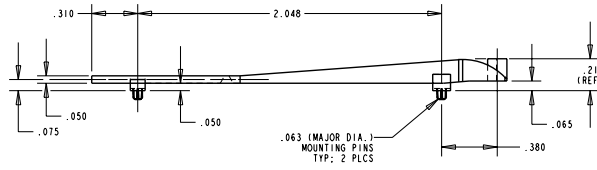
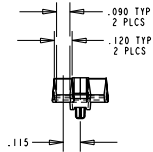
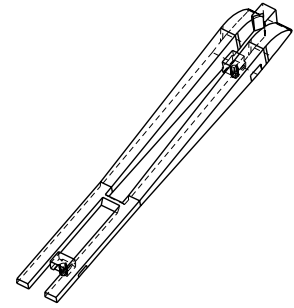

- NOTES: 1
 1. COMPONENT TO BE MOLDED IN A CLEAR TRANSMISSIVE POLYCARBONATE. 1
 2. COMPONENT DESIGNED TO BE PRESSED INTO A P.C. BOARD. 1
 3. LIGHTSOURCE: RED/GREEN SMT BI-COLOR LED (DIALIGHT P/N: 597-7701-5XX). 1
 4. DIALIGHT PART NUMBER: 515-1110.

THIS DRAWING AND THE CONTENTS HEREIN ARE CONFIDENTIAL AND THE SOLE PROPERTY OF DIALIGHT. REPRODUCTION OF THIS DRAWING OR CONSTRUCTION OF ANY PARTS WITHIN THIS DRAWING ARE FORBIDDEN WITHOUT THE WRITTEN CONSENT OF DIALIGHT.	
SCALE: 2:0	DRAWING NUMBER
ALL DIM'S IN: INCHES	C-16808
TOLERANCES: UNLESS OTHERWISE SPECIFIED	REV
FRACTIONS: 1/16	A
DECIMALS: 1.3XX: ±.02	TITLE
DECIMALS: 1.3XXX: ±.015	2 ELEMENT LIGHTPIPE
DECIMALS: 1.3XXXX: ±.005	MATERIAL
ANGLES: 30°	
FINISH:	Dialight
FSCM 83330	1501 ROUTE 34 SOUTH FARMINGDALE, NJ 07727
SHEET	OF FAMILY TABLES: