

RECOMMENDED DIMENSIONS
FOR PC-BOARD PAD

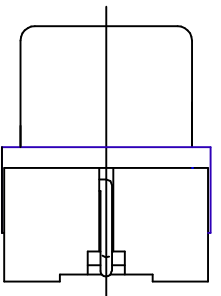

REV.	DESCRIPTION/ECO NO.	DATE
A	RELEASED	5/13/02
B	CHANGE BASE DESIGN	6/7/02
	DIMENSION CHANGES	6/26/02

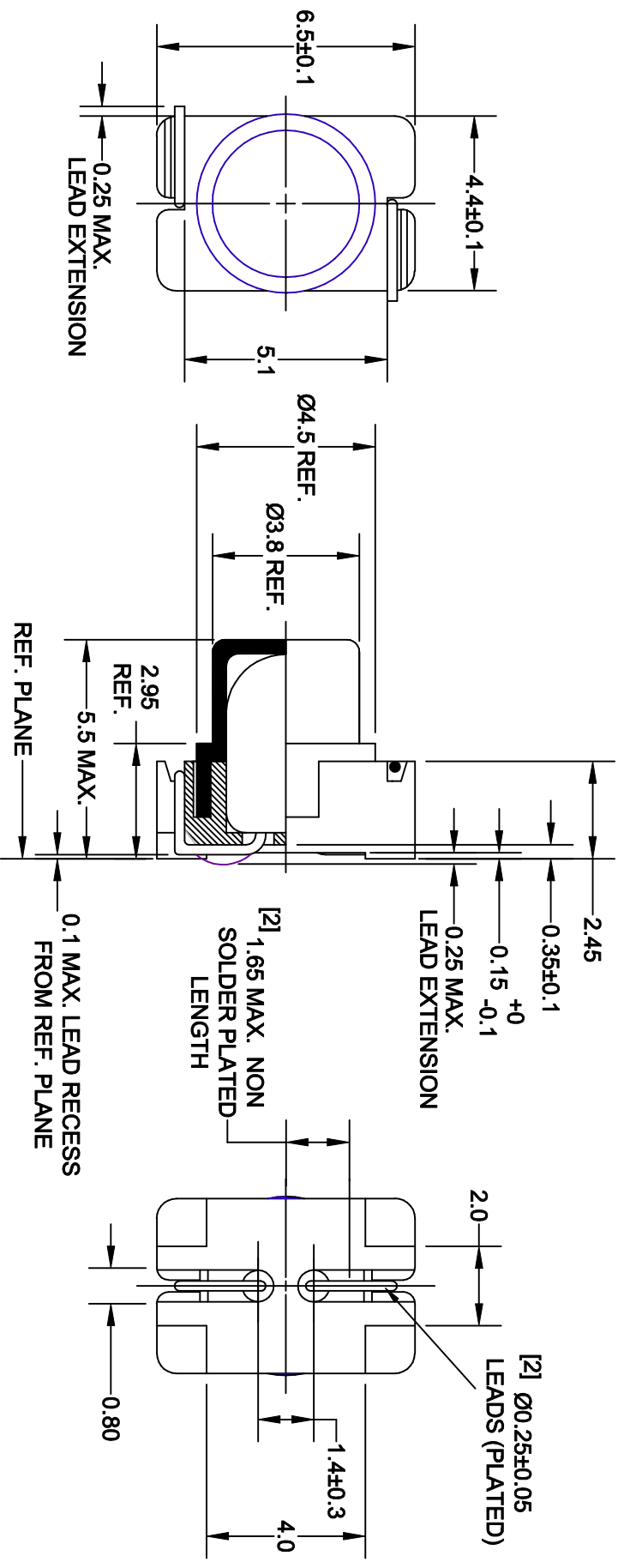

LAMP NUMBER: 7152				
VOLTS RATED	AMPS ± 10%	*MSCP ± 25%	*LUMENS ± 25%	AVERAGE LIFE HRS. ± 25%
5.0	.115	.150	1.89	20,000**
*LAMP RATING ONLY WITHOUT BASE AND FILTER				
FILTER NUMBER: 39-26-3A		AVERAGE FILAMENT TYPE		
COLOR REF.: YELLOW		C-2R		

**DERIVED FROM ACCELERATED TESTING

JKL PART NUMBER: CSD4-7152/39-26-3A

<p>METRIC THIRD ANGLE PROJECTION</p>		<p>DIMENSIONS ARE IN MILLIMETERS TOLERANCE UNLESS OTHERWISE SPECIFIED 1 PL +/- 0.2 2 PL +/- 0.20 ANGLE +/- 0</p>		<p>JKL COMPONENTS CORPORATION</p>	
<p>DRAWN BY L. WENGSTROM</p>	<p>APPR'D BY J.K.</p>	<p>DATE 6/26/02</p>	<p>SIZE A</p>	<p>FIG. NO. 55335</p>	<p>DRAWING NO. CSD4-7152/39-26-3A</p>
<p>- CAD DRAWING - MANUAL REVISIONS NOT PERMITTED</p>			<p>SCALE NONE</p>	<p>RELEASED DATE 5/13/02</p>	<p>REVISION DATE 6/26/02</p>
<p>JKL T-1 SURFACE MOUNT LAMP WITH BASE AND FILTER (LOW PROFILE)</p>				<p>SHEET 1 OF 1</p>	<p>REV. B</p>