

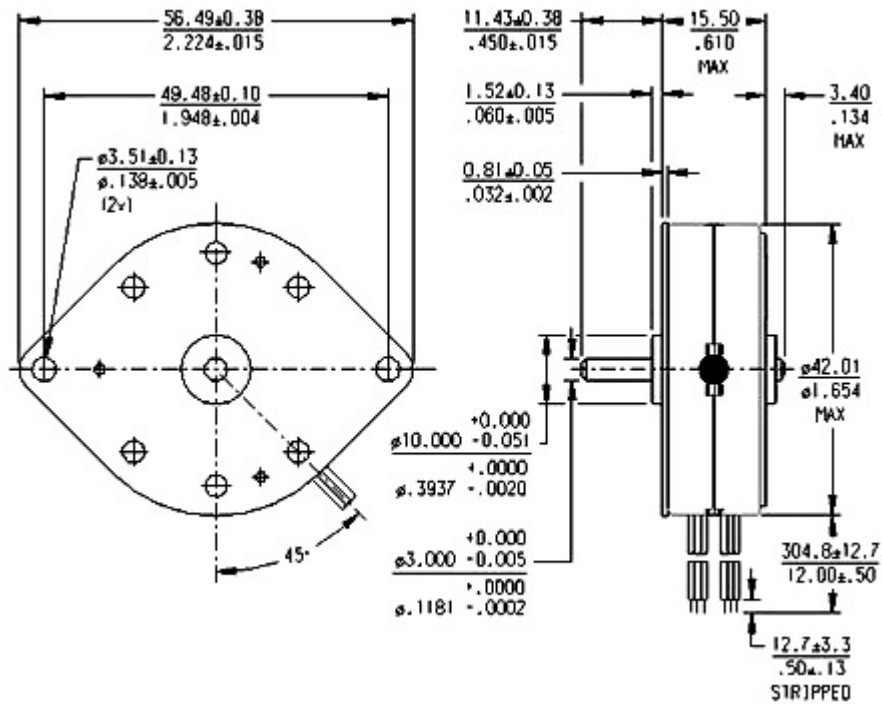

42M100B2U



Full View



Unipolar and Bipolar Wiring Schematic

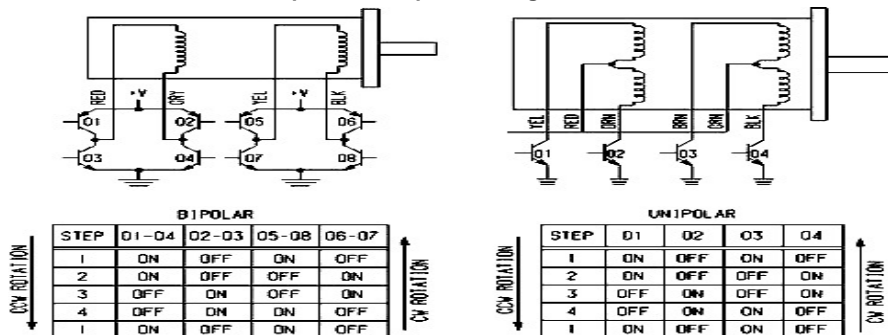

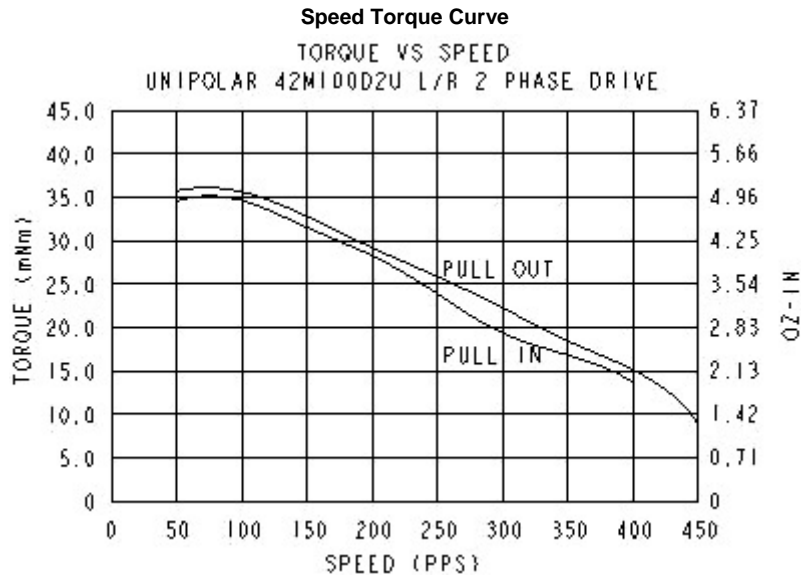

PartNumber	42M100B2U
DC Operating Voltage	12
Res Per Winding (Ohms)	75
Ind per Winding mH	36.7
Holding Torque mN*m/oz-in	49.4/7.0
Rotor Moment of Inertia (g*m ²)	9.5E-4
Detent Torque mN*m/oz-in	11.3/1.60
Step Angle	3.6°
Step Angle Tolerance	±0.4
Steps per Rev	100
Max Operating Temp	100°C
Ambient Temp Range Operating	-20°C to 70°C
Ambient Temp Range Storage	-40°C to 85°C
Bearing Type	Sintered Bronze sleeve
Insulation Res at 500Vdc	100 megohms
Dielectric Withstanding Voltage	650 ± 50 VRMS 60 Hz for 1 to 2 seconds
Weight g/oz	88 g/3.1 oz
Lead Wires	28 AWG, UL Style 3265

*Measured with 2 phases energized

USA, Canada, or Mexico:

If you have any questions, contact us at:

Phone: 1-540-633-3400

Fax: 1-540-639-4162

Email: DMAC@danahermotion.com

Literature: litrequest@danahermotion.com

Or Write:

Danaher Motion
203A West Rock Road
Radford, VA 24141 USA

*Trademark of Danaher Motion. DANAHER MOTION is registered in the U.S Patent and Trademark Office and in other countries. Printed in the U.S.A. The specification in this publication are believed to be accurate and reliable. However, it is the responsibility of the product user to determine the suitability of Thomson products for a specific application. While defective products will be replaced without charge if promptly returned, no liability is assumed beyond such replacement.

