

ASSEMBLY - VIEW FROM FRONT

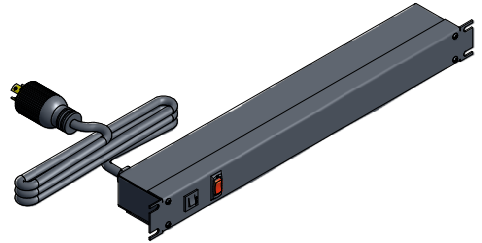

ISOMETRIC VIEW

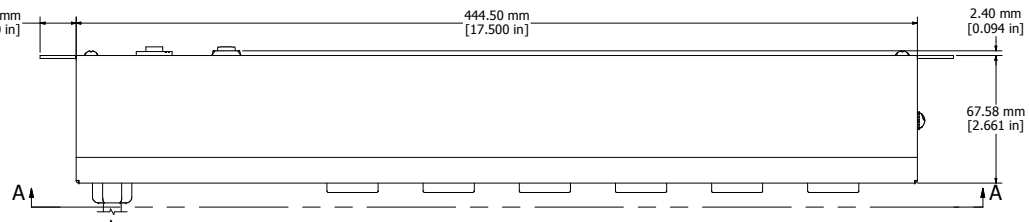

ASSEMBLY - VIEW FROM BOTTOM

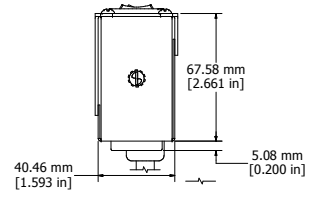

ASSEMBLY - VIEW FROM SIDE

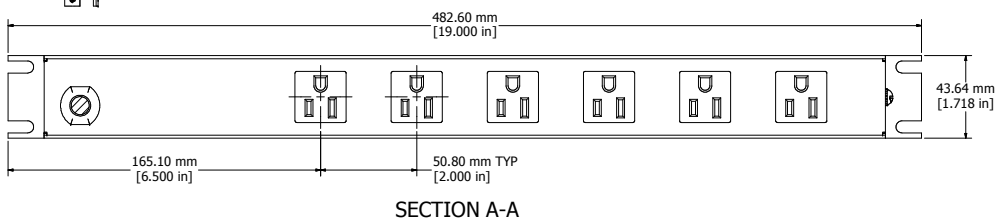

SECTION A-A

|   |                            |
|---|----------------------------|
| <b>1583H6C1BKRA</b>   |                            |
| Finish - Front - Black Painted Steel  | Back - Black Painted Steel |
| Rated - 125 VAC, 60 Hz, 15 Amps   |                            |
| Approvals - CSA Certified Standards C22.2 (No. 21-95, 42-99)<br>- UL Recognized Standard UL1363 |                            |
| Cord Length   |                            |
| 1583H6C1BKRA - 6' Foot Twist Power Cord (NEMA L5-15P)   |                            |
| 1583H6D1BKRA - 15' Foot Twist Power Cord (NEMA L5-15P)  |                            |

